



DEVELOPMENT REVIEW COMMITTEE (DRC) COMMENT REPORT

MEETING DATE: January 8, 2019

APPLICANT: Riverside Park, LLC.

PROJECT NAME: Riverside Park Townhouses

CASE NUMBER: R19003

REQUEST: Site Plan Level II Review: 56 Townhouse Units

LOCATION: 1901 SW 5th Place

ZONING: Residential Multifamily Low Rise/Medium
Density (RM-15)

LAND USE: Medium Density Residential

CASE PLANNER: Randall Robinson



Case Number: R19003

CASE COMMENTS:

- 1) Provide the FBC Building Type designation on the plans.
- 2) Indicate Code compliant detailed rated unit separations including attic space.

GENERAL COMMENTS

The following comments are for informational purposes.

Please consider the following prior to submittal for Final DRC:

1. The Florida Building Code shall apply to the construction, alteration, movement, enlargement, replacement, repair, equipment, use and occupancy, location, maintenance, removal and demolition of every building or structure or any appurtenances connected or attached to such buildings or structures.
2. All projects must consider safeguards during the construction process. Florida Building Code Chapter 33 delineates various safeguards that may apply during the construction phase. All structures associated with the protection of pedestrians will require a separate permit. A licensed professional must sign and seal the plans and specifications.
3. The City of Fort Lauderdale is a participating municipality in the National Flood Insurance Program (NFIP). The requirements specific to the City of Fort Lauderdale can be found in

Chapter 14 - FLOODPLAIN MANAGEMENT of the Code of Ordinances and accessed at;

a. https://www.municode.com/library/fl/fort_lauderdale/codes/code_of_ordinances?nodeId=COOR_CH14FLMA

Please consider the following prior to submittal for Building Permit:

1. On January 1st, 2018 the 6th Edition of the Florida Building Code was adopted. All work described in Section 101.2, of the Broward County Administrative portion of the Florida Building Code, will govern the administration and enforcement of the proposed work. Each building and or structure will require a separate permit. The following websites will assist in the design considerations:
 - a. <http://www.fortlauderdale.gov/departments/sustainable-development/building-services>
 - b. https://floridabuilding.org/bc/bc_default.aspx
 - c. <http://www.broward.org/codeappeals/pages/default.aspx>

General Guidelines Checklist is available upon request.



Case Number: R19003

RIGHT-OF-WAY / EASEMENT DEDICATION(S) REQUIRED PER ULDR SECTION 47-25.2.M.5:

- a. Provide 15' and 25.25' permanent Right-of-Way Easement along east side of SW 20th Avenue, to complete half of 60' Right-of-Way section consistent with SW 20th Ave section on this area ; show / label delineation in the plans.
- b. Provide 5' (min.) permanent Right-of-Way Easement along north side of SW 5th Place, to complete half of 50' Right-of-Way section per ULDR Section 47-24.5.D.1; show / label delineation in the plans.
- c. Provide 10' x 15' (min.) permanent Utility Easement for any 4 Inch or larger water meter and/or the first private sanitary sewer manhole located within the proposed development (for City Maintenance access); show / label delineation in the plans as appropriate.

CASE COMMENTS:

Prior to final DRC sign-off, please provide updated plans and written response to the following review comments:

1. Meet the City's Adequacy requirements to services provided to the public (fire service, water, wastewater, stormwater, transportation, etc.), per ULDR Section 47-25.2 of the City's Code of Ordinances. Assess potential demands and impacts on City services and prepare a design for each that utilizes existing water, wastewater, stormwater, and transportation infrastructure to adequately serve this project. If the adequate infrastructure is not available, prepare a design that extends/expands the connection to the nearest City system to adequately serve this development.
 - a. Prepare service demand calculations for water & wastewater services and obtain a letter of service availability from the City's Public Works – Engineering Department. Submit water and wastewater capacity availability request form and documents/ plans at <https://www.fortlauderdale.gov/departments/sustainable-development/urban-design-and-planning/development-applications-boards-and-committees/development-review-committee-service-dema>
2. On survey, provide spot elevations on site, at property corners, along property lines (50' min. interval), existing roadway crowns and pavement edges adjacent to property as appropriate. Elevations shall be referenced to the North American Vertical Datum of 1988 (NAVD 88). Sufficient information must be provided on survey in order to staff to determine proposed development improvements are being coordinated with adjacent right of way and properties. Ensure survey depicts all information requested above as well as any information beyond limits of property that maybe required for coordination between existing and proposed improvements adjacent to the site.
3. Depict NVAL line on development plans and ensure proposed access openings are coordinated.
4. Provide disposition of existing utilities on-site and within the adjacent right of way that maybe impacted by the proposed development. Label information on plans (i.e. utility to remain/ be relocated/ removed). Provide correspondence from utility owner (as applicable) and depict any additional requirements they may have on plan (i.e. easements). Utilities include but are not limited to above and underground water, sewer, drainage, electrical, communications, light/power poles, down guys, fire hydrants, manholes, etc. Especially the existing power poles/ lines along the east boundary of the property.
5. Proposed private structures and infrastructure shall not be constructed within existing or proposed right of way/ dedications/ easements.



6. Submit a formal Site Plan that features all critical dimensions for the proposed development, such as building setbacks, parking lot access, driveway widths, sidewalk dimensions, and typical roadway travel lane (including any on-street parallel parking) widths for SW 20th Ave and SW 5th Place.
7. Provide and label typical roadway cross-sections for the proposed development side of for SW 20th Ave and SW 5th Place: at driveway access points, at on-street parallel parking lanes, and at landscape swale areas (i.e. between travel lane and sidewalk) as appropriate.
8. Discuss whether connection between sidewalk adjacent to development and proposed on-street parking should be provided.
9. Depict/ label existing/ proposed stop sign/ bar on right of way adjacent to the site and on driveway connections to right of way as applicable.
10. More prominently show on all plan sheets and typical roadway sections the existing Right-of-Way boundaries adjacent to the proposed development along SW 20th Ave and SW 5th Place; also show proposed Right-of-Way, Right-of-Way Easement, Sidewalk Easement, and utility easement boundaries as applicable for this project. Existing and proposed Right-of-Way and/or Easement boundaries must be clearly depicted on site plan, proposed development plans (especially civil) and sections/ elevations.
11. Discuss dumpster enclosure/ trash pick-up access requirements with case planner and waste management. Clearly depict trash enclosure on site plan. Show truck turning movements in and out the proposed dumpster enclosure/ building as applicable. Per ULDR Section 47-19.4.D.6, all dumpster enclosures and adjacent service access drive shall be placed on poured concrete, solid or perforated interlocking concrete block paving (ICB), or any existing hardened paving system.
12. Driveway tie-in on SW 5th Place and SW 20th Ave shall be per the City's Driveway Plan Detail Sheets (Right-of-Way), available online at <http://www.fortlauderdale.gov/home/showdocument?id=1524> via the City's website.
13. Conceptual Water and Sewer Plan:
 - a. 10'x15' utility easement around water meter vault shall be entirely on-site (not within right of way easement) and on the same direction as vault.
 - b. Proposed sanitary sewer manhole #9 servicing development shall be installed within property (not right of way easement) and provide a 10'x15' utility easement.
 - c. Existing water main along SW 20th Ave is a 6-inch CIP water main (not 8-inch). Revise plans accordingly.
 - d. Additional comments/ requirements maybe forthcoming from Public Works water and wastewater service availability review.
14. Any road cuts for utilities or curb cuts within City Right-of-Way shall be restored to full lane width for 50' minimum length (by contractor), per City Code of Ordinances Section 25-108; show and label in plans as appropriate.
15. Conceptual Paving, Grading and Drainage plan and sections:
 - a. Sufficient existing and proposed grades and information shall be provided to demonstrate how stormwater runoff will remain onsite and how the proposed project improvements (i.e. on-street parking, sidewalks, etc.) will not adversely impact the adjacent Right-of-Way, properties and waterways. Drainage mitigation shall be required for any impacts within the adjacent City Right-of-Way such as increased runoff or reduction of existing storage/treatment due to proposed improvements, in accordance with the City of Fort Lauderdale Comprehensive Plan (Ordinance C-15-08), Objective 4.1 under Infrastructure



Elements. Applicant shall be responsible for maintenance located within City Right-of-Way during a 1-year warranty period, until accepted by the City's Public Works Department.

- b. Provide typical section along south and west boundary of the property to demonstrate how stormwater runoff will remain onsite and drainage design intent for the proposed right of way improvements (i.e. on-street parking, driveways, sidewalks, etc.)
 - c. Provide additional information regarding the proposed swale along SW 20th Ave and why a railing is proposed adjacent to the sidewalk. A min. 8 inch swale is required along SW 20th Ave and SW 5th Place per City standards.
 - d. Provide additional grades on right of way (i.e. sidewalk, driveway connections to SW 20th Ave and SW 5th place) to ensure coordination with existing grades and on-site retention. Inlets S-3, S-4 and S-17 appear to be too high.
 - e. Is perimeter wall going to be a retaining wall? Depict differential on elevation between proposed site and existing adjacent site on sections as the adjacent site appears to be 1.5 to 2 foot lower than proposed on-site grades. Additional existing grade information is required along the east, west and south boundaries of the property to ensure proper coordination/transition. Also how is the wall coordinated with existing power poles along eastern boundary of property?
 - f. Clarify if the intent is to have the sidewalk at the same elevation as the road, otherwise revise sections accordingly.
 - g. Ensure flow arrows are depicted on correct direction.
16. Discuss how surface runoff from the proposed development (between building and Right-of-Way boundaries) will be mitigated such that it won't be conveyed into the adjacent existing public storm drain infrastructure or waterways, and whether additional infrastructure will be required within City Right-of-Way. Show location of building roof drains, and their proposed connection(s) to the on-site drainage system.
17. Depict proposed building doors and provide sufficient grades/details on conceptual paving, grading and drainage plans to verify ADA accessibility design for the site, especially ground floor access to the new building, as well as crossing proposed driveways and connecting to existing sidewalks (at intersections and with adjacent property) as appropriate; coordinate proposed site grading and 1st Level Finished Floor Elevations to meet ADA accessibility requirements.
18. Contact the Floodplain Manager, Richard Benton at 954-828-6133 or rbenton@fortlauderdale.gov regarding proposed Finished Floor elevation and fill requirements per City's Code of Ordinances Chapter 14 – Floodplain Management, including Ordinance C-14-26. Especially where proposed elevations appear to be over 2' higher than existing ground. Provide correspondence and depict information on plans accordingly.
19. Provide storm runoff calculations, signed and sealed by a Florida registered professional engineer, which demonstrate how minimum criteria regarding adjacent street crown, water quality and finished floor elevations are met, as well as how the 25-year, 3-day storm event is maintained on site with zero discharge to Right-of-Way and adjacent properties. Please also comply with the City of Fort Lauderdale Comprehensive Plan (Ordinance C-08-18), Objective 4.1 under Infrastructure Elements, and be advised that effective 7/1/2017, all projects must comply with the Broward County 'Future Conditions Average Wet Season Groundwater Level' map.

Drainage mitigation is required for any impacts within adjacent City of Fort Lauderdale Right-of-Way, such as increased runoff, additional impervious areas, and reduction of existing storage or treatment (i.e. swale areas). Engineer of Record (EOR) shall evaluate the adjacent City roadway system capacity and demonstrate that the proposed improvements will not negatively impact the City's existing drainage system, and provide recommendations in compliance with the City's Comprehensive Plan (i.e. meets or exceeds the 10-year/1-day storm event drainage criteria).



20. Show and label all existing and proposed utilities (utility type, material and size) on civil and landscaping plans for potential conflict. A min. 5 feet and 10 feet horizontal clearance horizontal separation is required between city utilities infrastructure and proposed small and large trees, respectively (including proposed water and sewer services to the development). Any new trees (located within or adjacent to City Right-of-Way) should be placed with sufficient horizontal and vertical distances (per City, County, and State guidelines) to / from City's public infrastructure, including stormwater assets, to allow for continued Public Works maintenance without obstruction. If this cannot be accommodated due to field conditions, then the developer shall relocate the existing City's public infrastructure to resolve the conflict(s) and to comply with City's, County's & State's engineering standards/permits/policies. Demonstrate on plans separation is provided and include a note regarding horizontal clearance requirement on the landscape plans. Also, proposed trees shall be installed a min. 4 feet behind proposed curbs when adjacent to travel lanes and a min. 6 feet away from adjacent travel lanes when no curb is present.

21. Evaluate the possibility of utilizing a sustainable stormwater approach with the possibility of low impact (cisterns, pervious pavers, bioswales, raingardens, etc.) uses for landscaping along the streetscape.

22. Within adjacent City Right-of-Way, staging/storage will not be allowed, construction fence shall not encroach within intersection corner sight triangles, construction fence gates shall not swing into the public Right-of-Way, and any Jib Crane radius shall not extend beyond private property boundaries. Any City Right-of-Way closure over 72 hours requires a Revocable License Agreement, processed by Property Right-Of-Way Committee (DRC) and approved by the City's Commission, prior to Right-of-Way permit issuance by the Department of Sustainable Development for Maintenance of Traffic.

Prior to submitting Administrative Review (i.e. DRC Level I) application to request Revocable License Agreement, please contact Dennis Girisgen at 954-828-5123 or dgrisgen@fortlauderdale.gov to discuss proposed scope of closure within City Right-of-Way.

23. Discuss if pedestrian lighting is proposed; if not, discuss the possibility of the addition of pedestrian lighting along City Right-of-Way, which requires perpetual maintenance by the Applicant via a Maintenance Agreement executed with the City. Please contact the Case Planner for details to match the area.

24. Provide Maintenance Agreement Area Exhibit, which provides a visual representation of the area within the adjacent public Right-of-Way (adjacent to the proposed development) to be maintained in perpetuity by the developer. Label whether the adjacent Right-of-Way is FDOT, BCHCED, or City jurisdiction, as well as label all proposed improvements, including asphalt and other specialty paving, concrete and other specialty sidewalk, landscaping, irrigation, lighting, etc. that will be maintained by the Applicant throughout the life of the improvements. Perpetual maintenance of newly constructed exfiltration trenches, inlets, etc. within adjacent City Right-of-Way will typically revert back to the City, upon successful inspection/acceptance by Public Works after 1-year warranty period. Ensure you also depict the portion of the site adjacent to SW 5th Place and include the driveway connections as part of the special improvements.

25. For Engineering General Advisory DRC Information, please visit our website at <https://www.fortlauderdale.gov/home/showdocument?id=30249>

26. Additional comments may be forthcoming at the DRC meeting and once additional/ revised information is provided on plans.



Case Number: R19003

CASE COMMENTS:

Please provide a response to the following:

1. The City has adopted Florida Friendly Landscaping requirements into our ULDR Section 47-21. This includes limited sod areas, native plant requirements, hydro-zone planting requirements, street tree requirements, irrigation limitations, etc. Please see Muni-Code for updated ordinance https://www.municode.com/library/fl/fort_lauderdale/codes/unified_land_development_code?nodeId=UNLADERE_CH47UNLADERE_ARTIIIDERE_S47-21LATRPRRE
2. Provide street trees in the right of way swale area, as per ULDR 47-21.13.B.16. Street trees are to be a minimum of 12 feet tall and provided at a ratio of one street tree per forty feet of street frontage or greater fraction thereof not subtracting ingress and egress dimensions. When overhead utilities exist, required street trees may be small trees provided at a minimum of a ratio of one street tree per twenty feet frontage or greater fraction thereof not subtracting ingress and egress dimensions.
 - a. Relocation of existing site trees may be used toward the fulfillment of the street requirement and show a positive example to the neighboring community.
3. A minimum separation of 6 feet is required between the tree trunk and travel lane when curb and gutter DO NOT exist, and a minimum separation of 4 feet is required between the tree trunk and travel lane when curb and gutter DO exist. Illustrate this clearance.
 - a. Please provide a wider landscape area for trees adjacent to the travel lanes.
4. Illustrate and label the horizontal clearance from tree trunk to edge of paved travel lane on the landscape plan. Landscaping must provide a minimum horizontal clearance of 5 feet for small trees and palms, and a minimum of 10 feet for large trees and palms from underground utilities. Provide a cross section detail to illustrate this clearance.
5. Illustrate the location of overhead utilities and follow FPL Right Tree Right Place guidelines for tree selection and placement.
 - a. Please consider placing overhead power lines underground.
6. Utilities and site amenities such as walkways, flagpoles, transformers, fire hydrants, sewer and water supply lines, trash enclosures, and similar items located on the site shall not be placed adjacent to, in, or under required tree planting areas, as per ULDR Section 47-21.12. Confirm with civil, site and life safety plans that utilities and site amenities are not causing conflicts with proposed landscaping. Where conflicts exist, shift the utility and/or site amenities.
7. Shade trees must be located a minimum of fifteen feet away from structures.
8. Small trees and palms must be located a minimum of seven and one-half feet away from structures. Palms may be planted closer to each other to form clusters.



9. Many of the locations proposed for the new Silver Buttonwood trees are in shady areas.
 - a. Please propose trees that will be sustainable for the conditions at this site.
10. Please propose additional trees and palms around the perimeter adjacent to the neighboring properties, this is to provide a heavier landscape buffer between the structures and adjoining sites.
11. Retention area south end of site;
 - a. Please consider the high sides of the retention area for relocation of existing site trees and palms.
 - b. Please increase the number of Cypress trees in the low part of the retention area to fill in more of the open space.
 - c. Please consider the placement of the trees in both areas to be in hammock form.
12. Fences facing the street that are required to be setback a minimum of 3 feet from the property line and must be planted with continuous hedges, shrubs and groundcover in that area between property line and fence. These plantings shall be planted between the street and the property line as per ULDR 47-19.5C.
 - a. Hedges and shrubs may be 2 feet tall planted 2 feet apart.
 - b. Groundcover may be 6 inches tall planted 6 inches apart.
 - c. Please specifically note and illustrate this on plans.
13. The use of structural soil is required in paved sites to provide adequate soil volumes for tree roots under pavements, as per ULDR Section 47-21.13. CU Structural soil details and specifications can be obtained at <http://www.hort.cornell.edu/uhi/outreach/index.htm#soil> This is to be provided at a minimum of 8' radii of tree trunks, and is to be consistently illustrated and noted on landscape, site and civil plans.

The structural soil drain is required when percolation rates are less than 4" vertical clearance per hour. Provide documentation of report used to prove this calculation. The drain and connections are to be illustrated on civil plans.

 - a. Demonstrate hashing on landscape, site and civil plans as to the extent of use of the CU Structural Soil.
14. Provide tree protection barricade detail for existing trees on site to remain, as per ULDR 47-21.15. This barricade must be installed prior to the beginning of proposed work, and a landscape job-check inspection may be scheduled.
15. For specimen trees, provide ISA Certified Arborist report for specimen trees, as per ULDR 47-21.15. This report is to be on ISA Certified Arborist business letterhead with contact information and ISA Certification number clearly stated. This report would include tree survey with numbered trees, a corresponding table which includes tree number, botanical name and common name, trunk diameter at breast height, clear trunk for palms, condition percentage, etc.; and a written



assessment of existing tree characteristics. This information is required to calculate equivalent value mitigation.

- a. Tree Disposition sheet indicates Arborist report for trees, please provide updated Arborist report and condition ratings for existing trees and palms.
 - b. Tree list starts at tree number 203, please provide tree disposition list information as to trees and palms numbered 1-202
16. Effort shall be made to design around existing, large, desirable trees. If, as determined by the department, there are large desirable existing tree(s) and the proposed placement of the site plan elements will not save such tree(s) and sufficient root system to support the tree(s), and such tree(s) are capable of being protected by a reasonable modification of said plan, then a tree removal permit may be denied by the department.
- a. Please reconsider the proposed site development for redesign to save large, desirable trees in their locations.
17. There is existing trees and palms shown to remain in place on plan, yet they are adjacent to proposed structures and paved areas. These trees and palms would sustain a large impact to their canopy and root systems.
- a. Please demonstrate what the impact to these trees and palms would be.
 - b. Please demonstrate how the paving and construction will take place without causing a tree abuse situation.
 - c. Please reconsider the proposed site development for redesign to save large, desirable trees in their locations.
18. Relocated trees will be moved by the applicant following the ANSI A 300 standards and guaranteed by the permit holder for one year for trees of less than six inches in caliper and for two years for trees greater than six inches in caliper, as per ULDR 47-21.15.
- a. There are many trees and palms that could be saved and utilized within this site by relocation. Please have the ISA Arborist evaluate trees and palms and prescribe requirements for their relocation.
 - b. Permit is not required for preparation of trees for relocation.
19. Please correct site Landscape calculations that they corresponded with Site Data calculations.
- a. Vehicle Use Area
 - b. Net Lot Area
 - c. Ect.
20. Lighting fixtures with an overall height of more than ten (10) feet shall be located a minimum of fifteen (15) feet away from shade trees - as per ULDR Section 47-21.12. Confirm with civil, and life safety plans that utilities and site amenities are not causing conflicts with proposed landscaping. Where conflicts exist, shift the utility and/or site amenities.
21. Additional comments may be forth coming after further reviews.



GENERAL COMMENTS

The following comments are for informational purposes.
Please consider the following prior to submittal for Building Permit:

1. A separate sub-permit application for Tree Removal & Relocation, General Landscaping and GLandscape (right of way Landscape/Engineering) for site is required at time of master permit submittal.
2. Provide separate Plumbing sub permit application for irrigation. Irrigation plans are required at time of Building permit submittal. Plans are to be in compliance with ULDR 47-21.6.A.11 and 47-21.10.



Case Number: R19003

CASE COMMENTS:

Please provide a response to the following:

1. All doors should be impact, metal, or solid core. Secondary locks should be provided along with an 180 degree view finder on solid doors.
2. Consider pre-wiring residential units for alarm systems
3. If there is a pool area, it should incorporate safety features to prevent unsupervised children from accessing the pool.

Noted: Gated entry and call box

GENERAL COMMENTS

The following comments are for informational purposes.

Please consider the following prior to submittal for Final DRC:

- 1.

Please consider the following prior to submittal for Building Permit:

- 1.



Case Number: R19003

CASE COMMENTS:

The City owns and maintains stormwater infrastructure adjacent to the proposed development as shown with green line work or street swales in the map provided at the end of this report. The following comments pertain to possible impacts of the proposed development and/or construction activities to the existing condition of the City's stormwater assets. The applicant shall provide an itemized response letter addressing the following comments:

Prior to Final DRC Sign Off, the applicant shall respond to the following comments:

1. Please email CRBARRETT@FORTLAUDERDALE.GOV to obtain copies of the City utility maps as applicable to the project location and show existing City utilities and easements (water, sewer, forcemain, and stormwater utilities) in proposed engineering plans (utility demolition, stormwater pollution prevention plan (SWPPP), and civil plans).
2. Please note that private stormwater infrastructure (drainage pipes, wells, or basins,) or Permanent Structures (fences, walls, etc.) are not permitted in City Right of Way (ROW) or City drainage easements. Please remove any proposed stormwater systems, or permanent structures that are not in compliance with this requirement or provide appropriate documentation of City Rights-of-Way or easement vacated to allow the construction of private underground utilities.
3. The edge of any City's existing stormwater assets (pipes, exfiltration trenches, structures, or other) shall be at 5' minimum (7' preferred) horizontal clearance from any proposed tree's root system and with appropriate root barriers per City's landscaping regulations.
4. If the proposed development falls within the following neighborhoods (Victoria Park, Edgewood, Progresso, RiverOaks, Durrs and Dorsey, or South East Isles), a set of plans shall be provided to the Public Works Engineering group for review of the proposed R/W improvements and conflicts with the stormwater neighborhood master plans currently in final design phase.
5. Proposed C&G or other surface features in City ROW handling stormwater runoff & connecting to adjacent City's Drainage surface assets (such as other curbs, swales, etc.) shall be shown with sufficient grade elevations and transitions details on civil plans to demonstrate that the proposed roadway improvements are not creating drainage puddles in City's roadways.

Prior to Issuance of Building Permit, the applicant shall address the following comments:

1. Please provide (or revise if already submitted) an erosion, sedimentation, and stormwater pollution prevention plan (**SWPPP**) showing the adjacent City's existing stormwater system as shown in the survey and to the limits shown with green line work in the storm map provided at the end of this report. A copy of the approved SWPP shall be at the construction site from the date of demolition initiation to the date of final construction activities.

Add the following notes to the **SWPPP** (CCTV Notes, Pollution Prevention Notes, and Dewatering Notes):

Closed Circuit TV inspection (CCTV) Notes (Applicable if dewatering to City stormwater assets)

- a) Contractor shall provide CCTV videotapes to City STW OPS of the existing stormwater system to the limits shown with green line work in the storm map provided at the end of this report in order to document the PRE and POST construction conditions of the City's storm system.
- b) Contractor shall provide the PRE construction CCTV to City STW OPS when applying for a demolition permit at the City's building department.
 - I. If debris is found in the City's stormwater system prior to demolition or construction, the applicant, contractor, developer or designer (as applicable) shall inform the City's stormwater operations department for proper removal.



- c) Contractor shall provide the POST construction videotape to City STW OPS when requesting the Certificate of Occupancy (CO) to verify that the City's stormwater systems have not been negatively impacted by the demolition and construction activities.
 - I. If debris is found in the City's storm systems as a result of demolition or construction activities, it will be the responsibility of the contractor to vacuum clean the City's stormwater system (or make repairs as requested by City's stormwater operations group) prior to issuance of final CO.
 - II. If surface water runoff or debris from demolition or construction activities is found to have negatively impacted the condition of the City's stormwater assets, it will be the responsibility of the applicant (contractor, developer, and owner) to rectify the infraction(s) as requested by City.

Pollution Prevention Notes (Applicable to most site developments)

- a) Contractor shall adhere to of the National Pollution Discharge Elimination System (NPDES) requirements. The contractor shall institute Best Management Practices (BMPs) to ensure compliance with the NPDES program and to minimize the impact to public stormwater facilities. A Notice of Intent (NOI) shall be filed prior to start construction activities.
- b) Prior to demolition activities, contractor shall install pollution prevention control devices (i.e., silt barriers, sediment basins, turbidity barriers around stormwater outfalls on the waterside of lakes, ponds, canals, or waterways, silt screens, etc. according to the approved SWPPP and as recommended by the Florida Department of Environmental Protection (DEP) latest guidelines and permitting requirements.
- c) Prior to demolition activities, a silt fence in accordance with the approved SWPPP details and latest DEP standards shall be erected around the site property lines. All public inlets surrounding the site shall be protected by the installation of filter fabric into the frame and grate or other approved BMPs to protect against storm runoff.
- d) Pollution control installations, as approved and shown in the SWPPP, shall be maintained throughout demolition and construction periods until the project has been completed and approved by City engineering inspector or project engineer.
- e) Contractor shall inspect the pollution control devices daily for signs of malfunction, failure, or needed repairs, and shall make remedial actions immediately upon discovery.
- f) Existing stormwater inlets, catch basins, or manholes, onsite and offsite, shall be protected from sediment storm runoff from the proposed demolitions and construction activities.
- g) Contractor shall immediately remove all mud, dirt, or other materials tracked or spilled onto existing roads and facilities due to demolition or construction activities from the proposed development.
- h) In order to minimize the amount of sediments, mud, and dust transported onto public roadways by the construction vehicles or runoff, the contractor shall install stabilized temporary construction entrance(s) from the construction site as recommended by FDEP. Each temporal construction entrance is a stabilized 6 inch thick layer of 2 to 3 inch Course Aggregate Stone, 12" minimum width, and length to accommodate a minimum of one trucking vehicle.
 - i. The entrance shall be maintained periodically as conditions demand in a condition that will prevent tracking or flowing of sediments onto public rights-of-way. Sediment shall be trapped in cleanout areas and properly handled as onsite debris per applicable state regulations.
 - ii. When necessary, vehicle wheels shall be cleaned prior to entrance onto public right-of-way.
 - iii. All materials spilled, dropped, washed or tracked from vehicles onto roadways or into public storm drains must be removed by the contractor immediately.
 - iv. Trucks shall not 'cut corners' where the construction exit meets the roadways.
 - v. Sweeping of public roadways shall be done periodically as condition demand.
- i) Dust generated from construction shall be minimized by daily watering of the site.



- j) Contractor shall provide an erosion and sedimentation control inspector to inspect all points of discharge into nearby waterbodies to record the condition of discharge points, integrity of silt fence and pollution control devices, dust control measures, vehicular traffic and construction material storage and disposal. Written record of all inspections shall be stored by the contractor during demolition and construction periods and shall be submitted to City inspectors upon request.

The inspection report shall include at a minimum the following information:

- i. Name of inspector and his/her qualifications in erosion and sedimentation control
 - ii. Date of the inspection
 - iii. Rainfall rate
 - iv. Observations about the SWPP
 - v. Actions taken by contractor for all incidents of noncompliance with permit(s)
 - vi. Certification that the facility is in compliance with the SWPP and permit(s)
2. If dewatering activities are anticipated, a notarized City dewatering affidavit shall be filed at City's building department when submitting a demolition or foundation permit along with any applicable dewatering permit from regulatory agencies such as the South Florida Water Management District or Broward County Department of Environmental Protection.

Dewatering Notes (Applicable if dewatering activities are anticipated)

- a) The applicant shall use Broward County's latest [Plate WM 2.1 - Future Conditions](#) for determining the average wet season ground water levels to evaluate if demolition or excavation/earthwork will require dewatering activities. The Plate WM 2.1 – Future Conditions average wet season ground water levels can be accessed through the following link:
<http://bcgis.maps.arcgis.com/apps/View/index.html?appid=70c3f3ffc88748c28e432719ec2844c4>
- b) If dewatering activities are anticipated, a notarized City dewatering affidavit shall be filed at City's building department when submitting a demolition or foundation permit along with any applicable dewatering permit form regulatory agencies such as the South Florida Water Management District or Broward County Department of Environmental Protection.
- c) If dewatering is going to be needed, please submit a dewatering plan, so it can be reviewed by the City's stormwater and environmental groups.
- d) Dewatering activities will not be allowed without an approved dewatering affidavit, SWPPP, and dewatering permit from applicable regulatory agencies.

GENERAL COMMENTS

2. Please prepare and submit a separate utility demolition plan for review of impact to existing City's stormwater systems.



Existing Stormwater Asset Map possibly affected by the Proposed Development





Case Number: R19003

CASE COMMENTS:

Please provide a response to the following:

1. Garbage, Recycling and Bulk Trash shall be provided by the City.
2. Solid Waste Collection shall be on private property container shall not be placed, stored or block the public street to perform service (large multifamily and commercial parcels).
3. Containers must be stored in garages on non-collection days.
4. Draw containers in garages on site plan.
5. Provide on the site plan a garbage truck turning radii for City review. Indicate how truck will circulate within property.
6. Submit a Solid Waste Management Plan on your letterhead containing name of project, address, DRC case number, number of units if applicable, and indicate whether it is Pre or Final DRC.
 - o This letter is to be approved and signed off by the Sustainability Division, and should be attached to your drawings. Please email an electronic copy to smccutcheon@fortlauderdale.gov. Letter should include an analysis of the expected amounts of solid waste and recyclables that will be generated (if different from current capacity), and container requirements to meet proposed capacity.
 - o Community Inspections will reference this Solid Waste Plan for sanitation compliance issues at this location.

GENERAL COMMENTS

The following comments are for informational purposes.
Please consider the following prior to submittal for Final DRC:

1. None



Case Number: R19003

CASE COMMENTS:

1. Submit a traffic impact statement and coordinate with the Transportation and Mobility Department regarding traffic calming and a traffic impact study if needed. Take into consideration that the review of this study, once submitted, will take about 4-6 weeks once all documents and fees are received.
2. Please dimension the parallel on street parking spaces and make sure they meet the city's geometrical standards.
3. The city reserves the right to meter on street parking stalls in the public right of way at any time.
4. All loading and unloading must be contained on site including postal delivery services and rideshare pick up and drop off.
5. Back of sidewalk should begin on the ultimate right of way/easement dedication line.
6. Show all sidewalk and parking dimensions on the site plan, including all pinch points on the site.
7. Please show inbound and outbound stacking requirements from the property line to the first conflict point according to sec 47-20.5 General design of parking facilities.
8. Per ULDR Section 47-2.2.Q, show and label sight triangles as appropriate for safe and adequate access of drivers and pedestrians, on the Site Plan, Landscape Plans, and Civil Plans: intersections of driveways with streets and alleys (10' measured from intersection point of pavement edges), alleys with alleys (15' measured from intersection point of extended property lines), alleys with streets (15' measured from intersection point of extended property lines), and streets with streets (25' measured from intersection point of extended property lines). The request for reduction of sight triangle dimensions is subject to review by the City Engineer on a case-by-case basis. Per ULDR Section 47-19.1.E, no accessory use or structure shall be permitted within a sight triangle except as provided in ULDR Section 47-35.
9. Ensure all access points, sidewalks, walkways, and curb cuts are unobstructed and ADA accessible with appropriate slopes and detectible warning devices and indicate on the site plan.
10. Additional comments may be provided upon further review.
11. Signature required.

GENERAL COMMENTS:

Please address comments below where applicable.

1. Contact Benjamin Restrepo at 954-828-5216 or brestrepo@fortlauderdale.gov to set up an appointment for final plan approval.



2. The City's Transportation & Mobility Department encourages the use of sustainable materials such as permeable pavement and electric car charge stations and installation of multimodal facilities such as bicycle pump stations and bike lockers.

3. Please note that any work within the City's right-of-way will require an MOT approved by Transportation and Mobility and Engineering for permitting. Any full closures of roadways, alleys, or sidewalks that are over 72 hours will require a Revocable License Agreement (RLA) with the City of Fort Lauderdale.

Case Number: R19003

CASE COMMENTS:

Please provide a response to the following:

1. The applicant is strongly encouraged to contact all neighborhood associations located within three hundred feet (300)' of the development site, to advise of this proposal (a map and listing of all neighborhood associations are listed on the City's website: (<http://www.fortlauderdale.gov/neighbors/civic-associations>)).
2. The site is designated Medium Density Residential on the City's Future Land Use Map. The proposed use is permitted in this designation. This is not a determination of consistency with the City's Comprehensive Plan Goals, Objectives and Policies.
3. Verify that copy of plat is the most current recorded plat, including notes and amendments, for the proposed site. Provide documentation from the Broward County Planning Council verifying that the site does not require platting or replatting. If replatting or platting is not required, contact the Development Review Services Section of the Planning and Environmental Regulation Division of Broward County at (954) 357-6637 to ensure that proposed project is consistent with the latest recorded plat restriction.
4. Please contact Thuy (twee) Turner, AICP, Broward County Planning and Development Division, tturner@broward.org or 954-357-6623, to ensure the proposed plat note language meets their standards before moving forward. Please provide staff with written response from the County.
5. Indicate the project's compliance with ULDR Sec. 47-25.2, Adequacy Requirements, By providing a point-by-point narrative response, on letterhead, with date and author indicated.
6. Consider or provide the following changes on site plan:
 - a. Consider multi-family design to allow for more compact development, less impervious area, more direct circulation and retention of trees;
 - b. In order to provide a strong and active frontage along SW 20th Avenue, reorient site plan so that buildings run parallel to the street, rather than perpendicular to it;
 - c. Design retention areas so that they appear as passive recreation area when not holding water;
 - d. Provide greater dispersal of open space throughout site.
7. Provide the following changes on elevations:
 - a. Redesign facades facing SW 20th Avenue and SW 5th Place so that front doors, prominent rear doors and semi-private yards face the public right of ways.
8. It is recommended the following pedestrian and bicycle-related comments be addressed:
 - a. Label and dimension all proposed pedestrian access/circulation areas: sidewalks, paths, crosswalks etc. (including width) to/from and within the site;
 - b. Send email to brestrepo@fortlauderdale.gov for information on bicycle parking standards and to obtain a copy of the Assoc. of Pedestrian and Bicycle Professionals [APBP] Bicycle Parking Guidelines and Broward County End-of-Trip Bicycle Facility Guide.
9. The City's Vision is to support sustainable infrastructure. Consider employing green building practices throughout the project such as, but not limited to; charging stations, tank-less water heaters, rain collection systems, pervious pavement where appropriate, bio-swales, Florida Friendly™ plant materials, solar panels and green roofs.



10. Provide roof plan for all structures indicating the location of all mechanical equipment. This plan shall include spot elevations of the parapet wall and roof as well as mechanical equipment to verify adequate screening and to illustrate how equipment will be screened or shielded from view. In addition, indicate all mechanical equipment within the subject site on the site plan and elevations where applicable. Discuss the use of the roof as an accessible amenity.
11. Indicate all utilities (both above and below ground) that would affect the proposed planting or landscape plan. Overhead lines (if any) should be placed underground. If the lines cannot be placed underground provide documentation from FP&L indicating such. To ensure proposed trees can be planted as shown on plans, perform underground utility verification and provide confirmation of no obstruction prior to final Development Review Committee (DRC) approval.
12. Pursuant to ULDR, Section 47-22.4.C.8, provide a master sign plan detailing the information below. Please note, any proposed signs will require a separate permit application:
 - a. Location and orientation of all proposed signage;
 - b. Dimensions of any proposed signage (height, width, depth, etc.);
 - c. Proposed sign copy; and,
 - d. Proposed colors and materials.
13. Provide legible photometric plan for the entire site. Extend values on photometric plans to all property lines. Show values pursuant to the Unified and Land Development Regulations ("ULDR"), Section 47-25.3.A.3.a and 47-20.14. Indicate lighting poles on site plan and landscape plan, and provide detail with dimensions. Garage internal lighting fixtures and glare cannot be visible from neighboring properties.

Indicate lighting poles on site plan and landscape plan, and provide detail with dimensions. Light poles appear within the parking stalls, please clarify on plans. Consider reduced height of poles due to proximity of the project nearby residential area. Be aware that lighting fixtures greater than ten (10) feet in height are used, they shall be located a minimum of fifteen (15) feet away from shade trees (Sec. 47-20.14)

14. This project is subject to the requirements of Broward County Public School Concurrency. The City will notify the School Board Superintendent or designee of this proposal. Prior to submitting an application for placement on a Planning and Zoning Board or City Commission agenda, a written response from the School Board must be provided to the project planner. In addition, no residential development application shall receive final DRC approval without proof and confirmation from the School District that the residential development is exempt or vested from the requirements of public school concurrency, or a School Capacity Availability Determination (SCAD) letter that confirms that capacity is available, or if capacity is not available, that mitigation requirements have been satisfied.
15. Applicant will be required to pay a Park Impact Fee for the proposed residential units prior to issuance of building permit in accordance with ULDR Sec. 47-38A, Park Impact Fees.

GENERAL COMMENTS



The following comments are for informational purposes. Please consider the following prior to submittal for Final DRC:

16. All construction activity must comply with Sec. 24-11, Construction sites. Contact John Travers, Chief Building Inspector, at 828-5913 to obtain his signature on the final DRC plans.
17. An additional follow-up coordination meeting may be required to review project changes necessitated by the DRC comments. Prior to routing your plans for Final DRC sign-off, please schedule an appointment with the project planner (954-828-5265) to review project revisions and/or to obtain a signature routing stamp.
18. Provide a written response to all DRC comments within 180 days.

Please consider the following prior to submittal for Building Permit:

19. If a temporary construction/sales trailer is needed for this project, provide the details and location of the trailer on an additional site plan, to avoid additional review in the future. Ensure details and location receives approval from the Building Services Division's DRC Representative.

Legend

-  Subject Site
-  FTL Corp Limits

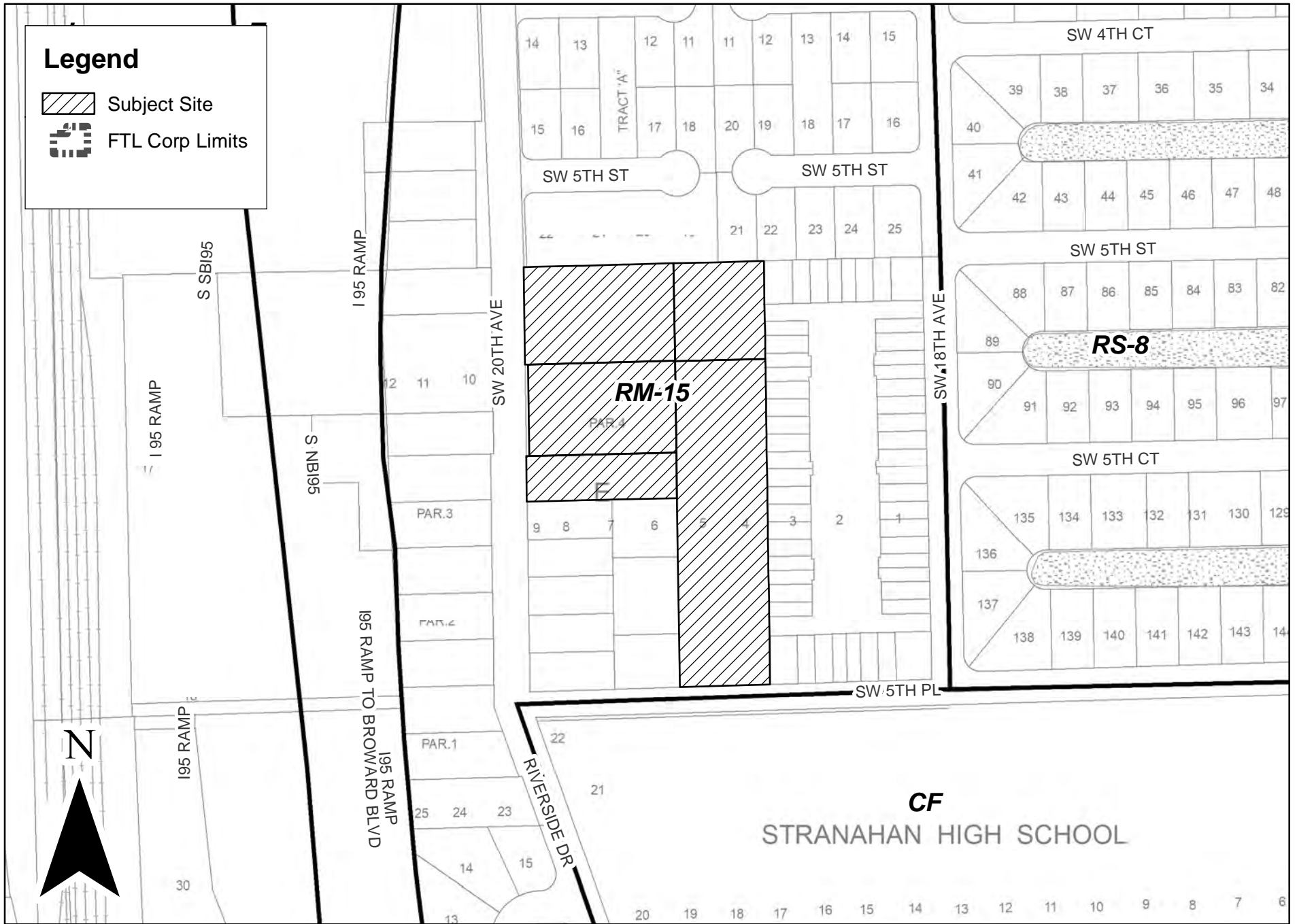

R19003

