



## DEVELOPMENT REVIEW COMMITTEE (DRC) COMMENT REPORT

**MEETING DATE:** March 26, 2019

**APPLICANT:** SPVEF-SKID, LLC.

**PROJECT NAME:** Marina Mile Yacht Center

**CASE NUMBER:** R19020

**REQUEST:** Site Plan Level II Review: 1,347 Square Foot  
Building Addition for Office

**LOCATION:** 2200 Marina Bay Drive

**ZONING:** Heavy Commercial / Light Industrial (B-3)

**LAND USE:** Commercial

**CASE PLANNER:** Tyler LaForme



**Case Number: R19020**

**CASE COMMENTS:**

- 1) Provide dimensioning compliant with FBC Accessibility paths of egress on the plan.
- 2) Provide the FBC Building Type designations on the plans showing the required building separations correlating to FBC Table 601 and FBC Table 602.

**GENERAL COMMENTS**

The following comments are for informational purposes.

Please consider the following prior to submittal for Final DRC:

1. The Florida Building Code shall apply to the construction, alteration, movement, enlargement, replacement, repair, equipment, use and occupancy, location, maintenance, removal and demolition of every building or structure or any appurtenances connected or attached to such buildings or structures.
2. All projects must consider safeguards during the construction process. Florida Building Code Chapter 33 delineates various safeguards that may apply during the construction phase. All structures associated with the protection of pedestrians will require a separate permit. A licensed professional must sign and seal the plans and specifications.
3. The City of Fort Lauderdale is a participating municipality in the National Flood Insurance Program (NFIP). The requirements specific to the City of Fort Lauderdale can be found in

**Chapter 14 - FLOODPLAIN MANAGEMENT of the Code of Ordinances** and accessed at;

a. [https://www.municode.com/library/fl/fort\\_lauderdale/codes/code\\_of\\_ordinances?nodeld=C00R\\_CH14FLMA](https://www.municode.com/library/fl/fort_lauderdale/codes/code_of_ordinances?nodeld=C00R_CH14FLMA)

**Please consider the following prior to submittal for Building Permit:**

1. On January 1<sup>st</sup>, 2018 the 6<sup>th</sup> Edition of the Florida Building Code was adopted. All work described in Section 101.2, of the Broward County Administrative portion of the Florida Building Code, will govern the administration and enforcement of the proposed work. Each building and or structure will require a separate permit. The following websites will assist in the design considerations:
  - a. <http://www.fortlauderdale.gov/departments/sustainable-development/building-services>
  - b. [https://floridabuilding.org/bc/bc\\_default.aspx](https://floridabuilding.org/bc/bc_default.aspx)
  - c. <http://www.broward.org/codeappeals/pages/default.aspx>

**General Guidelines Checklist is available upon request.**



Case Number: R19020

**DEDICATION OF RIGHTS-OF-WAY:** Per ULDR Section 47-25.2.M.5, property shall be conveyed to the public by plat, deed or grant of easement as needed in accordance with the Broward County Trafficways Plan, the city's comprehensive plan, subdivision regulations and accepted applicable traffic engineering standards:

1. A permanent Easement is shown along east property boundary which is being proposed as access to the new building. Please coordinate with property owner to determine what type of work/access is allowed. Proposed parking lot improvements on adjacent private property (i.e. to the east) would require written permission from those property owners.
2. Show/label cross access agreement/easement through properties to the south, since this project does NOT abut public Right-of-Way.

**CASE COMMENTS:**

**Prior to Final DRC sign-off, please provide updated plans and written response to the following review comments:**

3. Meet the City's Adequacy requirements to services provided to the public (fire service, water, wastewater, stormwater, transportation, etc.), per ULDR Section 47-25.2 of the City's Code of Ordinances. Assess potential demands and impacts on City services and prepare a design for each that utilizes existing water, wastewater, stormwater, and transportation infrastructure to adequately serve this project. If the adequate infrastructure is not available, prepare a design that extends/expands the connection to the nearest City system to adequately serve this development.
4. Provide a current signed and sealed boundary and topographic survey showing all above ground improvements, utilities, rights of way dimensions and all easements. This survey shall be based on a Standard Title Commitment issued by a title insurer licensed to do business in Florida or an Opinion of Title issued by an attorney admitted to the Florida Bar. The title commitment or Opinion of Title must have an effective date no more than thirty days prior to the date of submittal of the survey and must be certified to the City of Fort Lauderdale. If any encumbrances are found in the property, provide a copy of the recorded documents accordingly (i.e. easements, dedications, agreements, vacations, etc.).

Property lines, NVAL, Right-of-Way, watercourses, easements, structures, and roadway shall be clearly shown, labeled and dimensioned. Provide spot elevations on site, at property corners, along property lines (50' min. interval), existing roadway crowns and pavement edges adjacent to property as appropriate. Elevations shall be referenced to the North American Vertical Datum of 1988 (NAVD 88). Sufficient information must be provided on survey in order to staff to determine proposed development improvements are being coordinated with adjacent right of way and properties.

Please provide boundary survey that is based on Standard Title Commitment or Opinion of Title.

Ensure survey depicts all information requested above as well as any information beyond limits of property that maybe required for coordination between existing and proposed improvements adjacent to the site.

5. Provide disposition of existing utilities on-site and within the adjacent right of way that maybe impacted by the proposed development. Label information on plans (i.e. utility to remain/ be relocated/ removed). Provide correspondence from utility owner (as applicable) and depict any additional requirements they may have on plan (i.e. easements). Utilities include but are not limited



to above and underground water, sewer, drainage, electrical, communications, light/power poles, down guys, fire hydrants, manholes, etc.

6. There is a 10' FPL easement on the east side of the property. Proposed required on-site improvements (i.e. building, foundation, back flow preventer, fdc, clean out, doors, etc.) shall not be constructed within existing right of way/ dedications/ easements. A 'letter of no objection' from each private utility owner that has an interest in this Easement will also be required.
7. Provide disposition of existing light poles, fire hydrants, and any other utilities within the adjacent right of way that may be impacted by the proposed development.
8. Per ULDR Section 47-19.3 (Seawall Ordinance): the top of seawall for redeveloped property shall be between elevation 3.9 feet NAVD88 (minimum height) and FEMA base flood elevation for the property (maximum height) except as described under ULDR Section 47-19.3.f; allowance for fixed docks to extend 10 inches above the adjacent seawall; allowance for floating docks and requirement that they be permitted and permanently attached. Confirm location of existing seawall and dock relative to property boundary fronting waterway. (include review comment only for projects located adjacent to canal or water body)
9. For surface or ground-level parking lot layout:
  - a. Show and label total number of parking stalls, dimension areas including drive aisle widths, and typical parking stall width/depth.
  - b. Per ULDR Section 47-20.11.A, drive aisle width shall be 24' (min.) adjacent to 90-degree angle parking stalls.
  - c. The minimum clear width and depth parking stall dimensions shall be 8'-8" and 18'-0", respectively.
10. Provide conceptual Water and Sewer Plan that features proposed connections to City infrastructure, including limits of any existing City water main and/or sanitary sewer infrastructure to be removed and/or modified, and location of all existing utilities in vicinity of the proposed improvements (that may be in conflict).
11. Provide sufficient existing and proposed grades and information on conceptual Paving, Grading, and Drainage Plan and details to demonstrate how stormwater runoff will remain onsite ((include typical cross-sections along all property lines as appropriate, typical lot grading for the proposed building within site, and depict how the new stormwater system will connect to the existing on-site drainage system)), and how the proposed project will not adversely impact the adjacent Right-of-Way, and waterways. Drainage mitigation shall be required for any impacts within the adjacent City Right-of-Way such as increased runoff or reduction of existing storage/treatment due to proposed improvements, in accordance with the City of Fort Lauderdale Comprehensive Plan (Ordinance C-15-08), Objective 4.1 under Infrastructure elements.
12. Depict proposed building doors and provide sufficient grades/details on conceptual paving, grading and drainage plans to verify ADA accessibility design for the site, especially ground floor access to the new building, as well as crossing proposed driveways and connecting to existing sidewalks (at intersections and with adjacent property) as appropriate; coordinate proposed site grading and Finished Floor Elevations to meet ADA accessibility requirements.
13. Provide storm runoff calculations, signed and sealed by a Florida registered professional engineer, which demonstrate how minimum criteria regarding adjacent street crown, water quality and finished floor elevations are met, as well as how the 25-year, 3-day storm event is maintained on site



with zero discharge to Right-of-Way and adjacent properties (Pre vs. Post analysis will only be allowed in areas that are not flood-prone). Please also comply with the City of Fort Lauderdale Comprehensive Plan (Ordinance C-08-18), Objective 4.1 under Infrastructure Elements, and be advised that effective 7/1/2017, all projects must comply with the Broward County 'Future Conditions Average Wet Season Groundwater Level' map.

14. Discuss how surface runoff from the proposed development (between building and Right-of-Way boundaries) will be mitigated such that it won't be conveyed into the adjacent existing public storm drain infrastructure or waterways. Show location of building roof drains, and their proposed connection(s) to the on-site drainage system.
15. Within adjacent City Right-of-Way, staging/storage will not be allowed. Any City Right-of-Way closure over 72 hours requires a Revocable License Agreement, processed by Property Right-Of-Way Committee (DRC) and approved by the City's Commission, prior to Right-of-Way permit issuance by the Department of Sustainable Development for Maintenance of Traffic.

Prior to submitting Administrative Review (i.e. DRC Level I) application to request Revocable License Agreement, please contact Dennis Girisgen at 954-828-5123 or [dgrisgen@fortlauderdale.gov](mailto:dgrisgen@fortlauderdale.gov) to discuss proposed scope of closure within City Right-of-Way.

16. For Engineering General Advisory DRC Information, please visit our website at <https://www.fortlauderdale.gov/home/showdocument?id=30249>
17. Additional comments may be forthcoming at the DRC meeting and once additional/ revised information is provided on plans.

**Public Works (Ray Rammo, P.E. 954-828-5990):**

1. Meet the County's Adequacy requirements to services provided to the public (fire service, water, wastewater, stormwater, transportation, etc.). Assess potential demands and impacts on County services and prepare a design for each that utilizes existing water, wastewater, stormwater, and transportation infrastructure to adequately serve this project. If the adequate infrastructure is not available, prepare a design that extends/expands the connection to the nearest County system to adequately serve this development.
  - a. Provide County's approval letter of the service demand calculations for water & wastewater services.
2. Please email [CRBARRETT@FORTLAUDERDALE.GOV](mailto:CRBARRETT@FORTLAUDERDALE.GOV) to obtain copies of the City utility maps as applicable to the project location and show existing City utilities and easements (stormwater utilities) in proposed engineering plans (utility demolition, stormwater pollution prevention plan (SWPPP), and civil plans).
3. Provide conceptual Water and Sewer Plan that features proposed connections to County infrastructure, including limits of any existing water main and/or sanitary sewer infrastructure to be removed and/or modified, and location of all existing utilities in vicinity of the proposed improvements.
4. Label on the plans, proposed water service connections and sewer lateral sizes and material on conceptual Water and Sewer Plan.
5. Address pipe conflicts, if any exist.
6. Any road cuts for utilities or curb cuts within City Right-of-Way shall be restored to full lane width for 50' minimum length (by contractor), per City Code of Ordinances Section 25-108; show and label in



plans as appropriate. Verify with FDOT and/or BCHCED their requirements for any milling and asphalt pavement restoration in vicinity of proposed road cuts for utilities and/or curb cuts within their respective Right-of-Way jurisdictions.

7. Conceptual Paving, Grading, and Drainage Plan:

- a. Provide sufficient existing and proposed grades and information on conceptual Paving, Grading, and Drainage Plan and details to demonstrate how stormwater runoff will remain onsite (include typical cross-sections along all property lines as appropriate, typical lot grading for the proposed single family homes within the development, and depict how the new stormwater system will connect to the existing on-site drainage system), and how the proposed project improvements (i.e. on-street parking, sidewalks, etc.) will not adversely impact the adjacent Right-of-Way, properties and waterways. Show location of building roof drains, and their proposed connection(s) to the on-site drainage system.
- b. Drainage mitigation shall be required for any impacts within the adjacent City Right-of-Way such as increased runoff or reduction of existing storage/treatment due to proposed improvements, in accordance with the City of Fort Lauderdale Comprehensive Plan (Ordinance C-15-08), Objective 4.1 under Infrastructure Elements. Engineer of Record (EOR) shall evaluate the adjacent City roadway system capacity and demonstrate that the proposed improvements will not negatively impact the City's existing drainage system and provide recommendations in compliance with the City's Comprehensive Plan (i.e. meets or exceeds the 10-year/1-day storm event drainage criteria). Applicant shall be responsible for maintenance of these proposed storm drain infrastructure improvements located within City Right-of-Way during a 1-year warranty period, until accepted by the City's Public Works Department. (coordinate as appropriate with the respective FDOT and BCHCED agencies for mitigation of additional runoff within those jurisdictions).
- c. Please note that private stormwater infrastructure (drainage pipes, wells, or basins,), Trees, or Permanent Structures (fences, walls, etc.) are not permitted in City Right of Way or City drainage easements. Please remove any proposed stormwater systems, trees, or permanent structures that are not in compliance with this requirement or provide appropriate documentation of City Rights-of-Way or easement vacated to allow the construction of private underground utilities.

8. Provide storm runoff calculations, signed and sealed by a Florida registered professional engineer, which demonstrate how minimum criteria regarding adjacent street crown, water quality and finished floor elevations are met, as well as how the 25-year, 3-day storm event is maintained on site with zero discharge to Right-of-Way and adjacent properties (Pre vs. Post analysis will only be allowed in areas that are not flood-prone). Please also comply with the City of Fort Lauderdale Comprehensive Plan (Ordinance C-08-18), Objective 4.1 under Infrastructure Elements, and be advised that effective 7/1/2017, all projects must comply with the Broward County 'Future Conditions Average Wet Season Groundwater Level' map.

9. If dewatering activities are anticipated, a notarized City dewatering affidavit shall be filed at City's building department when submitting a demolition or foundation permit along with any applicable dewatering permit form regulatory agencies such as the South Florida Water Management District or Broward County Department of Environmental Protection.

10. If Exfiltration Trenches are proposed:

- a. Provide exfiltration trench for all on-street parking areas (i.e. within City Right-of-Way adjacent to the proposed development) and corresponding drainage calculations.
- b. Provide drainage inlet (per City standard details and specifications) on each end of exfiltration trench located within City Right-of-Way.



- c. Provide at least a clean out structure at each end of exfiltration trench located within the property.
11. Contact the Floodplain Manager, Richard Benton at 954-828-6133 or [rbenton@fortlauderdale.gov](mailto:rbenton@fortlauderdale.gov) regarding proposed Finished Floor elevation and fill requirements per City's Code of Ordinances Chapter 14 – Floodplain Management, including Ordinance C-14-26. Especially where proposed elevations appear to be **over 2'** higher than existing ground. Provide correspondence and depict information on plans accordingly.
12. Show and label all existing and proposed utilities (utility type, material and size) on civil and landscaping plans for potential conflict. A min. 5 feet and 10 feet horizontal clearance horizontal separation is required between city utilities infrastructure and proposed small and large trees, respectively (including proposed water and sewer services to the development). Any new trees (located within or adjacent to City Right-of-Way) should be placed with sufficient horizontal and vertical distances (per City, County, and State guidelines) to / from City's public infrastructure, including stormwater assets, to allow for continued Public Works maintenance without obstruction. If this cannot be accommodated due to field conditions, then the developer shall relocate the existing City's public infrastructure to resolve the conflict(s) and to comply with City's, County's & State's engineering standards/permits/policies. Ensure separation is provided and include a note regarding horizontal clearance requirement on the landscape plans.
13. Discuss how surface runoff from the proposed development (between building and Right-of-Way boundaries) will be mitigated such that it won't be conveyed into the adjacent existing public storm drain infrastructure or waterways, and whether additional infrastructure will be required within City Right-of-Way (**coordinate as appropriate with the respective FDOT and BCHCED agencies for mitigation of additional runoff within those jurisdictions**). Show location of building roof drains, and their proposed connection(s) to the on-site drainage system.
14. Evaluate the possibility of utilizing a sustainable stormwater approach with the possibility of low impact (cisterns, pervious pavers, bioswales, raingardens, etc.) uses for landscaping along the streetscape.
15. Please provide (or revise if already submitted) an erosion, sedimentation, and stormwater pollution prevention plan (SWPPP) showing the adjacent City's existing stormwater system. A copy of the approved SWPP shall be at the construction site from the date of demolition initiation to the date of final construction activities.
16. For Engineering General Advisory DRC Information, please visit our website at <https://www.fortlauderdale.gov/home/showdocument?id=30249>

Additional comments may be forthcoming at the DRC meeting and once additional/ revised



Case Number: R19020

**CASE COMMENTS:**

Please provide a response to the following:

1. The City has adopted Florida Friendly Landscaping requirements into our ULDR Section 47-21. This basically means that plant material must be grouped together based on watering needs (hydro zone) and turf areas must be limited and/or consolidated to less than 50% of the landscaped area. Plant material species must be minimum 50% Florida Friendly Landscaping. Planting areas are to be irrigated on a separate zone than the turf areas so that once the plants are established, that particular zone can be shut off based on the season. The overall goal is to decrease water use through irrigation. Illustrate hydro zones on planting plan, and include calculations in table.
2. The use of structural soil is required in paved sites to provide adequate soil volumes for tree roots under pavements, as per ULDR Section 47-21.13. CU Structural soil details and specifications can be obtained at <http://www.hort.cornell.edu/uhi/outreach/index.htm#soil> This is to be provided at a minimum of 8' radii of tree trunks, and is to be consistently illustrated and noted on landscape, site and civil plans.
  - a. Provide Structural Soil Detail
  - b. There is a component missing from the structural soil composition list that acts as a tackifier. This hydrogel, a potassium propenoate - propenamide copolymer is added to prevent separation of the stone and soil during mixing and installation.
3. The structural soil drain is required when percolation rates are less than 4" vertical clearance per hour. Provide documentation of report used to prove this calculation. The drain and connections are to be illustrated on civil plans.
4. There is a product that the Landscape Department will approve the use of in place of Structural soil. With the Structural soil repositioning of the underground utilities is required. A suspension modular paving system product will provide the required root development area for a healthy and vibrant tree, along with their use it will allow the utilities to be in place and not affect their location in conjunction with the tree's root system. Please look into the use of the Green Blue Urban soil cell, Silva cell or like product for this and all future site developments.

As with the use of Structural soil a detail of the product and indication of the extent of use to be provided of the soil cell pavement support systems product.
5. Tree and Plant species included on the Florida Exotic Pest Plant Council's Invasive Plant Species List as amended, shall not be planted as required or optional landscaping, as per ULDR Section 47-21.18, and invasive plant species listed shall be removed from the site, as per ULDR Section 47-21.8.I.
6. Review landscape plan requirements for data to be included on plans, as per ULDR Section 47-21.6.
7. Please visit Sec.47-21. "Landscape and Tree Preservation Requirements" for site landscape requirements.
  - a. Tree percentage is incorrect. Please revisit section 47-21.12.C.1.a-e.





8. Peninsular and island areas shall be a minimum of three-quarters ( $\frac{3}{4}$ ) the length of the adjacent parking space by a minimum of eight (8) feet in width. This 8 feet landscape width is from inside to inside curb of the tree island.
  - a. There are proposed tree islands that appear to be under size in width.
9. Peninsular and island areas shall be located at the end of a row of more than two (2) consecutive parking spaces where the row terminates at an aisle or driveway.
  - a. There is a tree proposed at an area next to the parking row where the dumpster enclosure is located that appears to be under size for a tree. Being that trees require a minimum 8 feet width and this is not a required tree island, please look into proposing a palm tree such as a Sable palm tree or provide an 8 feet width landscape area tree island.
10. All peninsular and island landscape areas shall be planted with at least one (1) tree.
  - a. Please propose required trees for landscape area at billboard sign.
11. Landscape areas to be protected from vehicle encroachment as such with curbing.
12. Vehicle overhangs do not count toward minimum landscape area requirements.
  - a. Demonstrate how the landscape will be protected at head of parking stalls.
13. Provide tree protection barricade detail for existing trees on site to remain, as per ULDR 47-21.15. This barricade must be installed prior to the beginning of proposed work, and a landscape job-check inspection may be scheduled.
  - a. In area of proposed work.

### **GENERAL COMMENTS**

The following comments are for informational purposes.

Please consider the following prior to submittal for Building Permit:

1. A separate sub-permit application for Tree Removal, Relocation, and General Landscaping for site is required at time of master permit submittal. These are Landscape and Tree permit application documents different than the Broward County standard applications. Please note this at time of DRC submittal.
2. Provide separate Plumbing sub permit application for irrigation. Irrigation plans are required at time of Building permit submittal. Plans are to be in compliance with ULDR 47-21.6.A.11 and 47-21.10. Note that planting areas are to be irrigated on a separate zone than the turf areas so that once the plants are established, that particular zone can be shut off based on the season. The overall goal is to decrease water use through irrigation. Plant material must be grouped together based on watering needs (hydro-zone) and turf areas must be limited and/or consolidated to less than 50% of the landscaped area. Illustrate hydro-zones on planting plan, and include calculations in table.





Case Number: R19020

**CASE COMMENTS:**

Please provide a response to the following:

1. All exterior glazing should be impact resistant.
2. Entry / exit door should be solid, impact resistant or metal.
3. Entry and exit door should be equipped with a secondary locking system like door pins, deadbolt or burglary prevention hardware.
4. The businesses should be equipped with a CCTV system that would capture an identifiable image of an individual on site. The system should be capable of covering entry and exit points, parking lot, future cash management areas and any other sensitive area of concern.
5. The businesses should be equipped with an intrusion alarm and a silent "Panic" alarm for police response. The alarm system should have battery back-up and or cellular back-up features.
6. Office doors should be equipped so that they may be locked from the inside to be used as possible "Safe Rooms" during an active threat event like an active killer incident.
7. Site lighting and landscape should follow C.P.T.E.D. standards.

**GENERAL COMMENTS**

It is highly recommended that the managing company make arrangements for private security during construction.

Please submit responses in writing prior to DRC sign off.



Case Number: R19020

**CASE COMMENTS:**

Please provide a response to the following:

1. Garbage, Recycling and Bulk Trash shall be provided.
2. Recycling reduces the amount of trash your business creates and it is the best way to reduce monthly waste disposal costs and improve your company's bottom line.
3. Solid Waste Services shall be provided by a Private Contractor licensed by the City.
4. Service Days shall be: No restriction for Commercial collection. Service may not occur earlier than 7:00 am or later than 10:00 pm within 250 feet of residential.
5. Solid Waste Collection shall be on private property container shall not be placed, stored or block the public street to perform service (large multifamily and commercial parcels).
6. Containers: must comply with 47-19.4
7. Dumpster enclosure: concrete pad, decorative block wall, gates hung independently, protective bollards, secondary pedestrian side entry, high strengthen apron and driveway approach, night light, hot water, hose bib, drain, low circulating ventilation for dampness, weep holes, landscaping, smooth surface walkway to accommodate wheeled containers.
8. Draw equipment on site plan.
9. Provide on the site plan a garbage truck turning radii for City review. Indicate how truck will circulate within property.
10. Submit a Solid Waste Management Plan on your letterhead containing name of project, address, DRC case number, number of units if applicable, and indicate whether it is Pre or Final DRC.
  - o This letter is to be approved and signed off by the Sustainability Division, and should be attached to your drawings. Please email an electronic copy to [smccutcheon@fortlauderdale.gov](mailto:smccutcheon@fortlauderdale.gov). Letter should include an analysis of the expected amounts of solid waste and recyclables that will be generated (if different from current capacity), and container requirements to meet proposed capacity.
  - o Community Inspections will reference this Solid Waste Plan for sanitation compliance issues at this location.

**GENERAL COMMENTS**

The following comments are for informational purposes.

Please consider the following prior to submittal for Final DRC:

1. Review current dumpsters capacity to ensure it is sufficient for addition.



Case Number: R19020

**CASE COMMENTS:**

1. Please ensure the minimum fire exit widths are being met for the hall ways even when the doors swing into them.
2. All loading and unloading must be contained on site including postal delivery services and rideshare pick up and drop off.
3. All 90 degree back out parking must have 24 feet in aisle width to back out to.
4. Bicycle parking is strongly encouraged. Consult the APBP Bicycle Parking Guidelines, city of Fort Lauderdale Parking Standards and Broward County End-of-Trip Bicycle Facilities Guide. Provide the minimum long term and short term bicycle parking based on requirements in the guide and include total counts on the site plan data sheet.
5. Ensure all access points, sidewalks, walkways, and curb cuts are unobstructed and ADA accessible with appropriate slopes and detectible warning devices and indicate on the site plan.
6. Additional comments may be provided upon further review.
7. Signature required.

**GENERAL COMMENTS:**

Please address comments below where applicable.

1. Contact Benjamin Restrepo at 954-828-5216 or brestrepo@fortlauderdale.gov to set up an appointment for final plan approval.
2. The City's Transportation & Mobility Department encourages the use of sustainable materials such as permeable pavement and electric car charge stations and installation of multimodal facilities such as bicycle pump stations and bike lockers.
3. Please note that any work within the City's right-of-way will require an MOT approved by Transportation and Mobility and Engineering for permitting. Any full closures of roadways, alleys, or sidewalks that are over 72 hours will require a Revocable License Agreement (RLA) with the City of Fort Lauderdale.



Case Number: R19020

**CASE COMMENTS:**

Please provide a response to the following:

- 1) The applicant is strongly encouraged to contact neighbors adjacent to, as well as condominium and neighborhood associations located within three hundred feet (300') of the development site, to advise of this proposal (a listing of officially-recognized neighborhood associations is provided on the City's website: <http://www.fortlauderdale.gov/neighbors/civic-associations>). Please provide acknowledgement and/or documentation of any public outreach.
- 2) The site is designated as Commercial on the City's Future Land Use Map. The proposed use is permitted in this designation. This is not a determination on consistency with Comprehensive Plan Goals, Objectives and Policies.
- 3) Verify that copy of plat is the most current recorded plat, including notes and amendments, for the proposed site. Provide documentation from the Broward County Planning Council verifying that the site does not require platting or replatting. If replatting or platting is not required, contact the Development Review Services Section of the Planning and Environmental Regulation Division of Broward County at (954) 357-6637 to ensure that proposed project is consistent with the latest recorded plat restriction.
- 4) Contact Bruce Strandhagen, Fire Safety Captain, at [bstrandhegen@fortlauderdale.gov](mailto:bstrandhegen@fortlauderdale.gov) or 954-828-5080 to ensure that the width of the walkway between buildings is adequate. The doors may need to swing in.
- 5) Provide a copy of the agreement to share land, noted on Sheet AD-101.
- 6) The City's Vision is to support sustainable infrastructure. Consider a green sustainable roof as part of this site plan. Green roofs help to conserve energy, improve air quality and may provide an extra amenity space. Other green building practices to be considered throughout the project include tank-less water heaters, rain collection systems, pervious pavement where appropriate, bio-swales, Florida Friendly™ plant materials, and solar panels.
- 7) It is strongly recommended that bicycle parking in visible, well-lit areas as close as possible to pedestrian entryways/doors is provided. In addition where possible, locate bicycle parking facilities in an area that is sheltered/covered. Show internal secured bicycle racks and/or external bike racks on the site plan. Consult the Association of Pedestrian and Bicycle Professionals ("APBP") for Bicycle Parking Guidelines and Broward County End-of-Trip Bicycle Facilities Guide at <http://www.apbp.org/>. For more information on bicycle parking standards, please email Karen Warfel at [KWarfel@fortlauderdale.gov](mailto:KWarfel@fortlauderdale.gov).

**GENERAL COMMENTS:**

The following comments are for informational purposes.

Please consider the following prior to submittal for Final DRC:

- 8) Provide a written response to all DRC comments within 180 days.
- 9) If a temporary construction/sales trailer is needed for this project, provide the details and location of the trailer on a separate site plan, to avoid additional review in the future. Verify details and location with the Building Representative.



- 10) An additional follow-up coordination meeting may be required to review project changes necessitated by the DRC comments. Prior to routing your plans for Final DRC sign-off, please schedule an appointment with the project planner (Tyler Laforme 954-828-5633) to review project revisions and/or to obtain a signature routing stamp.
- 11) All construction activity must comply with ULDR, Section 24-11, Construction sites. Contact Joe Pasquariello, Structural Plans Examiner (954-828-5419) to obtain his signature on the final DRC plans.
- 12) Additional comments may be forthcoming at the DRC meeting.

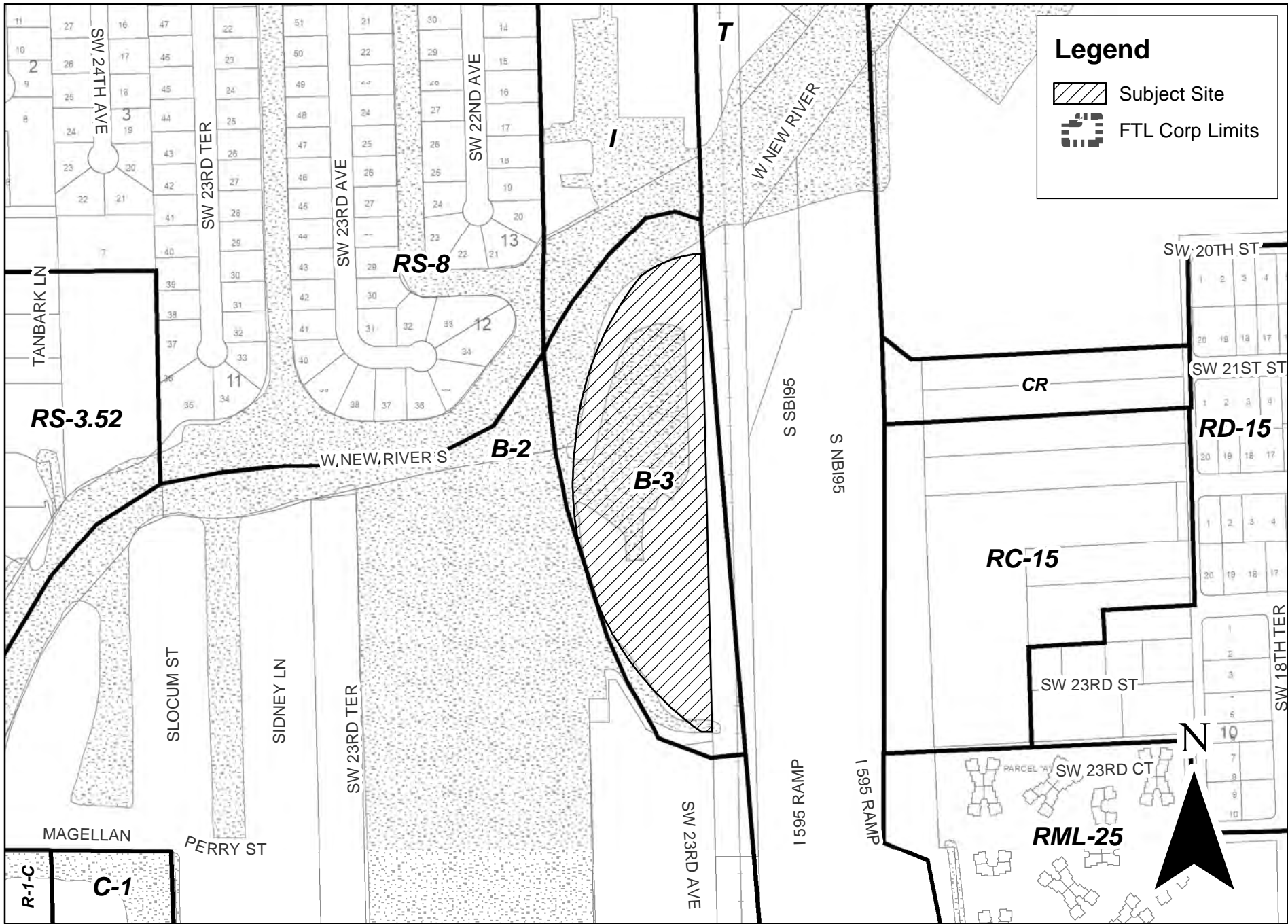

# R19020

