



DEVELOPMENT REVIEW COMMITTEE (DRC) COMMENT REPORT

MEETING DATE: October 8, 2019

APPLICANT: West Cypress Creek Holdings, LLC.

PROJECT NAME: FXE Office

CASE NUMBER: R19068

REQUEST: Site Plan Level II Review: 37,222 Square Foot Office Building

LOCATION: 2050 NW 62nd Street

ZONING: General Aviation Airport (GAA)

LAND USE: Employment Center

CASE PLANNER: Nicholas Kalargyros



Case Number: R19068

CASE COMMENTS:

- 1) Provide the FBC Building Type designation on the plans.
- 2) Designate Sprinkler System Coverage.
- 3) Detail Egress provisions for B Occupancy per FBC, Chapter 10.
- 4) Show Provisions for open ground floor interior parking, FBC 406.6
- 5) Provide Accessible Travel Details for the Site per FBC Accessibility.

GENERAL COMMENTS

The following comments are for informational purposes.

Please consider the following prior to submittal for Final DRC:

1. The Florida Building Code shall apply to the construction, alteration, movement, enlargement, replacement, repair, equipment, use and occupancy, location, maintenance, removal and demolition of every building or structure or any appurtenances connected or attached to such buildings or structures.
2. All projects must consider safeguards during the construction process. Florida Building Code Chapter 33 delineates various safeguards that may apply during the construction phase. All structures associated with the protection of pedestrians will require a separate permit. A licensed professional must sign and seal the plans and specifications.
3. The City of Fort Lauderdale is a participating municipality in the National Flood Insurance Program (NFIP). The requirements specific to the City of Fort Lauderdale can be found in **Chapter 14 - FLOODPLAIN MANAGEMENT of the Code of Ordinances** and accessed at;
a. https://www.municode.com/library/fl/fort_lauderdale/codes/code_of_ordinances?nodeId=COOR_CH14FLMA

Please consider the following prior to submittal for Building Permit:

1. On January 1st, 2018 the 6th Edition of the Florida Building Code was adopted. All work described in Section 101.2, of the Broward County Administrative portion of the Florida Building Code, will govern the administration and enforcement of the proposed work. Each building and or structure will require a separate permit. The following websites will assist in the design considerations;
a. <http://www.fortlauderdale.gov/departments/sustainable-development/building-services>
b. https://floridabuilding.org/bc/bc_default.aspx
c. <http://www.broward.org/codeappeals/pages/default.aspx>

General Guidelines Checklist is available upon request.



Case Number: R19068

DEDICATION OF RIGHTS-OF-WAY: Per ULDR Section 47-25.2.M.5, property shall be conveyed to the public by plat, deed or grant of easement as needed in accordance with the Broward County Trafficways Plan, the city's comprehensive plan, subdivision regulations and accepted applicable traffic engineering standards:

- a. Provide 5' Right-of-Way dedication or permanent Right-of-Way Easement along south side of Cypress Creek Road/NW 62nd Street (coordinate with BCHCED), to complete half of 110' Right-of-Way section per the most current Broward County Trafficways Plan; show/label delineation in the plans. Clarify with BCHCED if Right-of-Way dedication (which may affect building setbacks) or Right-of-Way Easement (which doesn't affect building setbacks) will be required.
- b. Provide 10' x 15' (min.) permanent Utility Easement for any 4 Inch or larger water meter and/or the first private sanitary sewer manhole located within the proposed development (for City Maintenance access); show / label delineation in the plans as appropriate.

CASE COMMENTS:

Prior to Final DRC sign-off, please provide updated plans and written response to the following review comments:

1. Please provide boundary survey that is based on an updated Standard Title Commitment or Opinion of Title. The title commitment or Opinion of Title must have an effective date no more than thirty days prior to the date of submittal of the survey and must be certified to the City of Fort Lauderdale. If any encumbrances are found in the property, provide a copy of the recorded documents accordingly (i.e. easements, dedications, agreements, vacations, etc.).

Ensure survey depicts all information requested above as well as any information beyond limits of property that maybe required for coordination between existing and proposed improvements adjacent to the site.

2. Please coordinate with Broward County regarding the proposed driveway access easement within the limits of the non-vehicular access line (NAVL).
3. Clarify if existing 10' Sanitary Sewer Easement along the east property boundary in the adjacent property is a public or private easement. It does not appear that there is a public sewer main within this easement.
4. Please verify the width of the FPL Easement along the north boundary of the property. The survey provided label the easement as 15', but the civil plans label the easement as 12'.
5. Provide disposition of existing utilities on-site and within the adjacent right of way that maybe impacted by the proposed development. Label information on plans (i.e. utility to remain/ be relocated/ removed). Provide correspondence from utility owner (as applicable) and depict any additional requirements they may have on plan (i.e. easements). Utilities include but are not limited to above and underground water, sewer, drainage, electrical, communications, light/power poles, down guys, fire hydrants, manholes, etc.
6. Clearly indicate on plans the limits of construction and how the proposed improvements will transition into the existing (on-site and off-site) as applicable.



7. Provide disposition of existing light poles, fire hydrants, and any other utilities within the adjacent right of way that may be impacted by the proposed development.
8. Discuss status of existing parking agreement with adjacent property owner to the east, that apparently allows vehicular access through private property which is slated to serve the proposed development.
9. Per ULDR Section 47-2.2.Q, show and label sight triangles as appropriate for safe and adequate access of drivers and pedestrians, on the Site Plan, Landscape Plans, and Civil Plans: intersections of driveways with streets and alleys (10' measured from intersection point of pavement edges), alleys with alleys (15' measured from intersection point of extended property lines), alleys with streets (15' measured from intersection point of extended property lines), and streets with streets (25' measured from intersection point of extended property lines). The request for reduction of sight triangle dimensions is subject to review by the City Engineer on a case-by-case basis. Per ULDR Section 47-19.1.E, no accessory use or structure shall be permitted within a sight triangle except as provided in ULDR Section 47-35. Ensure sight triangles are also depicted on adjacent driveways that would be impacted by proposed improvements on this project. Sight triangles located at the intersection of a local street or driveway with a right-of-way under County jurisdiction is subject to the sight visibility requirements of that jurisdiction.
10. Discuss dumpster enclosure/ trash pick-up access requirements with case planner and waste management. Clearly depict trash enclosure on site plan. Show truck turning movements in and out the proposed dumpster enclosure/ building as applicable. Per ULDR Section 47-19.4.D.6, all dumpster enclosures and adjacent service access drive shall be placed on poured concrete, solid or perforated interlocking concrete block paving (ICB), or any existing hardened paving system.
11. Discuss status of any access agreement (if applicable) regarding the dumpster with adjacent property owner to the east.
12. Provide and label typical roadway cross-sections for the proposed development side of Cypress Creek Road/NW 62nd Street at driveway access points as appropriate.
13. Provide written permission from each adjacent property owner to the east for vehicular access; provide signage as appropriate for 2-way vehicular access along east property boundary
14. Existing public sidewalks adjacent to proposed development (to remain) must be inspected by Engineer of Record to ensure existing sidewalks meet ADA standards and are in good condition. A signed and sealed assessment must be provided indicating sidewalks were inspected and any sidewalk replacement requirements. Plans shall reflect extent of sidewalk replacement accordingly.
15. Continue concrete sidewalk across and delineate with FDOT's 'Curbed Roadway – Flared Turnouts' standard detail (Index 515 – Sheet No. 2 of 7) for proposed West Cypress Creek Road driveway access point (coordinate with BCHCED).
16. Show truck turning template circulation (label typical minimum centerline turning radius) entering and exiting the site serving the Type I loading zones required for the proposed development. Clarify how the Type I loading zone will impact the drive aisle. Turning geometries and loading zone design shall be in accordance with ULDR Section 47-20.6.
17. Depict proposed building doors and provide sufficient grades/details on conceptual paving, grading and drainage plans to verify ADA accessibility design for the site, especially ground floor access to the new building, as well as crossing proposed driveways and connecting to existing sidewalks (at



intersections and with adjacent property) as appropriate; coordinate proposed site grading and 1st Level Finished Floor Elevations to meet ADA accessibility requirements.

18. Within adjacent City Right-of-Way, staging/storage will not be allowed, construction fence shall not encroach within intersection corner sight triangles, construction fence gates shall not swing into the public Right-of-Way, and any loaded Jib Crane radius shall not extend beyond private property boundaries. Any City Right-of-Way closure over 72 hours requires a Revocable License Agreement, processed by Property Right-Of-Way Committee (DRC) and approved by the City's Commission, prior to Right-of-Way permit issuance by the Department of Sustainable Development for Maintenance of Traffic.

Prior to submitting Administrative Review (i.e. DRC Level I) application to request Revocable License Agreement, please contact Dennis Girisgen at 954-828-5123 or dgrisgen@fortlauderdale.gov to discuss proposed scope of closure within City Right-of-Way.

19. Provide Maintenance Agreement Area Exhibit, which provides a visual representation of the area within the adjacent public Right-of-Way (adjacent to the proposed development) to be maintained in perpetuity by the developer. Label whether the adjacent Right-of-Way is FDOT, BCHCED, or City jurisdiction, as well as label all proposed improvements, including asphalt and other specialty paving, specialty sidewalks, landscaping, irrigation, lighting, curb and gutter etc. that will be maintained by the Applicant throughout the life of the improvements.
20. Meet the City's Adequacy requirements to services provided to the public (fire service, water, wastewater, stormwater, transportation, etc.), per ULDR Section 47-25.2 of the City's Code of Ordinances. Assess potential demands and impacts on City services and prepare a design for each that utilizes existing water, wastewater, stormwater, and transportation infrastructure to adequately serve this project. If the adequate infrastructure is not available, prepare a design that extends/expands the connection to the nearest City system to adequately serve this development.
 - a. Prepare service demand calculations for water & wastewater services and obtain a letter of service availability from the City's Public Works – Engineering Department. Submit water and wastewater capacity availability request form and documents/ plans at <https://www.fortlauderdale.gov/departments/sustainable-development/building-services/engineering-forms-and-info/development-review-committee-service-demand-calculations-for-water-sewer>
21. The conceptual Water and Sewer Plan currently shows the proposed connections to City infrastructure across the property lines into the adjacent properties. Revise the proposed water and sewer connections to connect to the existing utilities in a public right-of-way on Cypress Creek Road (NW 62nd Street).
22. Label proposed water service connections and sewer lateral sizes and material on conceptual Water and Sewer Plan. Sanitary sewer clean out must be provided at property line per City standards. Also provide disposition of existing services (i.e. water services and sewer laterals) as applicable.
23. Any road cuts for utilities or curb cuts within City Right-of-Way shall be restored to full lane width for 50' minimum length (by contractor), per City Code of Ordinances Section 25-108; show and label in plans as appropriate. Verify with FDOT and/or BCHCED their requirements for any milling and asphalt pavement restoration in vicinity of proposed road cuts for utilities and/or curb cuts within their respective Right-of-Way jurisdictions.
24. Conceptual Paving, Grading, and Drainage Plan:
 - a. Provide sufficient existing and proposed grades and information on conceptual Paving, Grading, and Drainage Plan and details to demonstrate how stormwater runoff will remain



onsite (include typical cross-sections along all property lines as appropriate), and how the proposed project improvements (i.e. on-street parking, sidewalks, etc.) will not adversely impact the adjacent Right-of-Way, properties and waterways. Show location of building roof drains, and their proposed connection(s) to the on-site drainage system.

- b. The plan shows the proposed drainage inlet S-13 to be connected across the property line to the existing drainage inlet E-2 on the adjacent property. Revise the connection for S-13 to be connected to the proposed on-site drainage system.
 - c. Drainage mitigation shall be required for any impacts within the adjacent City Right-of-Way such as increased runoff or reduction of existing storage/treatment due to proposed improvements, in accordance with the City of Fort Lauderdale Comprehensive Plan (Ordinance C-15-08), Objective 4.1 under Infrastructure Elements. Engineer of Record (EOR) shall evaluate the adjacent City roadway system capacity and demonstrate that the proposed improvements will not negatively impact the City's existing drainage system and provide recommendations in compliance with the City's Comprehensive Plan (i.e. meets or exceeds the 10-year/1-day storm event drainage criteria). Applicant shall be responsible for maintenance of these proposed storm drain infrastructure improvements located within City Right-of-Way during a 1-year warranty period, until accepted by the City's Public Works Department. (coordinate as appropriate with the respective FDOT and BCHCED agencies for mitigation of additional runoff within those jurisdictions).
25. Provide storm runoff calculations, signed and sealed by a Florida registered professional engineer, which demonstrate how minimum criteria regarding adjacent street crown, water quality and finished floor elevations are met, as well as how the 25-year, 3-day storm event is maintained on site with zero discharge to Right-of-Way and adjacent properties (Pre vs. Post analysis will only be allowed in areas that are not flood-prone). Please also comply with the City of Fort Lauderdale Comprehensive Plan (Ordinance C-08-18), Objective 4.1 under Infrastructure Elements, and be advised that effective 7/1/2017, all projects must comply with the Broward County 'Future Conditions Average Wet Season Groundwater Level' map.
 26. If dewatering activities are anticipated, a notarized City dewatering affidavit shall be filed at City's building department when submitting a demolition or foundation permit along with any applicable dewatering permit form regulatory agencies such as the South Florida Water Management District or Broward County Department of Environmental Protection.
 27. Exfiltration Trenches:
 - a. Provide at least a clean out structure at each end of exfiltration trench located within the property.
 28. Clarify design intent of site grading in the vicinity of proposed building, especially with regards to fill requirements per City's Code of Ordinances Chapter 14 – Floodplain Management, including Ordinance C-14-26. Please contact the Floodplain Manager, Richard Benton at 954-828-6133 or rbenton@fortlauderdale.gov.
 29. Contact the Floodplain Manager, Richard Benton at 954-828-6133 or rbenton@fortlauderdale.gov regarding proposed Finished Floor elevation and fill requirements per City's Code of Ordinances Chapter 14 – Floodplain Management, including Ordinance C-14-26. Provide correspondence and depict information on plans accordingly.
 30. Please note that a min. 5 feet and 10 feet horizontal clearance horizontal separation is required between city utilities infrastructure and proposed small and large trees, respectively (including proposed water and sewer services to the development). Any new trees (located within or adjacent to City Right-of-Way) should be placed with sufficient horizontal and vertical distances (per City,



County, and State guidelines) to / from City's public infrastructure, including stormwater assets, to allow for continued Public Works maintenance without obstruction. If this cannot be accommodated due to field conditions, then the developer shall relocate the existing City's public infrastructure to resolve the conflict(s) and to comply with City's, County's & State's engineering standards/permits/policies. Ensure separation is provided and include a note regarding horizontal clearance requirement on the landscape plans.

31. Evaluate the possibility of utilizing a sustainable stormwater approach with the possibility of low impact (cisterns, pervious pavers, bioswales, raingardens, etc.) uses for landscaping along the streetscape.
32. Please provide an erosion, sedimentation, and stormwater pollution prevention plan (SWPPP) showing the adjacent City's existing stormwater system. A copy of the approved SWPP shall be at the construction site from the date of demolition initiation to the date of final construction activities. CCTV Notes, Pollution Prevention Notes, and Dewatering Notes to be added to the SWPPP can be found on our website.
33. For Engineering General Advisory DRC Information, please visit our website at <https://www.fortlauderdale.gov/home/showdocument?id=30249>
34. Additional comments may be forthcoming at the DRC meeting and once additional/ revised information is provided on plans.



Case Number: R19068

CASE COMMENTS:

Please provide a response to the following:

1. The City has adopted Florida Friendly Landscaping requirements into our ULDR Section 47-21. This basically means that plant material must be grouped together based on watering needs (hydro zone) and turf areas must be limited and/or consolidated to less than 50% of the landscaped area. Plant material species must be minimum 50% Florida Friendly Landscaping. Planting areas are to be irrigated on a separate zone than the turf areas so that once the plants are established, that particular zone can be shut off based on the season. The overall goal is to decrease water use through irrigation. Illustrate hydro zones on planting plan and include calculations in table.
2. The use of structural soil is required in paved sites to provide adequate soil volumes for tree roots under pavements, as per ULDR Section 47-21.13. Structural soil details and specifications can be obtained at <http://www.hort.cornell.edu/uhi/outreach/index.htm#soil> This is to be provided at a minimum of 8' radii of tree trunks, and is to be consistently illustrated and noted on landscape, site and civil plans.

The structural soil drain is required when percolation rates are less than 4" vertical clearance per hour. Provide documentation of report used to prove this calculation. The drain and connections are to be illustrated on civil plans.

1. Demonstrate hashing on landscape, site and civil plans as to the extent of use of the Structural Soil.
 2. Provide Structural Soil Detail and composition.
3. There is a product that the Landscape Department will approve the use of in place of Structural soil. With the Structural soil repositioning of the underground utilities is required. A suspension modular paving system product will provide the required root development area for a healthy and vibrant tree, along with their use it will allow the utilities to be in place and not affect their location in conjunction with the tree's root system. Please look into the use of the Green Blue Urban soil cell, Silva cell or like product for this and all future site developments.

As with the use of Structural soil a detail of the product and indication of the extent of use to be provided of the soil cell pavement support systems product.

4. Provide street trees in the right of way swale area, as per ULDR 47-21.13.B.16. Street trees are to be a minimum of 12 feet tall and provided at a ratio of one street tree per forty feet of street frontage or greater fraction thereof not subtracting ingress and egress dimensions.
 1. Location for street trees is to be between the property line and the street.
 2. Additional over all height may be required for the purpose of providing a canopy of 60% to a canopy clearance of 40% - minimum 8 canopy clearance of 8 feet when in a sight triangle.
5. Sight triangles located at the intersection of a local street or driveway with a right-of-way under County, State or Federal jurisdiction, may be subject to the sight visibility requirements of those jurisdictions, as per ULDR 47-2.2.Q. Illustrate such sight triangles and provide documentation that application for approval has been made for planting in such right-of-way area.



6. Approval from jurisdiction for landscape installation in Right Of Way, preferred prior to final DRC sign off. If jurisdiction approval is obtained after DRC final sign off and the plans require any change, Administrative Review will be required prior to permit review.
7. Section 47-21.9.G. (1,2,3,4) Each tree shall have pervious area surrounding it sufficient to support the species, as determined by the department. The minimum planting area shall be for:
 1. Shade species with a minimum caliper of three (3) inches, two hundred twenty-five (225) square feet with fifteen (15) feet being the smallest dimension.
 - a) Shade trees proposed in under size pervious area – additional conversation required as to the use of structural soil for these areas.
 2. Shade species with a minimum caliper of two (2) inches, ninety (90) square feet with eight (8) feet being the smallest dimension.
 3. Other dicot tree species, sixty-four (64) square feet with eight (8) feet being the smallest dimension.
 - a) Trees proposed within landscape strips between rows of parking stalls have a pervious width of under 8 feet.
 4. Palm types, twenty-five (25) square feet with five (5) feet being the smallest dimension, except Areca, Carpentaria, Cocothrinax, Phychosperma, Rhapsis, and Sabal, sixteen (16) square feet with four (4) feet being the smallest dimension.
 - a) Large canopy palm trees are suggested to be proposed in the landscape strips described in c above, small canopy trees may be utilized in other suitable locations. The Department suggest the use of Royal palms be not entertained due to frond drop and vehicle damage.
8. Within the parking rows of more then 10 stalls the city prefers additional tree islands be proposed along with shade trees. Please propose additional tree islands to help mitigate the solar heat island effect from the open paved areas.
9. Utilities and site amenities such as walkways, flagpoles, transformers, fire hydrants, sewer and water supply lines, trash enclosures, and similar items located on the site shall not be placed adjacent to, in, or under required tree planting areas, as per ULDR Section 47-21.12. Confirm with civil, site and life safety plans that utilities and site amenities are not causing conflicts with proposed landscaping. Where conflicts exist, shift the utility and/or site amenities.
10. Light fixtures with an overall height of more than ten feet shall be located a minimum of 15 feet aware from shade trees, as per ULDR Section 47-21.12.
11. For specimen size trees, provide ISA Certified Arborist report for specimen trees, as per ULDR 47-21.15. This report is to be on ISA Certified Arborist business letterhead with contact information and ISA Certification number clearly stated. This report would include tree survey with numbered trees, a corresponding table which includes tree number, botanical name and common name, trunk diameter at breast height, clear trunk for palms, condition percentage, etc.; and a written assessment of existing tree characteristics. This information is required to calculate equivalent value mitigation.
12. Please have a certified ISA Arborist provide the information as to the existing trees including the condition ratings that will be required for mitigation purposes.



GENERAL COMMENTS

The following comments are for informational purposes.

Please consider the following prior to submittal for Building Permit:

1. A separate sub-permit application for Tree Removal, Relocation, and General Landscaping for site is required at time of master permit submittal. These are Landscape and Tree permit application documents different than the Broward County standard applications. Please not at this time of DRC submittal.
2. Proposed landscaping work in the City's right of way requires engineering permit and approval (GLandscape permit). This approval requires documents to be submitted for Engineering review. Note that Landscape will not approve permit review without these Engineering documents being submitted.
3. Provide separate Plumbing sub permit application for irrigation. Irrigation plans are required at time of Building permit submittal. Plans are to be in compliance with ULDR 47-21.6.A.11 and 47-21.10. Note that planting areas are to be irrigated on a separate zone than the turf areas so that once the plants are established, that particular zone can be shut off based on the season. The overall goal is to decrease water use through irrigation. Plant material must be grouped together based on watering needs (hydrozone) and turf areas must be limited and/or consolidated to less than 50% of the landscaped area. Illustrate hydrozones on planting plan, and include calculations in table.



Case Number: R19068

CASE COMMENTS:

Please provide a response to the following:

1. All exterior glazing should be impact resistant.
2. Exterior entry / exit door should be solid, impact resistant or metal.
3. Exterior entry and exit door should be equipped with a secondary locking system like door pins, deadbolt or burglary prevention hardware.
4. The businesses should be equipped with a CCTV system that would capture an identifiable image of an individual on site. The system should be capable of covering entry and exit points, parking areas, bike rack, elevator lobby and any other sensitive area of concern.
5. The businesses should be equipped with an intrusion alarm and a silent "Panic" alarm for police response. The alarm system should have battery back-up and or cellular back-up features.
6. Office doors should be equipped so that they may be locked from the inside to be used as possible "Safe Rooms" during an active threat event like an active killer incident.
7. All ground level stairs leading to the exterior should be egress only and or access controlled.
8. Site lighting and landscape should follow C.P.T.E.D. standards.

GENERAL COMMENTS

It is highly recommended that the managing company make arrangements for private security during construction.

Please submit responses in writing prior to DRC sign off.



Case Number: R19068

CASE COMMENTS:

Please provide a response to the following:

1. Garbage, Recycling and Bulk Trash shall be provided.
2. Recycling reduces the amount of trash your business creates and it is the best way to reduce monthly waste disposal costs and improve your company's bottom line.
3. Solid Waste Services shall be provided by a Private Contractor licensed by the City.
4. Service Days shall be: No restriction for Commercial collection. Service may not occur earlier than 7:00 am or later than 10:00 pm within 250 feet of residential.
5. Solid Waste Collection shall be on private property container shall not be placed, stored or block the public street to perform service (large multifamily and commercial parcels).
6. Draw trash area on site plan.
7. Containers: must comply with 47-19.4
8. Dumpster enclosure: concrete pad, decorative block wall, gates hung independently, protective bollards, secondary pedestrian side entry, high strengthen apron and driveway approach, night light, hot water, hose bib, drain, low circulating ventilation for dampness, weep holes, landscaping, smooth surface walkway to accommodate wheeled containers.
9. Provide on the site plan a garbage truck turning radii for City review. Indicate how truck will circulate within property.
10. Submit a Solid Waste Management Plan on your letterhead containing name of project, address, DRC case number, number of units if applicable, and indicate whether it is Pre or Final DRC.
 - o This letter is to be approved and signed off by the Sustainability Division, and should be attached to your drawings. Please email an electronic copy to smccutcheon@fortlauderdale.gov. Letter should include an analysis of the expected amounts of solid waste and recyclables that will be generated (if different from current capacity), and container requirements to meet proposed capacity.
 - o Community Inspections will reference this Solid Waste Plan for sanitation compliance issues at this location.

GENERAL COMMENTS

The following comments are for informational purposes.

Please consider the following prior to submittal for Final DRC:

1. None



Case Number: R19068

CASE COMMENTS:

1. Submit a traffic impact statement and coordinate with the Transportation and Mobility Department regarding traffic calming and a traffic impact study if needed. If a traffic study is needed Pursuant to 47-25.2.M.4. Applicant must fund City's review by consultant and pay a \$4,000 deposit prior to scheduling a methodology meeting after which the study will be prepared, transmitted and reviewed by the City's consultant. Staff and consultant's review concerns shall be adequately resolved prior to gaining authorization for either the Planning & Zoning Board or City Commission hearings. Take into consideration that the review of this study, once submitted, will take about 4-6 weeks once all documents are received.
2. Create a cross access agreement with the property to the east of this site.
3. Back of sidewalk should begin on the ultimate right of way/easement dedication line.
4. All loading and unloading must be contained on site including postal delivery services and rideshare pick up and drop off.
5. Are gates being proposed at the driveways? If so show where on the site plan.
6. Show inbound and outbound stacking requirements from the property line to the first conflict point according to sec 47-20.5 General design of parking facilities for each driveway.
7. Per ULDR Section 47-2.2.Q, show and label sight triangles as appropriate for safe and adequate access of drivers and pedestrians, on the Site Plan, Landscape Plans, and Civil Plans: intersections of driveways with streets and alleys (10' measured from intersection point of pavement edges), alleys with alleys (15' measured from intersection point of extended property lines), alleys with streets (15' measured from intersection point of extended property lines), and streets with streets (25' measured from intersection point of extended property lines). The request for reduction of sight triangle dimensions is subject to review by the City Engineer on a case-by-case basis. Per ULDR Section 47-19.1.E, no accessory use or structure shall be permitted within a sight triangle except as provided in ULDR Section 47-35.
8. Ensure all access points, sidewalks, walkways, and curb cuts are unobstructed and ADA accessible with appropriate slopes and detectible warning devices and indicate on the site plan.
9. Additional comments may be provided upon further review.
10. Signature required.

GENERAL COMMENTS:

Please address comments below where applicable.

1. Contact Benjamin Restrepo at 954-828-5216 or brestrepo@fortlauderdale.gov to set up an appointment for final plan approval.



2. The City's Transportation & Mobility Department encourages the use of sustainable materials such as permeable pavement and electric car charge stations and installation of multimodal facilities such as bicycle pump stations and bike lockers.
3. Please note that any work within the City's right-of-way will require an MOT approved by Transportation and Mobility and Engineering for permitting. Any full closures of roadways, alleys, or sidewalks that are over 72 hours will require a Revocable License Agreement (RLA) with the City of Fort Lauderdale.



Case Number: R19068

CASE COMMENTS:

Please provide a response to the following:

1. The site is designated Employment Center on the City's Future Land Use Map. The proposed use is permitted in this designation. This is not a determination on consistency with Comprehensive Plan Goals, Objectives and Policies.
2. A plat application (PL19004) for the proposed location is currently in review. Ensure that proposed project is consistent with the proposed plat. Pursuant to Unified Land Development Regulations (ULDR) Section 47-24.5.A.2, No building permit shall be issued nor shall a certificate of occupancy be issued for the construction of a principal building on a parcel of land unless a plat including the parcel or parcels of land has been recorded in the public records of Broward County.
3. The site is located in the General Aviation Airport (GAA) zoning district. Coordinate with the Airport Representative on any impacts the proposed development would have on airport facilities, verify FAA requirements and obtain signature during the Final DRC. For more information, please contact Rufus James at e-mail RJames@fortlauderdale.gov.
4. Indicate the project's compliance with the following Unified Land Development Regulations (ULDR) sections by providing a point-by-point narrative response, on letterhead, with date and author indicated.
 - a. Section 47-25.2, Adequacy Requirements
5. Pursuant to ULDR Section 47-21.21.A Height. No building or structure shall exceed the height limits specified by the Federal Aviation Agency Regulation No. FAR Part 77. Please provide documentation that the building does not exceed the height limits specified by the FAA.
6. Provide documentation (such as a cross access agreement or easement) from the adjacent property owner that the proposed development may utilize their curb cut access.
7. Provide the following changes on site plan:
 - a. Pursuant to the Technical Specifications for Plan Submittal enlarge the site plan to take up entire sheet and scale accordingly;
 - b. Move all details (i.e. fire lane striping detail, fire lane sign detail, etc.) to a separate sheet;
 - c. Provide additional landscape area by reducing the number of parking spaces on the site; and,
 - d. Label all elements on the site plan such as the seating/wall feature adjacent to the handicap spaces and sidewalk leading to public sidewalk along West Cypress Creek Road.
8. Provide the following changes on elevations:
 - a. Provide building elevations in color; and,
 - b. Ensure rendering depicted matches the site elevations.
9. Provide roof plan for all structures indicating the location of all mechanical equipment. This plan shall include spot elevations of the parapet wall and roof as well as mechanical equipment to verify adequate screening and to illustrate how equipment will be screened or shielded from view. In addition, indicate all mechanical equipment within the subject site on the site plan and elevations where applicable.



10. It is recommended the following pedestrian and bicycle-related comments be addressed:
 - a. Label all proposed pedestrian access/circulation areas: sidewalks, paths, crosswalks etc. (including width) to/from and within the site;
 - b. Provide bicycle parking in visible, well-lit areas as close as possible to pedestrian entryways/doors. In addition, where possible, locate bicycle parking facilities in an area that is sheltered/covered; and,
 - c. Please email Benjamin Restrepo at brestrepo@fortlauderdale.gov for more information on bicycle parking standards and to obtain a copy of the Association of Pedestrian and Bicycle Professionals [APBP] Bicycle Parking Guidelines and Broward County End-of-Trip Bicycle Facility Guide.

11. Pursuant to Section 47-22.4.C.8 provide a master sign plan detailing the following:
 - a. Location and orientation of all proposed signage;
 - b. Dimensions of each proposed sign (height, width, depth, etc.);
 - c. Proposed sign copy; and,
 - d. Proposed color and materials.

Please note that in the GAA zoning district there are specific sign regulations per Section 47-14.30. Minimum design standards and any proposed signs will require a separate permit application.

12. The City's Vision is to support sustainable infrastructure. Consider employing green building practices throughout the project including, but not limited to charging stations, tankless water heaters, rain collection systems, pervious pavers, bio-swales, Florida Friendly™ plant materials, solar panels and green roofs.

GENERAL COMMENTS:

The following comments are for informational purposes.

Please consider the following prior to submittal for Final Development Review Committee (DRC):

13. Please be advised that pursuant to State Statute, Section 166.033, development permits which require a quasi-judicial or public hearing decision, must be completed within 180 days (April 5, 2020), unless an extension of time is mutually agreed upon between the City and the applicant.

14. All construction activity must comply with Code of Ordinance, Section 24-11, Construction sites. Contact Joe Pasquariello, Structural Plans Examiner (954-828-5419) to obtain his signature on the final Development Review Committee plans.

15. For additional information regarding incorporation of wireless capabilities into the project in initial planning stages, please contact the applicable utility provider.

16. If a temporary construction/sales trailer is needed for this project, provide the details and location of the trailer on a separate site plan, to avoid additional review in the future. Verify details and location with the Building Representative.

17. An additional follow-up coordination meeting may be required to review project changes necessitated by the Development Review Committee comments. Prior to routing your plans for Final Development Review Committee sign-off, please schedule an appointment with the project planner, Nicholas Kalargyros via email (NicholasK@fortlauderdale.gov) to review project revisions and/or to obtain a signature routing stamp.

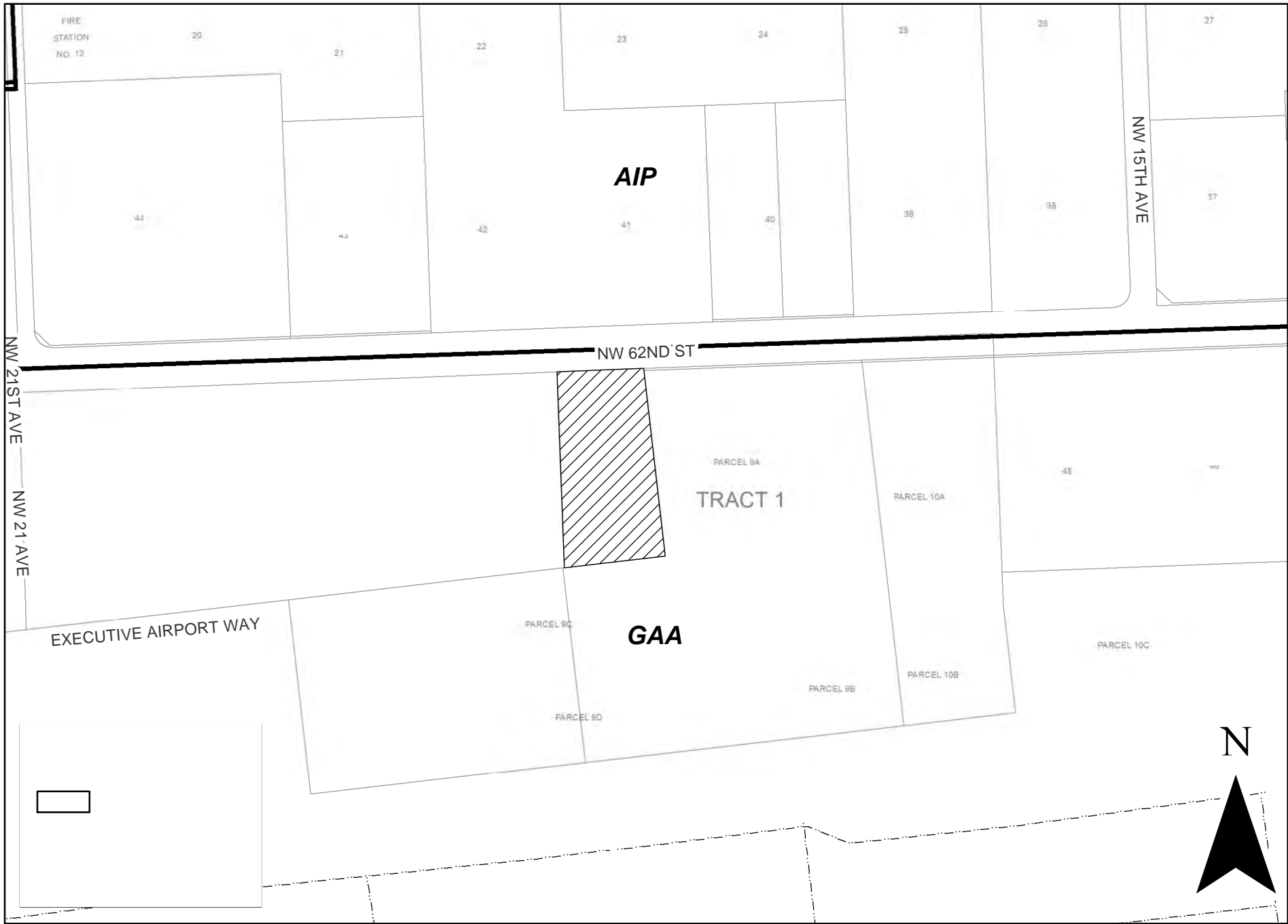

R19068

