



## DEVELOPMENT REVIEW COMMITTEE (DRC) COMMENT REPORT

**MEETING DATE:** October 22, 2019

**APPLICANT:** San Vicente Architect LLC. - Maria Ximena

**PROJECT NAME:** View Pointe Hendricks

**CASE NUMBER:** R19069

**REQUEST:** Site Plan Level III Review: Waterway Use and Yard Modification for 6 Multifamily Residential Units

**LOCATION:** 534 Hendricks Isle

**ZONING:** Residential Multifamily Mid Rise/Medium High Density (RMM-25)

**LAND USE:** Medium-High Density Residential

**CASE PLANNER:** Yvonne Redding



**Case Number: R19069**

**CASE COMMENTS:**

- 1) Provide the FBC Building Type ( Chapter 6) Designation on the plans.
- 2) Designate Sprinkler Provisions for the Building.
- 3) Designate Fair Housing Provisions FBC Accessibility.
- 4) Provide Designated Compliance to Parking Garage Open Air Parking per FBC 406.5

**GENERAL COMMENTS**

The following comments are for informational purposes.

Please consider the following prior to submittal for Final DRC:

1. The Florida Building Code shall apply to the construction, alteration, movement, enlargement, replacement, repair, equipment, use and occupancy, location, maintenance, removal and demolition of every building or structure or any appurtenances connected or attached to such buildings or structures.
2. All projects must consider safeguards during the construction process. Florida Building Code Chapter 33 delineates various safeguards that may apply during the construction phase. All structures associated with the protection of pedestrians will require a separate permit. A licensed professional must sign and seal the plans and specifications.
3. The City of Fort Lauderdale is a participating municipality in the National Flood Insurance Program (NFIP). The requirements specific to the City of Fort Lauderdale can be found in

**Chapter 14 - FLOODPLAIN MANAGEMENT of the Code of Ordinances** and accessed at;

a. [https://www.municode.com/library/fl/fort\\_lauderdale/codes/code\\_of\\_ordinances?nodeId=COOR\\_CH14FLMA](https://www.municode.com/library/fl/fort_lauderdale/codes/code_of_ordinances?nodeId=COOR_CH14FLMA)

**Please consider the following prior to submittal for Building Permit:**

1. On January 1<sup>st</sup>, 2018 the 6<sup>th</sup> Edition of the Florida Building Code was adopted. All work described in Section 101.2, of the Broward County Administrative portion of the Florida Building Code, will govern the administration and enforcement of the proposed work. Each building and or structure will require a separate permit. The following websites will assist in the design considerations:
  - a. <http://www.fortlauderdale.gov/departments/sustainable-development/building-services>
  - b. [https://floridabuilding.org/bc/bc\\_default.aspx](https://floridabuilding.org/bc/bc_default.aspx)
  - c. <http://www.broward.org/codeappeals/pages/default.aspx>

**General Guidelines Checklist is available upon request.**



Case Number: R19069

**CASE COMMENTS:**

**Prior to Planning and Zoning Board Meeting or Final DRC sign-off, please provide updated plans and written response to the following review comments:**

1. Meet the City's Adequacy requirements to services provided to the public (fire service, water, wastewater, stormwater, transportation, etc.), per ULDR Section 47-25.2 of the City's Code of Ordinances. Assess potential demands and impacts on City services and prepare a design for each that utilizes existing water, wastewater, stormwater, and transportation infrastructure to adequately serve this project. If the adequate infrastructure is not available, prepare a design that extends/expands the connection to the nearest City system to adequately serve this development.
  - a. Prepare service demand calculations for water & wastewater services and obtain a letter of service availability from the City's Public Works – Engineering Department. Submit water and wastewater capacity availability request form and documents/ plans at <https://www.fortlauderdale.gov/departments/sustainable-development/building-services/engineering-forms-and-info/development-review-committee-service-demand-calculations-for-water-sewer>

2. Provide a current signed and sealed boundary and topographic survey showing all above ground improvements, utilities, rights of way dimensions and all easements. This survey shall be based on a Standard Title Commitment issued by a title insurer licensed to do business in Florida or an Opinion of Title issued by an attorney admitted to the Florida Bar. The title commitment or Opinion of Title must have an effective date no more than thirty days prior to the date of submittal of the survey and must be certified to the City of Fort Lauderdale. If any encumbrances are found in the property, provide a copy of the recorded documents accordingly (i.e. easements, dedications, agreements, vacations, etc.).

Property lines, NVAL, Right-of-Way, watercourses, easements, structures, and roadway shall be clearly shown, labeled and dimensioned. Provide spot elevations on site, at property corners, along property lines (50' min. interval), existing roadway crowns and pavement edges adjacent to property as appropriate. Elevations shall be referenced to the North American Vertical Datum of 1988 (NAVD 88). Sufficient information must be provided on survey in order to staff to determine proposed development improvements are being coordinated with adjacent right of way and properties, to include existing sidewalk to the west.

3. Provide disposition of existing utilities within the adjacent right of way that maybe impacted by the proposed development. Label information on plans (i.e. utility to remain/ be relocated/ removed). Provide correspondence from utility owner (as applicable) and depict any additional requirements they may have on plan (i.e. easements). Utilities include but are not limited to above and underground water, sewer, drainage, electrical, communications, light/power poles, down guys, fire hydrants, manholes, etc.
4. Spot elevations/grades shown in proposed development plans shall be per North American Vertical Datum of 1988 (NAVD 88), instead of National Geodetic Vertical Datum of 1929 (NGVD 29) as referenced on sheet C-1.
5. Location of existing public sidewalk termination near the northwest corner of the site is to be verify and show on survey and plans. Proposed back of public sidewalk is to follow ROW line with zero horizontal offset. Only horizontal offset necessary to harmonize pedestrian path transition between proposed and existing will be acceptable (if required).



6. Be advise back of proposed public sidewalk elevation must closely match corresponding crown of road elevation.
7. Within adjacent City Right-of-Way, staging/storage will not be allowed, construction fence shall not encroach within intersection corner sight triangles, construction fence gates shall not swing into the public Right-of-Way, and any loaded Jib Crane radius shall not extend beyond private property boundaries. Any City Right-of-Way closure over 72 hours requires a Revocable License Agreement, processed by Property Right-Of-Way Committee (DRC) and approved by the City's Commission, prior to Right-of-Way permit issuance by the Department of Sustainable Development for Maintenance of Traffic.

Prior to submitting Administrative Review (i.e. DRC Level I) application to request Revocable License Agreement, please contact Dennis Girisgen at 954-828-5123 or [dgrisgen@fortlauderdale.gov](mailto:dgrisgen@fortlauderdale.gov) to discuss proposed scope of closure within City Right-of-Way.

8. Discuss if pedestrian lighting is proposed; if not, discuss the possibility of the addition of pedestrian lighting along City Right-of-Way, which requires perpetual maintenance by the Applicant via a Maintenance Agreement executed with the City. Please contact the Case Planner for details to match the area.
9. Driveway shall at a minimum be surfaced with a hard, dust free material such as concrete, asphalt or pavers, turf block will not be acceptable. Be advise paving material located within the right-of-way shall match the paving material used to construct the driveway and/or parking area of the private property.
10. Please email [CRBARRETT@FORTLAUDERDALE.GOV](mailto:CRBARRETT@FORTLAUDERDALE.GOV) to obtain copies of the City utility maps as applicable to the project location and show existing City utilities and easements (water, sewer, forcemain, and stormwater utilities) in proposed engineering plans (utility demolition, stormwater pollution prevention plan (SWPPP), and civil plans).
11. Label proposed water service connections and material on conceptual Water and Sewer Plan. Fire Service Line must be a dedicated line with no additional services branching off of it unless a 'master' meter is placed on-site within a 10-ft x 15-ft utility easement. Sanitary sewer clean out must be provided 2.5-ft into Right-of-Way at property line per City standards.
12. Conceptual Paving, Grading, and Drainage:
  - a. Provide sufficient existing and proposed grades and information on conceptual Paving, Grading, and Drainage Plan and details to demonstrate how stormwater runoff will remain onsite (include typical cross-sections along all property lines as appropriate) and how the proposed project improvements (i.e. on-street parking, sidewalks, etc.) will not adversely impact the adjacent Right-of-Way, properties and waterways. Show location of building roof drains, and their proposed connection(s) to the on-site drainage system. Label existing City storm manholes/inlets using the labels provided in the figure at the end of these notes.
  - b. Drainage mitigation shall be required for any impacts within the adjacent City Right-of-Way such as increased runoff or reduction of existing storage/treatment due to proposed improvements, in accordance with the City of Fort Lauderdale Comprehensive Plan (Ordinance C-15-08), Objective 4.1 under Infrastructure Elements. Engineer of Record (EOR) shall evaluate the adjacent City roadway system capacity and demonstrate that the proposed improvements will not negatively impact the City's existing drainage system and provide recommendations in compliance with the City's Comprehensive Plan (i.e. meets or exceeds the 10-year/1-day storm event drainage criteria). Applicant shall be responsible for maintenance of these proposed storm drain infrastructure improvements located within City Right-of-Way during a 1-year warranty period, until accepted by the City's Public Works



Department. (coordinate as appropriate with the respective FDOT and BCHCED agencies for mitigation of additional runoff within those jurisdictions).

- c. Please note that private stormwater infrastructure (drainage pipes, wells, or basins,), Trees, or Permanent Structures (fences, walls, etc) are not permitted in City Right of Way or City drainage easements. Please remove any proposed stormwater systems, trees, or permanent structures that are not in compliance with this requirement or provide appropriate documentation of City Rights-of-Way or easement vacated to allow the construction of private underground utilities.
  - d. Additional coordination maybe required for projects located within Victoria Park, Edgewood, Progresso Village, River Oaks, Durrs, Historical Dorsey-Riverbend and South East Isles neighborhoods which are part of a City Drainage Master Plan. Please contact Rares Petrica (Public Works) at 954-828-6720 or [rpetrica@fortlauderdale.gov](mailto:rpetrica@fortlauderdale.gov).
13. Provide storm runoff calculations, signed and sealed by a Florida registered professional engineer, which demonstrate how minimum criteria regarding adjacent street crown, water quality and finished floor elevations are met, as well as how the 25-year, 3-day storm event is maintained on site with zero discharge to Right-of-Way and adjacent properties (Pre vs. Post analysis will only be allowed in areas that are not flood-prone). Please also comply with the City of Fort Lauderdale Comprehensive Plan (Ordinance C-08-18), Objective 4.1 under Infrastructure Elements, and be advised that effective 7/1/2017, all projects must comply with the Broward County 'Future Conditions Average Wet Season Groundwater Level' map.
  14. If dewatering activities are anticipated, a notarized City dewatering affidavit shall be filed at City's building department when submitting a demolition or foundation permit along with any applicable dewatering permit form regulatory agencies such as the South Florida Water Management District or Broward County Department of Environmental Protection.
  15. Show and label all existing and proposed utilities (utility type, material and size) on civil and landscaping plans for potential conflict. A min. 5 feet and 10 feet horizontal clearance horizontal separation is required between city utilities infrastructure and proposed small and large trees, respectively (including proposed water and sewer services to the development). Any new trees (located within or adjacent to City Right-of-Way) should be placed with sufficient horizontal and vertical distances (per City, County, and State guidelines) to / from City's public infrastructure, including stormwater assets, to allow for continued Public Works maintenance without obstruction. If this cannot be accommodated due to field conditions, then the developer shall relocate the existing City's public infrastructure to resolve the conflict(s) and to comply with City's, County's & State's engineering standards/permits/policies. Ensure separation is provided and include a note regarding horizontal clearance requirement on the landscape plans.
  16. Discuss how surface runoff from the proposed development (between building and Right-of-Way boundaries) will be mitigated such that it won't be conveyed into the adjacent existing public storm drain infrastructure or waterways, and whether additional infrastructure will be required within City Right-of-Way Show location of building roof drains, and their proposed connection(s) to the on-site drainage system.
  17. Evaluate the possibility of utilizing a sustainable stormwater approach with the possibility of low impact (cisterns, pervious pavers, bioswales, raingardens, etc.) uses for landscaping along the streetscape.
  18. For Engineering General Advisory DRC Information, please visit our website at: <https://www.fortlauderdale.gov/home/showdocument?id=30249>





19. Additional comments may be forthcoming at the DRC meeting and once additional/ revised information is provided on plans.

**Existing Stormwater Asset Map possibly affected by the Proposed Development**





Case Number: R19069

**CASE COMMENTS:**

Please provide a response to the following:

1. The City has adopted Florida Friendly Landscaping requirements into our ULDR Section 47-21. This basically means that plant material must be grouped together based on watering needs (hydro zone) and turf areas must be limited and/or consolidated to less than 50% of the landscaped area. Plant material species must be minimum 50% Florida Friendly Landscaping. Planting areas are to be irrigated on a separate zone than the turf areas so that once the plants are established, that particular zone can be shut off based on the season. The overall goal is to decrease water use through irrigation. Illustrate hydro zones on planting plan, and include calculations in table.
2. The use of structural soil is required in paved sites to provide adequate soil volumes for tree roots under pavements, as per ULDR Section 47-21.13. Structural soil details and specifications can be obtained at <http://www.hort.cornell.edu/uhi/outreach/index.htm#soil> This is to be provided at a minimum of 8' radii of tree trunks, and is to be consistently illustrated and noted on landscape, site and civil plans.

The structural soil drain is required when percolation rates are less than 4" vertical clearance per hour. Provide documentation of report used to prove this calculation. The drain and connections are to be illustrated on civil plans.

- a. Demonstrate hashing on landscape, site and civil plans as to the extent of use of the Structural Soil.
- b. Provide Structural Soil Detail and composition.

There is a product that the Landscape Department will approve the use of in place of Structural soil. With the Structural soil repositioning of the underground utilities is required. A suspension modular paving system product will provide the required root development area for a healthy and vibrant tree, along with their use it will allow the utilities to be in place and not affect their location in conjunction with the tree's root system. Please look into the use of the Green Blue Urban soil cell, Silva cell or like product for this and all future site developments.

As with the use of Structural soil a detail of the product and indication of the extent of use to be provided of the soil cell pavement support systems product.

3. A minimum separation of 6 feet is required between the tree trunk and travel lane when curb and gutter DO NOT exist, and a minimum separation of 4 feet is required between the tree trunk and travel lane when curb and gutter DO exist. Illustrate this clearance.
4. The zoning of this property requires a minimum of 35 percent of the gross lot square footage shall be in landscaping, maintained by an irrigation system, as per ULDR 47-21.13.A&B. The minimum twenty percent VUA required landscaping may be used toward fulfilling the gross thirty-five percent minimum. Sandy beach on oceanfront parcels of land may be included in the gross minimum, but do not need to be planted or irrigated.
  - a. With a gross site area of 10,889 - 35 percent is to be in landscape at grade. The minimum amount for this site is 3,811.15 square feet. Landscape plans indicate 2,977 square feet of net lot landscape area while the site data sheet indicates 4,596 square feet of landscape area.



- b. Please provide an overlay sheet demonstrating measured areas with their combined total area calculation in square feet and percentage form.
  - c. Please provide the green area of the grass pavers in contrast to its non-green area.
5. Queen Sago due to the pest problems and the need for consistent use of pesticides is requested not to be proposed on city property. An alternative to Queen Sago would be chestnut dioon or the *Ceratozamia kuesteriana*.
6. Please show underground utilities on Landscape plan.
- a. Existing water line appears to run through the swale area. For large shade trees such as Live Oak there is a required separation from tree to utility, 10 feet is preferred while 7 feet is useful when root barriers are installed 1 foot from edge of utility. Palm trees such as the Wind Mill palm may be installed 3 feet from the utility with the use of root barriers 1 foot from the utility. Being that the Wind Mill palm only has a canopy spread of 8-10 feet. Please investigate the Wind Mill palms being proposed in multiple clusters, 3 canes each at staggered heights, from the street light to where the sidewalk connects to the street.
7. No hedge materials may exceed 30 inches in height within 10 feet of the wet face of the sea wall. Trees and palm trees may be installed within this 10 feet area only if they have a canopy clearance of 8 feet.
- a. The Lucky nut tree and the Archontophoenix palm appear to be in conflict with this clearance requirement.
  - b. Please show on plan that the Archontophoenix palm has 4 feet from the edge of the seawall and the Lucky Nut has a minimum of 5' from the edge of the seawall.
  - c. Please show the existing Coconut palms on the Landscape plan.
8. Please have ISA Arborist who provided the mitigation calculations provide the information supporting the health condition ratings that are required for mitigation purposes.

### **GENERAL COMMENTS**

The following comments are for informational purposes.

Please consider the following prior to submittal for Building Permit:

1. A separate sub-permit application for Tree Removal, Relocation, and General Landscaping for site is required at time of master permit submittal. These are Landscape and Tree permit application documents different than the Broward County standard applications. Please not at this time of DRC submittal.
2. Proposed landscaping work in the City's right of way requires engineering permit and approval (GLandscape permit). This approval requires documents to be submitted for Engineering review. Note that Landscape will not approve permit review without these Engineering documents being submitted.
3. Provide separate Plumbing sub permit application for irrigation. Irrigation plans are required at time of Building permit submittal. Plans are to be in compliance with ULDR 47-21.6.A.11 and 47-21.10. Note that planting areas are to be irrigated on a separate zone than the turf areas so that once the plants are established, that particular zone can be shut off based on the season. The overall goal is to decrease water use through irrigation. Plant material must be grouped together based on watering





needs (hydrozone) and turf areas must be limited and/or consolidated to less than 50% of the landscaped area. Illustrate hydrozones on planting plan and include calculations in table.



**Case Number:** R19069

**CASE COMMENTS:**

Please provide a response to the following:

1. Entry doors should be solid, impact resistant or metal.
2. Residential units entry doors should be equipped with a quality secondary deadbolt locking system and have a 180 degree peephole or view port for security.
3. Sliding glass doors and sliding glass windows should be equipped with burglary deterrent features such as track blocks, door pins or deadbolts. The door should also provide features to prevent the doors from being lifted off track.
4. All glazing should be impact resistant.
5. Units should be pre-wired for an alarm system.
6. Ground level stair doors should be egress only or access controlled. Stair doors into floors should be access controlled.
7. The site should be equipped with a comprehensive CCTV system that is capable of retrieving an identifiable image of an individual on site. The system should cover all entry exit points, parking area, common areas, storage areas and any other area of concern on site.
8. The parking area resident's levels should be equipped with vehicular access control systems to prevent unauthorized intrusion or access to resident's vehicles.
9. The pool area should be equipped with a child proof access control feature to prevent unsupervised children access to the pool.
10. Lighting and landscaping should follow C.P.T.E.D. guidelines.

**GENERAL COMMENTS**

It is highly recommended that the managing company make arrangements for private security during construction.

Please submit responses in writing prior to DRC sign off.



Case Number: R19069

**CASE COMMENTS:**

Please provide a response to the following:

1. Garbage, Recycling and Bulk Trash shall be provided.
2. Recycling reduces the amount of trash your business creates and it is the best way to reduce monthly waste disposal costs and improve your company's bottom line.
3. Solid Waste Services shall be provided by a Private Contractor licensed by the City.
4. Service Days shall be: No restriction for Commercial collection. Service may not occur earlier than 7:00 am or later than 10:00 pm within 250 feet of residential.
5. Solid Waste Collection shall be on private property container shall not be placed, stored or block the public street to perform service (large multifamily and commercial parcels).
6. Containers: must comply with 47-19.4
7. Draw equipment on plan to show it will fit in trash room.
8. Solid Waste transport to trash rooms or to primary waste container shall be performed inside building using interior service corridor (Retail, Office, Condo, Hotel).
9. Provide letter from chute company indicating make and model of proposed equipment and that it will meet the capacity needs of building.
10. Trash Room services will be handled by private collector, or Trash Room services will be done by on site personnel, or Trash Room services will be done by custodial staff.
11. Provide on the site plan a garbage truck turning radii for City review. Indicate how truck will circulate within property.
12. Submit a Solid Waste Management Plan on your letterhead containing name of project, address, DRC case number, number of units if applicable, and indicate whether it is Pre or Final DRC.
  - o This letter is to be approved and signed off by the Sustainability Division, and should be attached to your drawings. Please email an electronic copy to [smccutcheon@fortlauderdale.gov](mailto:smccutcheon@fortlauderdale.gov). Letter should include an analysis of the expected amounts of solid waste and recyclables that will be generated (if different from current capacity), and container requirements to meet proposed capacity.
  - o Community Inspections will reference this Solid Waste Plan for sanitation compliance issues at this location.

**GENERAL COMMENTS**

The following comments are for informational purposes.

Please consider the following prior to submittal for Final DRC:

1. Draw equipment on the plans.



Case Number: R19069

**CASE COMMENTS:**

1. Continue the sidewalk up to the waterway.
2. Back of sidewalk should begin on the ultimate right of way/easement dedication line.
3. All loading and unloading must be contained on site including postal delivery services and rideshare pick up and drop off.
4. Please show inbound and outbound stacking requirements from the property line to the first conflict point according to sec 47-20.5 General design of parking facilities for each driveway. Gate house and or gated entry ways require additional stacking and vehicular reservoir spaces.
5. If stacking requirement cannot be met, submit a signed and sealed traffic impact statement justifying why the stacking requirement should be reduced.
6. Per ULDR Section 47-2.2.Q, show and label sight triangles as appropriate for safe and adequate access of drivers and pedestrians, on the Site Plan, Landscape Plans, and Civil Plans: intersections of driveways with streets and alleys (10' measured from intersection point of pavement edges), alleys with alleys (15' measured from intersection point of extended property lines), alleys with streets (15' measured from intersection point of extended property lines), and streets with streets (25' measured from intersection point of extended property lines). The request for reduction of sight triangle dimensions is subject to review by the City Engineer on a case-by-case basis. Per ULDR Section 47-19.1.E, no accessory use or structure shall be permitted within a sight triangle except as provided in ULDR Section 47-35.
7. Dimension parking stalls and drive aisles, and ensure the stalls and aisles meet our city codes geometrics standards.
8. Bicycle parking is strongly encouraged. Consult the APBP Bicycle Parking Guidelines, city of Fort Lauderdale Parking Standards and Broward County End-of-Trip Bicycle Facilities Guide. Provide the minimum long term and short term bicycle parking based on requirements in the guide and include total counts on the site plan data sheet.
9. Ensure all access points, sidewalks, walkways, and curb cuts are unobstructed and ADA accessible with appropriate slopes and detectible warning devices and indicate on the site plan.
10. Additional comments may be provided upon further review.
11. Signature required.

**GENERAL COMMENTS:**

Please address comments below where applicable.

1. Contact Benjamin Restrepo at 954-828-5216 or brestrepo@fortlauderdale.gov to set up an appointment for final plan approval.



2. The City's Transportation & Mobility Department encourages the use of sustainable materials such as permeable pavement and electric car charge stations and installation of multimodal facilities such as bicycle pump stations and bike lockers.
3. Please note that any work within the City's right-of-way will require an MOT approved by Transportation and Mobility and Engineering for permitting. Any full closures of roadways, alleys, or sidewalks that are over 72 hours will require a Revocable License Agreement (RLA) with the City of Fort Lauderdale.





Case Number: R19069

**CASE COMMENTS:**

Please provide a response to the following:

- 1) The applicant is strongly encouraged to contact neighbors adjacent to, as well as condominium and neighborhood associations located within three hundred feet (300') of the development site, to advise of this proposal (a listing of officially-recognized associations is provided on the City's website: [www.fortlauderdale.gov/neighbors/civic-associations](http://www.fortlauderdale.gov/neighbors/civic-associations) and a map of neighborhood associations may be found at: <http://gis.fortlauderdale.gov>). Please provide acknowledgement and/or documentation of any public outreach.
- 2) The site is designated Medium-High Residential on the City's Future Land Use Map. The proposed use is permitted in this designation. This is not a determination on consistency with Comprehensive Plan Goals, Objectives and Policies.
- 3) The proposed project requires review and approval by the Planning and Zoning Board. A separate application and fee are required for PZ Board submittal, and the applicant is responsible for all public notice requirements (Sec. 47-27). In addition, the development permit shall not take effect nor shall a building permit be issued until thirty (30) days after approval, and then only if no motion is adopted by the City Commission seeking to review the application.

This application is subject to Unified Land Development Regulations (ULDR) Section 47-27.4.A.2.c, Public Participation requirements. Prior to submittal of the application to the Planning and Zoning Board (PZB), a notice from the applicant via letter or e-mail shall be provided to official city-recognized civic organization(s) within 300 feet of the proposed project, notifying of the date, time and place of applicant's project presentation meeting to take place prior to the PZB meeting.

The applicant shall then conduct a public participation meeting(s) a minimum of 30 days prior to the PZB. This date and location of the meeting is at the discretion of the applicant. Once the meeting(s) is/are conducted, the applicant shall provide a written report letter to the Department of Sustainable Development, with copy to subject association(s), documenting the date(s), time(s), location(s), number of participants, presentation material and general summary of the discussion after a public participation meeting(s). The report letter shall summarize the substance of comments expressed during the process and shall be made a part of the administrative case file record.

The applicant shall, 10 days prior to the PZB, execute and submit to the department an affidavit of proof of public notice according to this section. If the applicant fails to submit the affidavit, the public hearing will be postponed until the next available hearing date after the affidavit has been supplied.

- 4) Verify that copy of plat is the most current recorded plat, including notes and amendments, for the proposed site. Provide documentation from the Broward County Planning Council verifying that the site does not require platting or replatting. If replatting or platting is not required, contact the Development Review Services Section of the Planning and Environmental Regulation Division of Broward County at (954) 357-6637 to ensure that proposed project is consistent with the latest recorded plat restriction.
- 5) Please contact Jean-Paul Perez, Broward County Planning and Development Division at [JPPerez@broward.org](mailto:JPPerez@broward.org) or 954-357-6637 to ensure the proposed plat note language meets their standards before moving forward. Please provide staff with written response from the County.



- 6) Pursuant to ULDR, Section 47-23.8, a twenty (20) foot landscaped yard is required adjacent to the existing bulkhead line. The required 20-foot yard shall not be used or developed for any purpose other than landscaping and the minimum amount of driveways or walkways reasonably necessary to serve the waterfront uses, unless specifically approved by the Planning and Zoning Board. The proposed encroachment into the 20-foot landscape area will require approval by the Planning and Zoning Board. Please indicate in the project narrative response the exact amount of the landscape area that will be provided along the waterfront.
- 7) Provide legible photometric plan for the entire site. Extend values on photometric plans to all property lines. Show values pursuant to the Unified and Land Development Regulations ("ULDR"), Section 47-25.3.A.3.a and 47-20.14. Indicate lighting poles on site plan and landscape plan, and provide detail with dimensions. Garage internal lighting fixtures and glare cannot be visible from neighboring properties.
- 8) Applicant shall provide additional screening within the garage to shield interior garage lighting and install shielding material along the all elevation facing the waterway and neighboring properties.
- 9) Provide the following on the details plans:
  - a) Fence detail, including height and information on automobile light shielding.
  - b) Aluminum screen proposed along facades.
- 10) Provide setback dimensions for all accessory uses including equipment on the ground floor site plan, including the pool and or other mechanical equipment.
- 11) Provide the following on the elevation plans:
  - a) Show setback dimensions from the property lines to all architectural elements and building face.
- 12) Coordinate with the Floodplain Manager, Richard Benson, for floodplain inquiries. Contact Info: [RBenton@fortlauderdale.gov](mailto:RBenton@fortlauderdale.gov), 954-828-6133Section 60.3(c)(3) of the NFIP regulations states that a community shall:
  - (1) "Require that all new construction and substantial improvements of non-residential structures within Zones A1-A30, AE, and AH on the community's FIRM (i) have the lowest floor (including basement) elevated to or above the base flood level, or (ii) together with attendant utility and sanitary facilities, be designed so that below the base flood level the structure is watertight with walls substantially impermeable to the passage of water and with structural components having the capability of resisting hydrostatic and hydrodynamic loads and effects of buoyancy."
  - (2) Below-grade parking garages are permitted beneath non-residential buildings in Zones A1-A30, AE, and AH provided the building (including the parking garage) is floodproofed to the base flood level in accordance with the design performance standards provided above in Section 60.3(c) (3)(ii). Only below-grade parking garages in non-residential buildings that are dry floodproofed are permitted under the NFIP.
  - (3) Guidance on floodproofing is provided in the FEMA manual "Floodproofing Non-Residential Structures" and in Technical Bulletin 3, "Non-Residential Floodproofing — Requirements and Certification."
- 13) If application proposes additional dockage and/or boat slips, provide an approval letter from the Broward County Environmental Protection Department, contact Julie Krawczyk (954-519-1266) prior to Planning and Zoning Board submittal.



- 14) Discuss all newly proposed seawalls, any repair to existing seawalls and/or re-location of existing seawalls with Engineering Representative.
- 15) The City's Vision is to support sustainable infrastructure. Consider employing green building practices throughout the project such as, but not limited to; charging stations, tank-less water heaters, rain collection systems, pervious pavement where appropriate, bio-swales, Florida Friendly™ plant materials, solar panels and green roofs.
- 16) This project is subject to the requirements of Broward County Public School Concurrency. The applicant will notify the School Board Superintendent or designee of this proposal. Prior to submitting an application for placement on a Planning and Zoning Board or City Commission agenda, a written response from the School Board shall be provided by the applicant. Prior to application for final DRC approval, please provide confirmation from the School District that the residential development is exempt or vested from the requirements of public school concurrency, or a School Capacity Availability Determination (SCAD) letter that confirms that capacity is available, or if capacity is not available, that mitigation requirements have been satisfied. The City cannot accept a building permit application, nor issue a building permit, for new or additional residential units, unless the applicant presents evidence from Broward County that the impact of the proposed development on public educational sites and facilities has been mitigated by payment of school impact fees.
- 17) Please provide total park impact fee amount due. Park impact fees are assessed and collected at time of permit per each new hotel room and dwelling unit type. An impact fee calculator can be found at: <http://www.fortlauderdale.gov/departments/sustainable-development/building-services/permit-fees/park-impact-fee-calculator>.

#### **GENERAL COMMENT**

- 18) Please note any proposed signs will require a separate permit application.
- 19) If a temporary construction/sales trailer is needed for this project, provide the details and location of the trailer on a separate site plan, to avoid additional review in the future. Verify details and location with the Building Representative.
- 20) An additional follow-up coordination meeting may be required to review project changes necessitated by the DRC comments. Prior to routing your plans for Pre-PZ and/or Final DRC sign-off, please schedule an appointment with the project planner (call 954-828-4798) to review project revisions and/or to obtain a signature routing stamp. Please note applicant is responsible for obtaining signatures from all discipline members that had comments and may need to resolve comments through individual appointments if necessary.
- 21) Additional comments may be forthcoming at the DRC meeting. Please provide a written response to all DRC comments within 180 days after comments have been received.

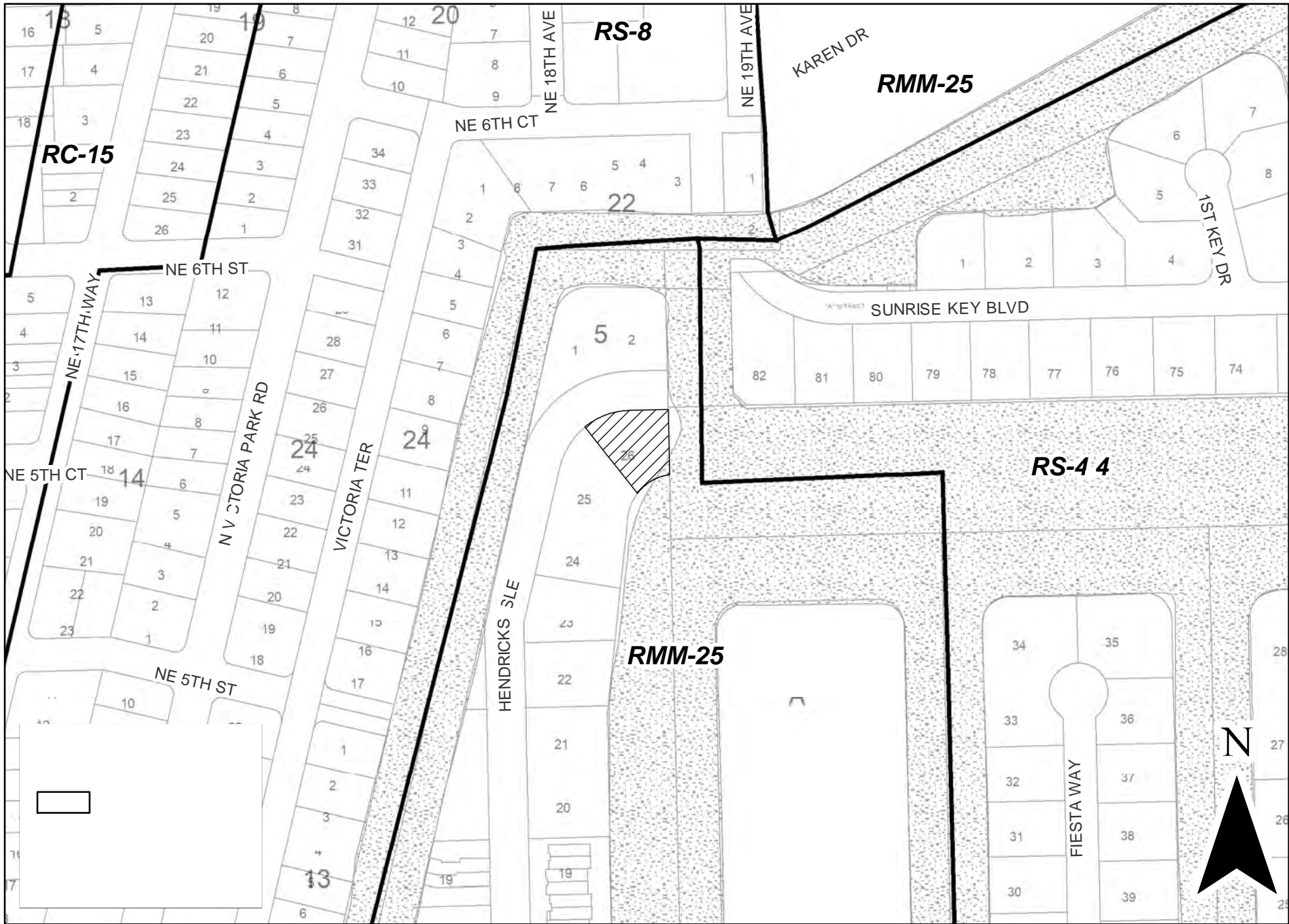

# R19069

