

MAINTENANCE OF TRAFFIC (MOT) FORM

SECTION 1: APPLICANT INFORMATION

Applicant Name: Brian Pittman Applicant Phone: 615-498-0575
 Applicant Email: BrianPittman@LiveNation.com
 Applicant Address: 410 Chestnut St Nashville, TN
(Address, City, State, Zip Code)
 City Project Manager (if applicable): _____ Phone: _____
 Agency responsible for this project: City County FDOT Other: _____
 On-site/Emergency Contact Phone: Brian Pittman - 615-498-0575

MOT APPROVAL
CITY OF FORT LAUDERDALE
TRANSPORTATION AND MOBILITY

SECTION 2: PROJECT INFORMATION

ENG Permit # (obtain from Department of Sustainable Development (DSD)): Special Event
 Project Name: Tortuga Music Festival
 Project Address: 1100 Seabreeze Fort Lauderdale, FL
(Address, City, State, Zip Code)

Specific Dates and Times Requested for MOT Implementation:

Please identify a start date that is at least two weeks from the submittal date. The approval of an MOT application may require up to two weeks from the time that all required documents are received by TAM staff.

Begin Date: ~~3/18/24~~ 3/25/24 Begin Time: 7:00am
 End Date: 4/13/24 End Time: 7:00pm

SECTION 3: PROJECT DETAILS

Partial or Shoulder Closure Daily Setup/ Breakdown YES NO
 Full Road Closure (detour): Under 72 Hours Using Crane in ROW* YES NO
 Sidewalk Closure: Under 72 Hours Parking Meters Impacted* YES NO
 Full Road/Sidewalk Closure: More than 72 Hours

*Crane and parking meter mitigation must be done prior to MOT approval. Please refer to the MOT Guidelines for crane definitions.

SECTION 4: TYPE OF WORK DESCRIPTION

Please make sure to include the following information in the description:

- List the names of affected streets and the nearest intersection. Use complete street names, including directionals.
- Describe the nature of the construction and any phasing plans. A separate MOT application is required for each phase.
- Describe any specific safety hazards that the work may produce during construction (i.e., large holes, etc.).

SE 5th St Will be closed between A1A North Bound and Seabreeze South Bound. We will use this pre event for load in and post for load out. On show days we will use for staff shuttle drop off in the morning and pick up in the evening
Gravel lot located just east of the Galleria Mall (off of NE 26th) will be used for Tortuga Music Festival production vehicles

SECTION 5: FDOT DESIGN STANDARD INDEX DRAWING NUMBERS/MUTCD TYPICAL APPLICATION

(State which FDOT Standard Index 600 series will be followed. The indexes must include the north arrow and the names of the main and cross streets. Also, state whether trenches will be covered or backfilled during non-working hours.)

MAINTENANCE OF TRAFFIC (MOT) FORM

SECTION 6: MOT DESCRIPTION

Please make sure to include the following information in the description:

- List the lanes that will be open and closed on each street and describe any necessary detours in detail. If detours are not required, please state that below.
- State if flagmen will be provided.
- State if the MOT will be continuous or intermittent. If intermittent, state the times of the day the MOT will be in effect.
- State any other special considerations related to this request.

MOT APPROVAL
CITY OF FORT LAUDERDALE
TRANSPORTATION AND MOBILITY

SE 5th Street will be closed between A1A and Seabreeze. Vehicles will be detoured north to E Las Olas Blvd.

Flagmen not required. MOT will be continuous during event.

SECTION 7: MOT FORM CHECKLIST (Provide one copy of each attachment.)

- | | |
|--|--|
| <input type="checkbox"/> Completed Required Signatures Form | <input type="checkbox"/> Certification(s) for Traffic Control Technician or Traffic Control Supervisor must be embedded on MOT plans along with FDOT indexes/MUTCD documents |
| <input type="checkbox"/> Color aerial(s)/MOT Plan with index overlay | |
| <input type="checkbox"/> County and State approvals (if required) | <input type="checkbox"/> Plan of work (optional, but preferred) |
| <input type="checkbox"/> Crane and Parking Mitigation (if required) | |
| <input type="checkbox"/> FDOT Index MUTCD Reference Drawing(s) | |

SECTION 8: ADDITIONAL COMMENTS

Please Note: The approval of an MOT application may require up to two weeks from the time that all required documents in the checklist above are received by TAM staff. Any rejected MOT submittal that is corrected and sent back will be considered a new submittal, which may require up to two additional weeks to approve. Additional time may be needed for more complex plans or plans requiring additional coordination/information.

In signing this application, I understand that separate City and/or County and/or State permits may be required for this project. Furthermore, I am aware that I am responsible for ensuring that the project is completed in accordance with the plans and specifications as stipulated in the permit approval condition.



 (APPLICANT SIGNATURE)

Brian Pittman

 (PRINT NAME/TITLE)

3/18/24

 (DATE SIGNED)

As a consideration for the permission granted herein, _____ agrees to indemnify and hold harmless the City of Fort Lauderdale for any damages, claims, or injuries that may result from the MOT plan approved under the PERMIT.

 (NAME OF COMPANY)

BY: _____
 (COMPANY AUTHORIZED AGENT)

REQUIRED SIGNATURES FORM

Applicant must collect all required signatures. To expedite processing, individual signatures may be obtained and submitted to MOT@fortlauderdale.gov separately on this page. All signatures and comments must be submitted before two-week review process begins.

MOT APPROVAL

CITY OF FORT LAUDERDALE

TRANSPORTATION AND MOBILITY

<p style="text-align: center;">_____ Print Name</p> <p style="text-align: center;">_____ Signature</p> <p style="text-align: center;">Police Department 1300 W. Broward Boulevard Tel: 954-828-5477 <i>Call for Appointment</i></p> <p style="text-align: center;">*Required only if MOT includes a detour for any direction of travel.</p>	<p style="text-align: center;">_____ (Date)</p>
<p style="text-align: center;">_____ Print Name</p> <p style="text-align: center;">_____ Signature</p> <p style="text-align: center;">Fire Rescue Department 528 N.W. 2nd Street Tel: 954-828-6800 <i>Call for Appointment</i></p> <p style="text-align: center;">*Required only if MOT includes a detour for any direction of travel.</p>	<p style="text-align: center;">_____ 3/21/24 (Date)</p>
<p style="text-align: center;">_____ Print Name</p> <p style="text-align: center;">_____ Signature</p> <p style="text-align: center;">Broward County Traffic Engineering Division 2300 W. Commercial Boulevard Tel: 954-847-2653 <i>Call for Appointment. Walk-ins NOT accepted.</i></p> <p style="text-align: center;">*Required only if MOT/detour affects Broward County road or intersection.</p>	<p style="text-align: center;">_____ (Date)</p>
<p>After all applicable signatures are collected, applicant should submit the MOT plan and this routing form to the Transportation and Mobility Department at mot@fortlauderdale.gov.</p>	
<p>OFFICE USE ONLY Department Director's Signature (requested by City staff if required)</p>	
<p style="text-align: center;">_____ Print Name</p> <p style="text-align: center;">_____ Signature</p> <p style="text-align: center;">Transportation and Mobility Department 290 N.E. 3rd Avenue Tel: 954- 828-4997 Email: MOT@fortlauderdale.gov <i>Call for Appointment. Walk-ins and hard copies NOT accepted.</i></p>	<p style="text-align: center;">_____ 3/21/24 (Date)</p>
<p style="text-align: center;">_____ Signature</p> <p style="text-align: center;">Transportation and Mobility Department Ben Rogers, Director</p>	<p style="text-align: center;">_____ (Date)</p>

A copy of the final permit and this MOT form shall be kept on site and be made available to the City inspector at all times.

Traffic modifications required for special events shall be coordinated through the Parks and Recreation's Special Events Department. Please call 954-828-4349 or email BHenry@fortlauderdale.gov.

MOT plans for City Capital Improvement Projects shall be coordinated through the City of Fort Lauderdale Public Works Department. Please call 954-828-5772 or email ralvarez@fortlauderdale.gov.

REQUIRED SIGNATURES FORM

Applicant must collect all required signatures. To expedite processing, individual signatures may be obtained and submitted to MOT@fortlauderdale.gov separately on this page. All signatures and comments must be submitted before two-week review process begins.

<p style="text-align: center;">M. Ferrer</p> <hr/> <p style="text-align: center;">Print Name</p>	<p style="text-align: center;"><i>monica ferrer</i></p> <hr/> <p style="text-align: center;">Signature</p>
<p>Police Department 1300 W. Broward Boulevard Tel: 954-828-5477 <i>Call for Appointment</i></p> <p><i>*Required only if MOT includes a detour for any direction of travel.</i></p>	
<hr/> <p style="text-align: center;">Print Name</p>	<hr/> <p style="text-align: center;">Signature</p>
<p>Fire Rescue Department 528 N.W. 2nd Street Tel: 954-828-6800 <i>Call for Appointment</i></p> <p><i>*Required only if MOT includes a detour for any direction of travel.</i></p>	
<hr/> <p style="text-align: center;">Print Name</p>	<hr/> <p style="text-align: center;">Signature</p>
<p>Broward County Traffic Engineering Division 2300 W. Commercial Boulevard Tel: 954-847-2653 <i>Call for Appointment. Walk-ins NOT accepted.</i></p> <p><i>*Required only if MOT/detour affects Broward County road or intersection.</i></p>	
<p>After all applicable signatures are collected, applicant should submit the MOT plan and this routing form to the Transportation and Mobility Department at mot@fortlauderdale.gov.</p>	
<p>OFFICE USE ONLY Department Director's Signature (requested by City staff if required)</p>	
<hr/> <p style="text-align: center;">Print Name</p>	<hr/> <p style="text-align: center;">Signature</p>
<p>Transportation and Mobility Department 290 N.E. 3rd Avenue Tel: 954- 828-4997 Email: MOT@fortlauderdale.gov <i>Call for Appointment. Walk-ins and hard copies NOT accepted.</i></p>	
<hr/> <p style="text-align: center;">Signature</p>	<hr/> <p style="text-align: center;">(Date)</p>
<p>Transportation and Mobility Department Ben Rogers, Director</p>	
<hr/> <p style="text-align: center;">Signature</p>	<hr/> <p style="text-align: center;">(Date)</p>

A copy of the final permit and this MOT form shall be kept on site and be made available to the City inspector at all times.

Traffic modifications required for special events shall be coordinated through the Parks and Recreation's Special Events Department. Please call 954-828-4349 or email BHenry@fortlauderdale.gov.

MOT plans for City Capital Improvement Projects shall be coordinated through the City of Fort Lauderdale Public Works Department. Please call 954-828-5772 or email ralvarez@fortlauderdale.gov.

MARK@MOTPLANS.COM



Mark Meyers

Certificate: Has Completed a FDOT Approved Temporary Traffic Control: Advanced Course.
605769

Issued: 02/13/2023 Training Provider: myTTOnline

Expires: 02/02/2027 83 Geneva Dr. Ste. 621394

Instructor: M.H. myTTonline Oviedo, FL 32762

Ph: 407-901-0206

Verify this Certificate at www.motadmin.com.

TABLE 1 CHANNELIZING DEVICE SPACING				TABLE 2 TAPER LENGTH "L"	
Work Zone Speed (mph)	Max. Spacing (feet)			Work Zone Speed (mph)	Min. Length (feet)
	Cones or Temporary Tubular Markers	Type I Barricades, Vertical Panels, or Drums	Taper		
≤ 45	25	30	25	≥ 45	L = WS
≥ 50	25	50	50		

TABLE 3 WORK ZONE SIGN SPACING "X"		TABLE 4 BUFFER LENGTH "B"	
Road Type	Min. Spacing (feet)	Work Zone Speed (mph)	Min. Length (feet)
Arterials and Collectors with Work Zone Speed ≤ 40 mph	200	25	155
Arterials and Collectors with Work Zone Speed ≥ 45 mph	500	30	200
Limited Access Roadways	1,500	40	305
For Limited access roadways with work zone speed ≤ 55 mph, the minimum spacing may be reduced in accordance with the MUTCD and as approved by the Engineer.			
		45	360
		60	570
		50	425
		55	495
		60	570
		65	645
		70	730

Note: When Buffer Length "B" cannot be attained due to geometric constraints, use the greatest length possible but not less than 155 feet.

SPEED LIMIT 35

MOT APPROVAL
CITY OF FORT LAUDERDALE
TRANSPORTATION AND MOBILITY



Notes for Figure 6H-20—Typical Application 20 Detour for a Closed Street

Guidance:

1. *This plan should be used for streets without posted route numbers.*
 2. *On multi-lane streets, Detour signs with an Advance Turn Arrow should be used in advance of a turn.*
- Option:
3. Flashing warning lights and/or flags may be used to call attention to the advance warning signs.
 4. Flashing warning lights may be used on Type 3 Barricades.
 5. Detour signs may be located on the far side of intersections. A Detour sign with an advance arrow may be used in advance of a turn.
 6. A Street Name sign may be mounted with the Detour sign. The Street Name sign may be either white on green or black on orange.

Standard:

7. **When used, the Street Name sign shall be placed above the Detour sign.**

Support:

8. See Figure 6H-9 for the information for detouring a numbered highway.



Figure 6H-20. Detour for a Closed Street (TA-20)

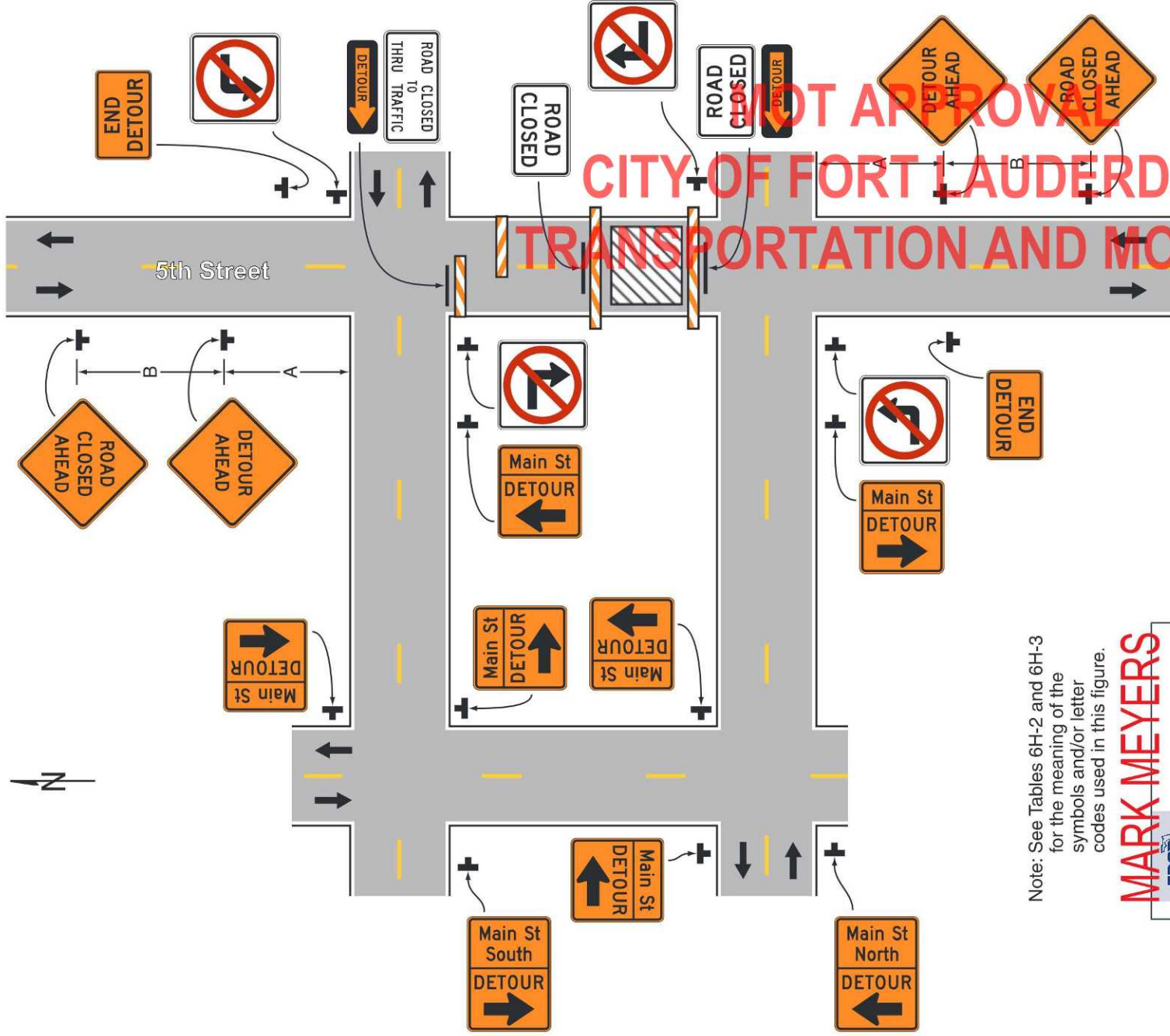

Note: See Tables 6H-2 and 6H-3 for the meaning of the symbols and/or letter codes used in this figure.

MARK MEYERS

Mark Meyers	
Certificate: 605769	Has Completed a FDOT Approved Temporary Traffic Control: Advanced Course.
Issued: 02/13/2023	Training Provider: myTTControl 83 Geneva Dr. Ste. 621394 Oviedo, FL 32762 Pk: 407-901-6206
Expires: 02/02/2027	Instructor: M. H.
Verify this Certificate at www.mtccim.com .	

Typical Application 20

From: [Marc Isaac](#)
To: [Morgan Dunn](#)
Subject: RE: Tortuga - SE 5 St MOT Closure Coordination
Date: Thursday, March 21, 2024 9:06:17 AM

Thank you Morgan,

I appreciate you keeping me in the loop. My contractor and I also met with them earlier this week and we are okay with the closure.

**MOT APPROVAL
CITY OF FORT LAUDERDALE
TRANSPORTATION AND MOBILITY**

Marc Isaac
954-828-5230

From: Morgan Dunn <MDunn@fortlauderdale.gov>
Sent: Thursday, March 21, 2024 9:03 AM
To: Marc Isaac <MIsaac@fortlauderdale.gov>
Subject: Tortuga - SE 5 St MOT Closure Coordination

Good morning Marc,

I just wanted to confirm that coordination was approved with Tortuga Music Festival for use of SE 5 St before I move forward with requesting any signature approvals. I've attached their MOT application and plans as reference.

Thanks!

Morgan Dunn, Program Manager I
City of Fort Lauderdale | Transportation & Mobility Department
290 NE 3rd Avenue | Fort Lauderdale FL 33301
Office: (954) 828 - 6078 | Cell: (954) 299 - 8034
Email: MDunn@fortlauderdale.gov

From: [Frank Milen](#)
To: [Morgan Dunn](#)
Subject: [EXTERNAL:CAUTION!]- RE: 5th at Seabreeze
Date: Tuesday, March 5, 2024 10:28:23 AM
Attachments: [image001.png](#)
[image002.png](#)
[image003.png](#)
[image004.png](#)
[image005.png](#)

MOT APPROVAL CITY OF FORT LAUDERDALE TRANSPORTATION AND MOBILITY

[::CAUTION!:] This email originated from *outside* The City of Fort Lauderdale.
Do Not Reply, click links, or open attachments from an unknown or suspicious origin. Confirm the email address is from an expected source before taking action.
Report any suspicious emails to spamadmin@fortlauderdale.gov

Good Morning, Morgan,

I am doing well thank you hopefully you are as well. I spoke to Jim yesterday and as of now I have not heard anything starting before that timeline.

Could you please let me know again when our MOT expires?

Frank Milen

General Superintendent

101 North Riverside Drive, Suite 214, Pompano Beach, FL 33062
t 561-659-5819 c 954-415-2117
www.coastalconstruction.com



Disclaimer

This email and any files transmitted with it are confidential and intended solely for the addressee or similar. If you are not the named addressee you should not disseminate, distribute, copy or alter this email. Any views or opinions presented in this email are solely those of the author and might not represent those of Coastal Construction Group. If you are not the intended recipient, please contact the sender by reply email and destroy all copies of the original message.

From: Morgan Dunn <MDunn@fortlauderdale.gov>
Sent: Tuesday, March 5, 2024 9:18 AM
To: Frank Milen <FMilen@coastalconstruction.com>
Subject: FW: 5th at Seabreeze

CAUTION: This email originated from outside of the organization. Please do not click links or open attachments unless you recognize the sender and are expecting the message.

Good morning Frank,

I hope you are doing well. I received the below communication from Jim Reid with Tortuga Music Festival regarding the use of SE 5 St for their event this year. Can you please confirm that there is no conflict with Tortuga utilizing SE 5 St from 3/29/24 through at least 4/11/24?

Thanks,

Morgan Dunn, Program Manager I
City of Fort Lauderdale | Transportation & Mobility Department

290 NE 3rd Avenue | Fort Lauderdale FL 33301
Office: (954) 828 - 6078 | Cell: (954) 299 - 8034
Email: MDunn@fortlauderdale.gov

MOT APPROVAL
CITY OF FORT LAUDERDALE
TRANSPORTATION AND MOBILITY

From: Jim Reid <JimReid@LiveNation.com>
Sent: Tuesday, March 5, 2024 9:14 AM
To: Morgan Dunn <MDunn@fortlauderdale.gov>
Cc: Brian Pittman <BrianPittman@LiveNation.com>
Subject: [EXTERNAL:CAUTION!]- Re: 5th at Seabreeze

**[::CAUTION!:] This email originated from *outside* The City of Fort Lauderdale.
Do Not Reply, click links, or open attachments from an unknown or suspicious origin. Confirm the email address is from an expected source before taking action.
Report any suspicious emails to spamadmin@fortlauderdale.gov**

We'd take it over on 3/29 which is when we are taking over the north end of the lot.
Thanks Morgan.

Jim

On Mar 5, 2024, at 8:39 AM, Morgan Dunn <MDunn@fortlauderdale.gov> wrote:

[EXTERNAL]

Good morning Jim,

Do you have an idea of when you would like to occupy SE 5 St?

Thanks,

Morgan Dunn, Program Manager I

City of Fort Lauderdale|Transportation & Mobility Department

290 NE 3rd Avenue | Fort Lauderdale FL 33301

Office: (954) 828 - 6078 | Cell: (954) 299 - 8034

Email: MDunn@fortlauderdale.gov

**MOT APPROVAL
CITY OF FORT LAUDERDALE
TRANSPORTATION AND MOBILITY**

From: Jim Reid <JimReid@LiveNation.com>
Sent: Monday, March 4, 2024 4:47 PM
To: Morgan Dunn <MDunn@fortlauderdale.gov>
Cc: Brian Pittman <BrianPittman@LiveNation.com>
Subject: [EXTERNAL:CAUTION!]- 5th at Seabreeze

**[::CAUTION!:] This email originated from *outside* The City of Fort Lauderdale.
Do Not Reply, click links, or open attachments from an unknown or suspicious origin.
Confirm the email address is from an expected source before taking action.
Report any suspicious emails to spamadmin@fortlauderdale.gov**

Hi Morgan,

I spoke with Frank Milan of Coastal Construction. He is overseeing The Dunes project at 5th and Seabreeze for Coastal. Frank has no expectation that The Dunes project will encroach on 5th Street or the metered spots on the north side 5th between now and the conclusion of Tortuga.

Morgan, as we have done several times now, we at Tortuga would love to buy up those metered spots and close 5th Street to public traffic during Tortuga and a few days leading up to the show. We would make sure that our plan would in no way limit The City's DC Alexander project.

Any objection to reengaging 5th into our traffic plan and adding those metered spots to our parking plan?

Thanks Morgan,

Jim

Jim Reid- Vice President of Operations

Country Nation

Email: jimreid@livenation.com

Phone: 248-697-3122

27995 Halsted Rd, Farmington Hills, MI 48331

<image001.png>





TAM-MOT-24030057 - Tortuga SE 5 St Closure

Final Audit Report

2024-04-01

Created:	2024-04-01
By:	Morgan Dunn (MDunn@fortlauderdale.gov)
Status:	Signed
Transaction ID:	CBJCHBCAABAAQYNv4UA1siRbUntVCMZQpV0KV0ifYkqh

"TAM-MOT-24030057 - Tortuga SE 5 St Closure" History

-  Document created by Morgan Dunn (MDunn@fortlauderdale.gov)
2024-04-01 - 7:32:14 PM GMT- IP address: 50.232.252.93
-  Document emailed to Ekaete Ekwere (eekwere@fortlauderdale.gov) for signature
2024-04-01 - 7:32:24 PM GMT
-  Email viewed by Ekaete Ekwere (eekwere@fortlauderdale.gov)
2024-04-01 - 7:42:43 PM GMT- IP address: 104.47.65.254
-  Document e-signed by Ekaete Ekwere (eekwere@fortlauderdale.gov)
Signature Date: 2024-04-01 - 7:42:59 PM GMT - Time Source: server- IP address: 50.232.252.93
-  Agreement completed.
2024-04-01 - 7:42:59 PM GMT



Powered by
Adobe
Acrobat Sign