

# MAINTENANCE OF TRAFFIC (MOT) FORM

MOT APPROVAL

CITY OF FORT LAUDERDALE

TRANSPORTATION AND MOBILITY

## SECTION 1: APPLICANT INFORMATION

Applicant Name: Atlantic Studios, Inc. Applicant Phone: (954) 785-7475

Applicant Email: cwg@atlanticstudios.com

Applicant Address: 434 NW 1st Avenue, Suite #504, Fort Lauderdale, FL. 33301  
(Address, City, State, Zip Code)

City Project Manager (if applicable): Phone:

Agency responsible for this project:  City  County  FDOT  Other: Atlantic Studios, Inc.

On-site/Emergency Contact Phone: (954) 785-7475 or (954) 788-3467

## SECTION 2: PROJECT INFORMATION

ENG Permit # (obtain from Department of Sustainable Development (DSD)):

Project Name: Food In Motion

Project Address: Esplanade Park - 400 SW 2nd Street, Fort Lauderdale, FL. 33312  
(Address, City, State, Zip Code)

### Specific Dates and Times Requested for MOT Implementation:

Please identify a start date that is at least two weeks from the submittal date. The approval of an MOT application may require up to two weeks from the time that all required documents are received by TAM staff.

Begin Date: 04/05/24, 04/19/24, 05/03/24, 05/17/24, 06/07/24, 06/21/24

Begin Time: 1:00PM

End Date: 04/06/24, 04/20/24, 05/04/24, 05/18/24, 06/08/24, 06/22/24

End Time: 1:00AM

## SECTION 3: PROJECT DETAILS

Partial or Shoulder Closure

Daily Setup/ Breakdown  YES  NO

Full Road Closure (detour): Under 72 Hours

Using Crane in ROW\*  YES  NO

Sidewalk Closure: Under 72 Hours

Parking Meters Impacted\*  YES  NO

Full Road/Sidewalk Closure: More than 72 Hours

\*Crane and parking meter mitigation must be done prior to MOT approval. Please refer to the MOT Guidelines for crane definitions.

## SECTION 4: TYPE OF WORK DESCRIPTION

Please make sure to include the following information in the description:

- List the names of affected streets and the nearest intersection. Use complete street names, including directionals.
- Describe the nature of the construction and any phasing plans. A separate MOT application is required for each phase.
- Describe any specific safety hazards that the work may produce during construction (i.e., large holes, etc.).

Food In Motion is an evening-time food & green market styled event that began in 2014 at Peter Feldman Park.

FIM has been held monthly since 2014 - MOT Plans has been the detour schedule provider.

Event related road closure: SW 2nd St. (Himmarshe), closed b/t SW 4th Ave. & SW 5th Ave.

No road work or safety hazards - Purpose of closure: Increase event footprint & facilitate the inclusion of food trucks / MFDVs.

## SECTION 5: FDOT DESIGN STANDARD INDEX DRAWING NUMBERS/MUTCD TYPICAL APPLICATION

(State which FDOT Standard Index 600 series will be followed. The indexes must include the north arrow and the names of the main and cross streets. Also, state whether trenches will be covered or backfilled during non-working hours.)

# MAINTENANCE OF TRAFFIC (MOT) FORM

MOT APPROVAL

CITY OF FORT LAUDERDALE

TRANSPORTATION AND MOBILITY

## SECTION 6: MOT DESCRIPTION

Please make sure to include the following information in the description:

- List the lanes that will be open and closed on each street and describe any necessary detours in detail. If detours are not required, please state that below.
- State if flagmen will be provided.
- State if the MOT will be continuous or intermittent. If intermittent, state the times of the day the MOT will be in effect.
- State any other special considerations related to this request.

East & westbound lanes of SW 2nd Street b/t SW 4th Ave & SW 5th Ave, Also SW 4th Ave from SW 2nd Street, east to the river.

Flagmen are not provided for this MOT, as they are not indicated on the attached plan.

MOT will only be in-place for aprox. 12 hours, on the 1st & 3rd Friday night of each month, from 1:00PM - 1:00AM (or sooner)

FLPD will provide special detail services.

## SECTION 7: MOT FORM CHECKLIST (Provide one copy of each attachment.)

- Completed Required Signatures Form
- Certification(s) for Traffic Control Technician or Traffic Control Supervisor must be embedded on MOT plans along with FDOT indexes/MUTCD documents
- Color aerial(s)/MOT Plan with index overlay
- County and State approvals (if required)
- Crane and Parking Mitigation (if required)
- Plan of work (optional, but preferred)
- FDOT Index MUTCD Reference Drawing(s)

## SECTION 8: ADDITIONAL COMMENTS

This is a legacy event that has operated on a monthly basis since 2014, in a safe and orderly manner.

**Please Note: The approval of an MOT application may require up to two weeks from the time that all required documents in the checklist above are received by TAM staff. Any rejected MOT submittal that is corrected and sent back will be considered a new submittal, which may require up to two additional weeks to approve. Additional time may be needed for more complex plans or plans requiring additional coordination/information.**

In signing this application, I understand that separate City and/or County and/or State permits may be required for this project. Furthermore, I am aware that I am responsible for ensuring that the project is completed in accordance with the plans and specifications as stipulated in the permit approval condition.

  
(APPLICANT SIGNATURE)

Chris Gaidry | President  
(PRINT NAME/TITLE)

03/27/2024  
(DATE SIGNED)

As a consideration for the permission granted herein, Atlantic Studios, Inc. agrees to indemnify and hold harmless the City of Fort Lauderdale for any damages, claims, or injuries that may result from the MOT plan approved under the PERMIT.

Atlantic Studios, Inc.  
(NAME OF COMPANY)

BY: Chris Gaidry  
(COMPANY AUTHORIZED AGENT)

# REQUIRED SIGNATURES FORM

Applicant must collect all required signatures. To expedite processing, individual signatures may be obtained and submitted to [MOT@fortlauderdale.gov](mailto:MOT@fortlauderdale.gov) separately on this page. All signatures and comments must be submitted before two-week review process begins.

**MOT APPROVAL**  
**CITY OF FORT LAUDERDALE**  
**TRANSPORTATION AND MOBILITY**

_____ Print Name	_____ Signature	
<b>Police Department</b> 1300 W. Broward Boulevard   Tel: 954-828-5477 <i>Call for Appointment</i> *Required only if MOT includes a detour for any direction of travel.		_____ (Date)

Jason W Miller _____ Print Name	 _____ Signature	
<b>Fire Rescue Department</b> 528 N.W. 2 <sup>nd</sup> Street   Tel: 954-828-6800 <i>Call for Appointment</i> *Required only if MOT includes a detour for any direction of travel.		4/4/24 _____ (Date)

_____ Print Name	_____ Signature	
<b>Broward County Traffic Engineering Division</b> 2300 W. Commercial Boulevard   Tel: 954-847-2653 <i>Call for Appointment. Walk-ins NOT accepted.</i> *Required only if MOT/detour affects Broward County road or intersection.		_____ (Date)

After all applicable signatures are collected, applicant should submit the MOT plan and this routing form to the Transportation and Mobility Department at [mot@fortlauderdale.gov](mailto:mot@fortlauderdale.gov).

### OFFICE USE ONLY

Department Director's Signature (requested by City staff if required)

Morgan Dunn _____ Print Name	 _____ Signature	
<b>Transportation and Mobility Department</b> 290 N.E. 3 <sup>rd</sup> Avenue   Tel: 954- 828-4997   Email: <a href="mailto:MOT@fortlauderdale.gov">MOT@fortlauderdale.gov</a> <i>Call for Appointment. Walk-ins and hard copies NOT accepted.</i>		4/4/24 _____ (Date)

 <a href="#">Ekaete Ekwere (Apr 5, 2024 15:38 EDT)</a> _____ Signature		
<b>Transportation and Mobility Department</b> Ben Rogers, Director		_____ (Date)

A copy of the final permit and this MOT form shall be kept on site and be made available to the City inspector at all times.

Traffic modifications required for special events shall be coordinated through the Parks and Recreation's Special Events Department. Please call 954-828-4349 or email [BHenry@fortlauderdale.gov](mailto:BHenry@fortlauderdale.gov).

MOT plans for City Capital Improvement Projects shall be coordinated through the City of Fort Lauderdale Public Works Department. Please call 954-828-5772 or email [ralvarez@fortlauderdale.gov](mailto:ralvarez@fortlauderdale.gov).

# REQUIRED SIGNATURES FORM

Applicant must collect all required signatures. To expedite processing, individual signatures may be obtained and submitted to [MOT@fortlauderdale.gov](mailto:MOT@fortlauderdale.gov) separately on this page. All signatures and comments must be submitted before two-week review process begins.

**MOT APPROVAL**  
**CITY OF FORT LAUDERDALE**  
**TRANSPORTATION AND MOBILITY**

M. Ferrer _____ Print Name	 _____ Signature	4/4/24 _____ (Date)
<b>Police Department</b> 1300 W. Broward Boulevard   Tel: 954-828-5477 <i>Call for Appointment</i> *Required only if MOT includes a detour for any direction of travel.		

_____ Print Name	_____ Signature	_____ (Date)
<b>Fire Rescue Department</b> 528 N.W. 2 <sup>nd</sup> Street   Tel: 954-828-6800 <i>Call for Appointment</i> *Required only if MOT includes a detour for any direction of travel.		

_____ Print Name	_____ Signature	_____ (Date)
<b>Broward County Traffic Engineering Division</b> 2300 W. Commercial Boulevard   Tel: 954-847-2653 <i>Call for Appointment. Walk-ins NOT accepted.</i> *Required only if MOT/detour affects Broward County road or intersection.		

After all applicable signatures are collected, applicant should submit the MOT plan and this routing form to the Transportation and Mobility Department at [mot@fortlauderdale.gov](mailto:mot@fortlauderdale.gov).

### OFFICE USE ONLY

Department Director's Signature (requested by City staff if required)

_____ Print Name	_____ Signature	_____ (Date)
<b>Transportation and Mobility Department</b> 290 N.E. 3 <sup>rd</sup> Avenue   Tel: 954- 828-4997   Email: <a href="mailto:MOT@fortlauderdale.gov">MOT@fortlauderdale.gov</a> <i>Call for Appointment. Walk-ins and hard copies NOT accepted.</i>		

_____ Signature	<b>Transportation and Mobility Department</b> Ben Rogers, Director	_____ (Date)
--------------------	---	-----------------

A copy of the final permit and this MOT form shall be kept on site and be made available to the City inspector at all times.

Traffic modifications required for special events shall be coordinated through the Parks and Recreation's Special Events Department. Please call 954-828-4349 or email [BHenry@fortlauderdale.gov](mailto:BHenry@fortlauderdale.gov).

MOT plans for City Capital Improvement Projects shall be coordinated through the City of Fort Lauderdale Public Works Department. Please call 954-828-5772 or email [ralvarez@fortlauderdale.gov](mailto:ralvarez@fortlauderdale.gov).



SW 5TH AVE.

FOOD INNOVATION

SITE PLAN / ESPLANADE PARK

ROAD BLOCK

ROAD BLOCK

ROAD BLOCK

MOT APPROVAL  
CITY OF FORT LAUDERDALE  
TRANSPORTATION AND MOBILITY

LEGEND:

- = NFDY
- = 10X10 POPUP CANOPY
- = RESTROOMS
- = HOUSE POWER



SW 4TH AVE.

EQUIPMENT STAGING / STAFF PARKING

FOOD INNOVATION

STAGE

NEW RIVER

**MOT APPROVAL  
CITY OF FORT LAUDERDALE  
TRANSPORTATION AND MOBILITY**

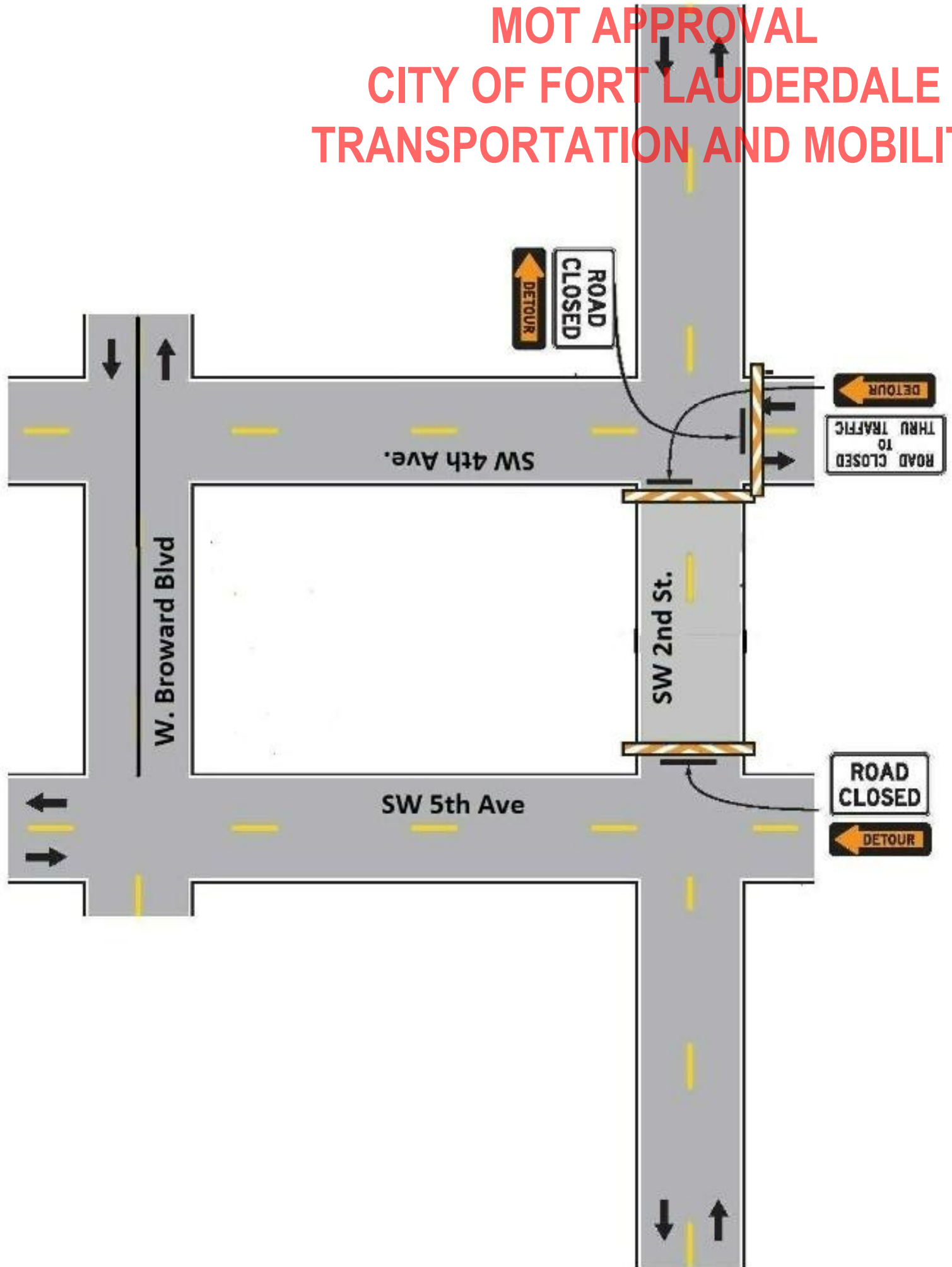

## Notes for Figure 6H-20—Typical Application 20 Detour for a Closed Street

### Guidance:

1. *This plan should be used for streets without posted route numbers.*
2. *On multi-lane streets, Detour signs with an Advance Turn Arrow should be used in advance of a turn.*

### Option:

3. Flashing warning lights and/or flags may be used to call attention to the advance warning signs.
4. Flashing warning lights may be used on Type 3 Barricades.
5. Detour signs may be located on the far side of intersections. A Detour sign with an advance arrow may be used in advance of a turn.
6. A Street Name sign may be mounted with the Detour sign. The Street Name sign may be either white on green or black on orange.

### Standard:

7. **When used, the Street Name sign shall be placed above the Detour sign.**

### Support:

8. See Figure 6H-9 for the information for detouring a numbered highway.

Figure 6H-20. Detour for a Closed Street (TA-20)

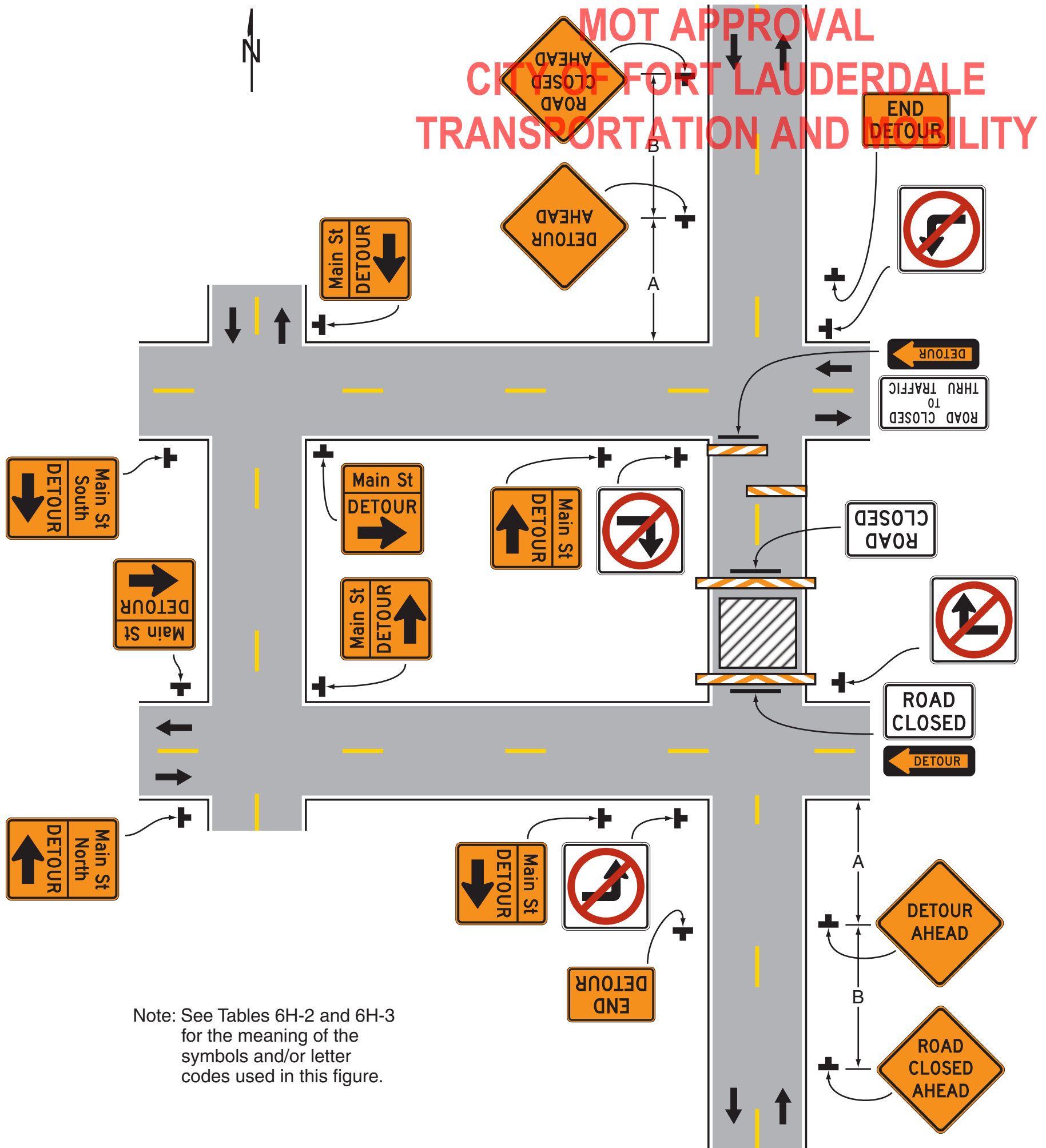

Typical Application 20







# TAM-MOT-24040017 - Food In Motion Apr - June

Final Audit Report

2024-04-05

Created:	2024-04-04
By:	Morgan Dunn (MDunn@fortlauderdale.gov)
Status:	Signed
Transaction ID:	CBJCHBCAABAAYqyJhpfDo2B73Os9H5YeqZm-rbUDpcWK

## "TAM-MOT-24040017 - Food In Motion Apr - June" History

-  Document created by Morgan Dunn (MDunn@fortlauderdale.gov)  
2024-04-04 - 4:37:20 PM GMT- IP address: 50.232.252.93
-  Document emailed to Ekaete Ekwere (eekwere@fortlauderdale.gov) for signature  
2024-04-04 - 4:37:35 PM GMT
-  Document e-signed by Ekaete Ekwere (eekwere@fortlauderdale.gov)  
E-signature obtained using URL retrieved through the Adobe Acrobat Sign API  
Signature Date: 2024-04-05 - 7:38:50 PM GMT - Time Source: server- IP address: 50.232.252.93
-  Agreement completed.  
2024-04-05 - 7:38:50 PM GMT



Powered by  
**Adobe**  
Acrobat Sign