

MAINTENANCE OF TRAFFIC (MOT) FORM

SECTION 1: APPLICANT INFORMATION

Applicant Name: Kids In Distress, Inc. Applicant Phone: 954.390.7654
 Applicant Email: SuhailRuano@kidinc.org
 Applicant Address: 819 NE 26 Street, Fort Lauderdale, FL, 33305
(Address, City, State, Zip Code)
 City Project Manager (if applicable): Phone:
 Agency responsible for this project: City County FDOT Other: Self & Ft. Lauderdale PD Traffic Officers
 On-site/Emergency Contact Phone: 954.868.4564

MOT APPROVAL
 CITY OF FORT LAUDERDALE
 TRANSPORTATION AND MOBILITY

SECTION 2: PROJECT INFORMATION

ENG Permit # (obtain from Department of Sustainable Development (DSD)): Special Event
 Project Name: 18th Annual Duck Fest Derby- Special Event
 Project Address: 400 SW 2nd St., Fort Lauderdale, FL 33301
(Address, City, State, Zip Code)

Specific Dates and Times Requested for MOT Implementation:

Please identify a start date that is at least two weeks from the submittal date. The approval of an MOT application may require up to two weeks from the time that all required documents are received by TAM staff.

Begin Date: 3.9.24 Begin Time: 8am
 End Date: 3.9.24 End Time: 6 pm

SECTION 3: PROJECT DETAILS

Partial or Shoulder Closure
 Full Road Closure (detour): Under 72 Hours
 Sidewalk Closure: Under 72 Hours
 Full Road/Sidewalk Closure: More than 72 Hours

Daily Setup/ Breakdown YES NO
 Using Crane in ROW* YES NO
 Parking Meters Impacted* YES NO

*Crane and parking meter mitigation must be done prior to MOT approval. Please refer to the MOT Guidelines for crane definitions.

SECTION 4: TYPE OF WORK DESCRIPTION

Please make sure to include the following information in the description:

- List the names of affected streets and the nearest intersection. Use complete street names, including directionals.
- Describe the nature of the construction and any phasing plans. A separate MOT application is required for each phase.
- Describe any specific safety hazards that the work may produce during construction (i.e., large holes, etc.).

SW 2nd St between SW 4th Ave and SW 5th Ave, and SW 4th Ave between SW 2nd St and the New River.
 SE 2nd Street from SE 5th Ave to SE 4th Ave. - this is used for the Fun Zone which includes bounce houses, food trucks, vendors
 SE 4th Ave would be closed from SE 2nd Street to the water. This is used for vendor parking, drop off, etc. We will have someone stationed to allow residents in and out of 4th Ave to SE 2nd and beyond. We pay for all of the parking spots every year.

SECTION 5: FDOT DESIGN STANDARD INDEX DRAWING NUMBERS/MUTCD TYPICAL APPLICATION

(State which FDOT Standard Index 600 series will be followed. The indexes must include the north arrow and the names of the main and cross streets. Also, state whether trenches will be covered or backfilled during non-working hours.)

TA-20

MAINTENANCE OF TRAFFIC (MOT) FORM

SECTION 6: MOT DESCRIPTION

Please make sure to include the following information in the description:

- List the lanes that will be open and closed on each street and describe any necessary detours in detail. If detours are not required, please state that below.
- State if flagmen will be provided.
- State if the MOT will be continuous or intermittent. If intermittent, state the times of the day the MOT will be in effect.
- State any other special considerations related to this request.

MOT APPROVAL
CITY OF FORT LAUDERDALE
TRANSPORTATION AND MOBILITY

SW 2nd St. will be closed between SW 4th Ave. and SW 5th Ave.

SW 4th Ave. will be closed between SW 2nd St. & the New River.

SW 5 Ave. will remain open.

MOT will be continuous between 8am - 6pm on 3.9.24

SECTION 7: MOT FORM CHECKLIST (Provide one copy of each attachment.)

- Completed Required Signatures Form
- Color aerial(s)/MOT Plan with index overlay
- County and State approvals (if required)
- Crane and Parking Mitigation (if required)
- FDOT Index MUTCD Reference Drawing(s)
- Certification(s) for Traffic Control Technician or Traffic Control Supervisor must be embedded on MOT plans along with FDOT indexes/MUTCD documents
- Plan of work (optional, but preferred)

SECTION 8: ADDITIONAL COMMENTS

Please Note: The approval of an MOT application may require up to two weeks from the time that all required documents in the checklist above are received by TAM staff. Any rejected MOT submittal that is corrected and sent back will be considered a new submittal, which may require up to two additional weeks to approve. Additional time may be needed for more complex plans or plans requiring additional coordination/information.

In signing this application, I understand that separate City and/or County and/or State permits may be required for this project. Furthermore, I am aware that I am responsible for ensuring that the project is completed in accordance with the plans and specifications as stipulated in the permit approval condition.

Suhaill Ruano
(APPLICANT SIGNATURE)

Suhaill Ruano, VP of Advancement
(PRINT NAME/TITLE)

1/16/24
(DATE SIGNED)

As a consideration for the permission granted herein, Kids In Distress, Inc (APPLICANT) agrees to indemnify and hold harmless the City of Fort Lauderdale for any damages, claims, or injuries that may result from the MOT plan approved under the PERMIT.

Kids In Distress, Inc
(NAME OF COMPANY)

BY: _____
(COMPANY AUTHORIZED AGENT)

Office Use Only

MOT ID#: _____

ENG Permit#: _____

REQUIRED SIGNATURES FORM

Applicant must collect all required signatures. To expedite processing, individual signatures may be obtained and submitted to MOT@fortlauderdale.gov separately on this page. All signatures and comments must be submitted before two-week review process begins.

MOT APPROVAL
CITY OF FORT LAUDERDALE
TRANSPORTATION AND MOBILITY

<p><u>M. Ferris</u> Print Name</p> <p><u>[Signature]</u> Signature</p> <p>Police Department 1300 W. Broward Boulevard Tel: 954-828-5477 <i>Call for Appointment</i></p> <p>*Required only if MOT includes a detour for any direction of travel.</p>	<p><u>1/22/24</u> (Date)</p>
--	----------------------------------

<p>_____ Print Name</p> <p>_____ Signature</p> <p>Fire Rescue Department 528 N.W. 2nd Street Tel: 954-828-6800 <i>Call for Appointment</i></p> <p>*Required only if MOT includes a detour for any direction of travel.</p>	<p>_____ (Date)</p>
--	-------------------------

<p>_____ Print Name</p> <p>_____ Signature</p> <p>Broward County Traffic Engineering Division 2300 W. Commercial Boulevard Tel: 954-847-2653 <i>Call for Appointment. Walk-ins NOT accepted.</i></p> <p>*Required only if MOT/detour affects Broward County road or intersection.</p>	<p>_____ (Date)</p>
--	-------------------------

After all applicable signatures are collected, applicant should submit the MOT plan and this routing form to the Transportation and Mobility Department at mot@fortlauderdale.gov.

OFFICE USE ONLY

Department Director's Signature (requested by City staff if required)

<p><u>Morgan Dunn</u> Print Name</p> <p><u>Morgan Dunn</u> Signature</p> <p>Transportation and Mobility Department 290 N.E. 3rd Avenue Tel: 954- 828-4997 Email: MOT@fortlauderdale.gov <i>Call for Appointment. Walk-ins and hard copies NOT accepted.</i></p>	<p><u>1/22/24</u> (Date)</p>
---	----------------------------------

<p><u>Milos Majstorovic</u> Signature</p> <p>Transportation and Mobility Department Ben Rogers, Director</p>	<p>_____ (Date)</p>
---	-------------------------

A copy of the final permit and this MOT form shall be kept on site and be made available to the City inspector at all times.

Traffic modifications required for special events shall be coordinated through the Parks and Recreation's Special Events Department. Please call 954-828-4349 or email BHenry@fortlauderdale.gov.

MOT plans for City Capital Improvement Projects shall be coordinated through the City of Fort Lauderdale Public Works Department. Please call 954-828-5772 or email ralvarez@fortlauderdale.gov.

REQUIRED SIGNATURES FORM

Applicant must collect all required signatures. To expedite processing, individual signatures may be obtained and submitted to MOT@fortlauderdale.gov separately on this page. All signatures and comments must be submitted before two-week review process begins.

MOT APPROVAL

**CITY OF FORT LAUDERDALE
TRANSPORTATION AND MOBILITY**

<p>_____ Print Name</p> <p style="text-align: center;">Police Department 1300 W. Broward Boulevard Tel: 954-828-5477 <i>Call for Appointment</i></p> <p>*Required only if MOT includes a detour for any direction of travel.</p>	<p>_____ Signature</p> <p style="text-align: right;">(Date)</p>
---	---

<p><u>Bruce Strandhagen</u> Print Name</p> <p style="text-align: center;">Fire Rescue Department 528 N.W. 2nd Street Tel: 954-828-6800 <i>Call for Appointment</i></p> <p>*Required only if MOT includes a detour for any direction of travel.</p>	<p><i>Bruce Strandhagen</i> Signature</p> <p style="text-align: right;"><u>1/22/24</u> (Date)</p>
--	---

<p>_____ Print Name</p> <p style="text-align: center;">Broward County Traffic Engineering Division 2300 W. Commercial Boulevard Tel: 954-847-2653 <i>Call for Appointment. Walk-ins NOT accepted.</i></p> <p>*Required only if MOT/detour affects Broward County road or intersection.</p>	<p>_____ Signature</p> <p style="text-align: right;">_____ (Date)</p>
---	---

After all applicable signatures are collected, applicant should submit the MOT plan and this routing form to the Transportation and Mobility Department at mot@fortlauderdale.gov.

OFFICE USE ONLY

Department Director's Signature (requested by City staff if required)

<p>_____ Print Name</p> <p style="text-align: center;">Transportation and Mobility Department 290 N.E. 3rd Avenue Tel: 954- 828-4997 Email: MOT@fortlauderdale.gov <i>Call for Appointment. Walk-ins and hard copies NOT accepted.</i></p>	<p>_____ Signature</p> <p style="text-align: right;">_____ (Date)</p>
--	---

<p style="text-align: center;">_____ Signature</p> <p style="text-align: center;">Transportation and Mobility Department Ben Rogers, Director</p>	<p style="text-align: right;">_____ (Date)</p>
--	--

A copy of the final permit and this MOT form shall be kept on site and be made available to the City inspector at all times.

Traffic modifications required for special events shall be coordinated through the Parks and Recreation's Special Events Department. Please call 954-828-4349 or email BHenry@fortlauderdale.gov.

MOT plans for City Capital Improvement Projects shall be coordinated through the City of Fort Lauderdale Public Works Department. Please call 954-828-5772 or email ralvarez@fortlauderdale.gov.

**MOT APPROVAL
CITY OF FORT LAUDERDALE
TRANSPORTATION AND MOBILITY**

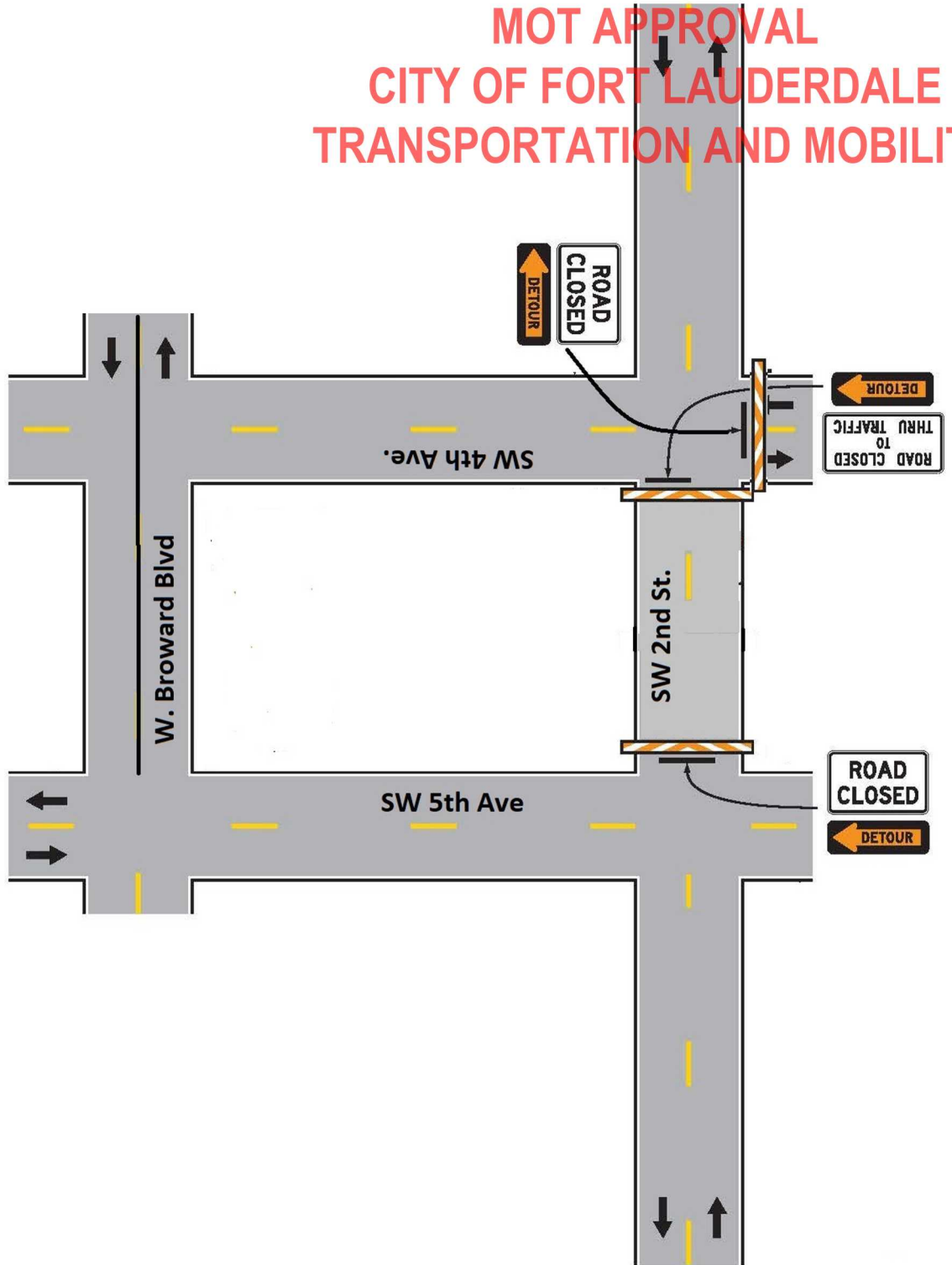

Notes for Figure 6H-20—Typical Application 20 Detour for a Closed Street

Guidance:

1. *This plan should be used for streets without posted route numbers.*
2. *On multi-lane streets, Detour signs with an Advance Turn Arrow should be used in advance of a turn.*

Option:

3. Flashing warning lights and/or flags may be used to call attention to the advance warning signs.
4. Flashing warning lights may be used on Type 3 Barricades.
5. Detour signs may be located on the far side of intersections. A Detour sign with an advance arrow may be used in advance of a turn.
6. A Street Name sign may be mounted with the Detour sign. The Street Name sign may be either white on green or black on orange.

Standard:

7. **When used, the Street Name sign shall be placed above the Detour sign.**

Support:

8. See Figure 6H-9 for the information for detouring a numbered highway.

Figure 6H-20. Detour for a Closed Street (TA-20)

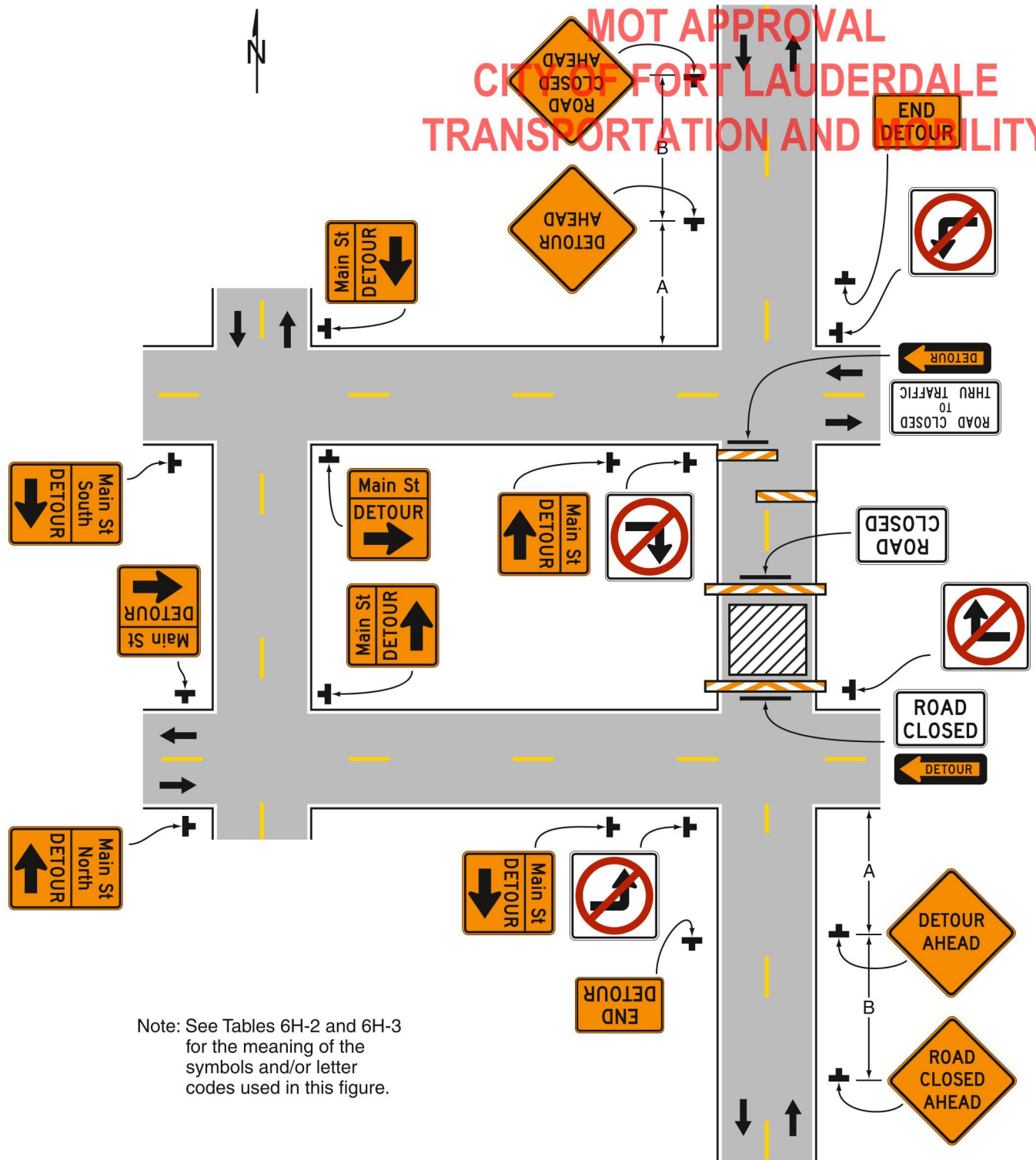

Typical Application 20





TAM-MOT-24010058 - Duckfest Derby

Final Audit Report

2024-01-23

Created:	2024-01-22
By:	Morgan Dunn (MDunn@fortlauderdale.gov)
Status:	Signed
Transaction ID:	CBJCHBCAABAABC6VA9ONAIjZWR9BDg8aXjx-qq2KIYep

"TAM-MOT-24010058 - Duckfest Derby" History

-  Document created by Morgan Dunn (MDunn@fortlauderdale.gov)
2024-01-22 - 9:52:25 PM GMT- IP address: 50.232.252.93
-  Document emailed to Milos Majstorovic (MMajstorovic@fortlauderdale.gov) for signature
2024-01-22 - 9:52:43 PM GMT
-  Email viewed by Milos Majstorovic (MMajstorovic@fortlauderdale.gov)
2024-01-23 - 10:38:51 PM GMT- IP address: 104.47.64.254
-  Document e-signed by Milos Majstorovic (MMajstorovic@fortlauderdale.gov)
Signature Date: 2024-01-23 - 10:41:03 PM GMT - Time Source: server- IP address: 50.232.252.93
-  Agreement completed.
2024-01-23 - 10:41:03 PM GMT

