

MAINTENANCE OF TRAFFIC (MOT) FORM

MOT APPROVAL

CITY OF FORT LAUDERDALE

TRANSPORTATION AND MOBILITY

SECTION 1: APPLICANT INFORMATION

Applicant Name: Atlantic Studios, Inc. Applicant Phone: (954) 785-7475

Applicant Email: cwg@atlanticstudios.com

Applicant Address: 434 NW 1st Avenue, Suite #504, Fort Lauderdale, FL. 33301
(Address, City, State, Zip Code)

City Project Manager (if applicable): _____ Phone: _____

Agency responsible for this project: City County FDOT Other: Atlantic Studios, Inc.

On-site/Emergency Contact Phone: (954) 785-7475 or (954) 788-3467

SECTION 2: PROJECT INFORMATION

ENG Permit # (obtain from Department of Sustainable Development (DSD)): Special Event

Project Name: Food In Motion

Project Address: Esplanade Park - 400 SW 2nd Street, Fort Lauderdale, FL. 33312
(Address, City, State, Zip Code)

Specific Dates and Times Requested for MOT Implementation:

Please identify a start date that is at least two weeks from the submittal date. The approval of an MOT application may require up to two weeks from the time that all required documents are received by TAM staff.

Begin Date: 01/19/24, 02/02/24, 02/16/24, 03/01/24, 03/15/24

Begin Time: 1:00PM

End Date: 01/20/24, 02/03/24, 02/17/24, 03/02/24, 03/16/24

End Time: 2:00AM

SECTION 3: PROJECT DETAILS

- Partial or Shoulder Closure
- Full Road Closure (detour): Under 72 Hours
- Sidewalk Closure: Under 72 Hours
- Full Road/Sidewalk Closure: More than 72 Hours

Daily Setup/ Breakdown YES NO

Using Crane in ROW* YES NO

Parking Meters Impacted* YES NO

*Crane and parking meter mitigation must be done prior to MOT approval. Please refer to the MOT Guidelines for crane definitions.

SECTION 4: TYPE OF WORK DESCRIPTION

Please make sure to include the following information in the description:

- List the names of affected streets and the nearest intersection. Use complete street names, including directionals.
- Describe the nature of the construction and any phasing plans. A separate MOT application is required for each phase.
- Describe any specific safety hazards that the work may produce during construction (i.e., large holes, etc.).

Food In Motion is an evening-time food & green market styled event that began in 2014 at Peter Feldman Park.

FIM has been held monthly since 2014 - MOT Plans has been the detour schedule provider.

Event related road closure: SW 2nd St. (Himmarshe), closed b/t SW 4th Ave. & SW 5th Ave.

No road work or safety hazards - Purpose of closure: Increase event footprint & facilitate the inclusion of food trucks / MFDVs.

SECTION 5: FDOT DESIGN STANDARD INDEX DRAWING NUMBERS/MUTCD TYPICAL APPLICATION

(State which FDOT Standard Index 600 series will be followed. The indexes must include the north arrow and the names of the main and cross streets. Also, state whether trenches will be covered or backfilled during non-working hours.)

TA-20

MAINTENANCE OF TRAFFIC (MOT) FORM

MOT APPROVAL

CITY OF FORT LAUDERDALE

TRANSPORTATION AND MOBILITY

SECTION 6: MOT DESCRIPTION

Please make sure to include the following information in the description:

- List the lanes that will be open and closed on each street and describe any necessary detours in detail. If detours are not required, please state that below.
- State if flagmen will be provided.
- State if the MOT will be continuous or intermittent. If intermittent, state the times of the day the MOT will be in effect.
- State any other special considerations related to this request.

East & westbound lanes of SW 2nd Street b/t SW 4th Ave & SW 5th Ave, Also SW 4th Ave from SW 2nd Street, east to the river.

Flagmen are not provided for this MOT, as they are not indicated on the attached plan.

MOT will only be in-place for aprox. 12 hours, on the 1st & 3rd Friday night of each month, from 1:00PM - 2:00AM (or sooner)

FLPD will provide special detail services.

SECTION 7: MOT FORM CHECKLIST (Provide one copy of each attachment.)

- Completed Required Signatures Form
- Certification(s) for Traffic Control Technician or Traffic Control Supervisor must be embedded on MOT plans along with FDOT indexes/MUTCD documents
- Color aerial(s)/MOT Plan with index overlay
- County and State approvals (if required)
- Crane and Parking Mitigation (if required)
- Plan of work (optional, but preferred)
- FDOT Index MUTCD Reference Drawing(s)

SECTION 8: ADDITIONAL COMMENTS

This is a legacy event that has operated on a monthly basis since 2014, in a safe and orderly manner.

Please Note: The approval of an MOT application may require up to two weeks from the time that all required documents in the checklist above are received by TAM staff. Any rejected MOT submittal that is corrected and sent back will be considered a new submittal, which may require up to two additional weeks to approve. Additional time may be needed for more complex plans or plans requiring additional coordination/information.

In signing this application, I understand that separate City and/or County and/or State permits may be required for this project. Furthermore, I am aware that I am responsible for ensuring that the project is completed in accordance with the plans and specifications as stipulated in the permit approval condition.



(APPLICANT SIGNATURE)

Chris Gaidry | President

(PRINT NAME/TITLE)

01/04/24

(DATE SIGNED)

As a consideration for the permission granted herein, Atlantic Studios, Inc. agrees to indemnify and hold harmless the City of Fort Lauderdale for any damages, claims, or injuries that may result from the MOT plan approved under the PERMIT.

Atlantic Studios, Inc.

(NAME OF COMPANY)

BY: Chris Gaidry

(COMPANY AUTHORIZED AGENT)

Office Use Only

MOT ID#: _____

GMOT Permit#: _____

REQUIRED SIGNATURES FORM

Applicant must collect all required signatures. To expedite processing, individual signatures may be obtained and submitted to MOT@fortlauderdale.gov separately on this page. All signatures and comments must be submitted before two-week review process begins.

MOT APPROVAL
CITY OF FORT LAUDERDALE
TRANSPORTATION AND MOBILITY

<p>_____ Print Name</p> <p>Police Department 1300 W. Broward Boulevard Tel: 954-828-5477 Call for Appointment *Required only if MOT includes a detour for any direction of travel.</p>	<p>_____ Signature</p> <p>_____ (Date)</p>
---	--

<p>_____ Print Name</p> <p>Fire Rescue Department 528 N.W. 2nd Street Tel: 954-828-6864 Email: CBotting@fortlauderdale.gov Call for Appointment *Required only if MOT includes a detour for any direction of travel.</p>	<p>_____ Signature</p> <p>_____ (Date)</p>
---	--

<p>_____ Print Name</p> <p>Broward County Traffic Engineering Division 2300 W. Commercial Boulevard Tel: 954-847-2653 Call for appointment. Walk-ins NOT accepted. *Required only if MOT/detour affects Broward County road or intersection.</p>	<p>_____ Signature</p> <p>_____ (Date)</p>
--	--

After all applicable signatures are collected, applicant should submit the MOT plan and this routing form to the Transportation and Mobility Department at mot@fortlauderdale.gov.

OFFICE USE ONLY

Department Director's Signature (requested by City staff if required)

<p>_____ Print Name</p> <p>Transportation and Mobility Department 290 N.E. 3rd Avenue Tel: 954- 828-4997 Email: MOT@fortlauderdale.gov Call for Appointment: Walk-ins NOT accepted.</p>	<p>_____ Signature</p> <p>_____ (Date)</p>
--	--

<p>_____ Signature</p> <p>Transportation and Mobility Department Ben Rogers, Director</p>	<p>_____ (Date)</p>
--	-------------------------

A copy of the final permit and this MOT form shall be kept on site and be made available to the City inspector at all times.

Traffic modifications required for special events shall be coordinated through the Parks and Recreation's Special Events Department. Please call 954-828-6075 or email basmith@fortlauderdale.gov.

MOT plans for City Capital Improvement Projects shall be coordinated through the City of Fort Lauderdale Public Works Department. Please call 954-828 -5772 or email ralvarez@fortlauderdale.gov.

REQUIRED SIGNATURES FORM

Applicant must collect all required signatures. To expedite processing, individual signatures may be obtained and submitted to MOT@fortlauderdale.gov separately on this page. All signatures and comments must be submitted before two-week review process begins.

MOT APPROVAL
CITY OF FORT LAUDERDALE

TRANSPORTATION AND MOBILITY

<p>_____ Print Name</p> <p style="text-align: center;">Police Department 1300 W. Broward Boulevard Tel: 954-828-5477 <i>Call for Appointment</i></p> <p>*Required only if MOT includes a detour for any direction of travel.</p>	<p>_____ Signature</p> <p style="text-align: center;">_____ (Date)</p>
---	--

<p>_____ Print Name</p> <p style="text-align: center;">Fire Rescue Department 528 N.W. 2nd Street Tel: 954-828-6800 <i>Call for Appointment</i></p> <p>*Required only if MOT includes a detour for any direction of travel.</p>	<p><i>Bruce Strandhagen</i> Signature</p> <p style="text-align: center;">_____ 1/12/24 (Date)</p>
---	---

<p>_____ Print Name</p> <p style="text-align: center;">Broward County Traffic Engineering Division 2300 W. Commercial Boulevard Tel: 954-847-2653 <i>Call for Appointment. Walk-ins NOT accepted.</i></p> <p>*Required only if MOT/detour affects Broward County road or intersection.</p>	<p>_____ Signature</p> <p style="text-align: center;">_____ (Date)</p>
---	--

After all applicable signatures are collected, applicant should submit the MOT plan and this routing form to the Transportation and Mobility Department at mot@fortlauderdale.gov.

OFFICE USE ONLY

Department Director's Signature (requested by City staff if required)

<p>_____ Print Name</p> <p style="text-align: center;">Transportation and Mobility Department 290 N.E. 3rd Avenue Tel: 954- 828-4997 Email: MOT@fortlauderdale.gov <i>Call for Appointment. Walk-ins and hard copies NOT accepted.</i></p>	<p>_____ Signature</p> <p style="text-align: center;">_____ (Date)</p>
--	--

<p style="text-align: center;">_____ Signature</p> <p style="text-align: center;">Transportation and Mobility Department Ben Rogers, Director</p>	<p style="text-align: center;">_____ (Date)</p>
--	---

A copy of the final permit and this MOT form shall be kept on site and be made available to the City inspector at all times.

Traffic modifications required for special events shall be coordinated through the Parks and Recreation's Special Events Department. Please call 954-828-4349 or email BHenry@fortlauderdale.gov.

MOT plans for City Capital Improvement Projects shall be coordinated through the City of Fort Lauderdale Public Works Department. Please call 954-828-5772 or email ralvarez@fortlauderdale.gov.



SW 5TH AVE.

FOOD INNOVATION

SITE PLAN / ESPLANADE PARK

ROAD BLOCK

ROAD BLOCK

ROAD BLOCK

**MOT APPROVAL
CITY OF FORT LAUDERDALE
TRANSPORTATION AND MOBILITY**

LEGEND:

-  = 10X10 POPUP CANOPY
-  = RESTROOMS
-  = HOUSE POWER



SW 4TH AVE.

EQUIPMENT STAGING / STAFF PARKING

STAGE

NEW RIVER

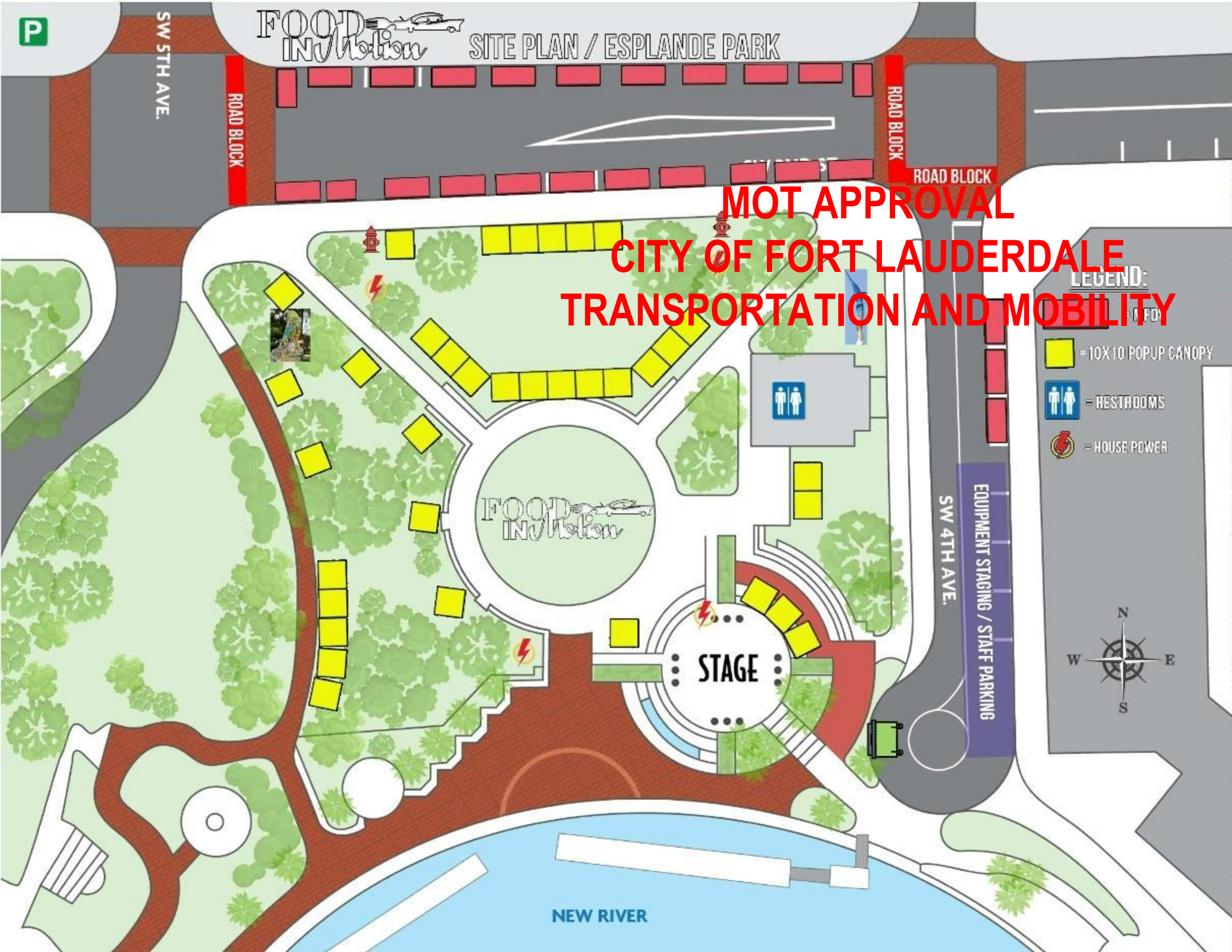

**MOT APPROVAL
CITY OF FORT LAUDERDALE
TRANSPORTATION AND MOBILITY**

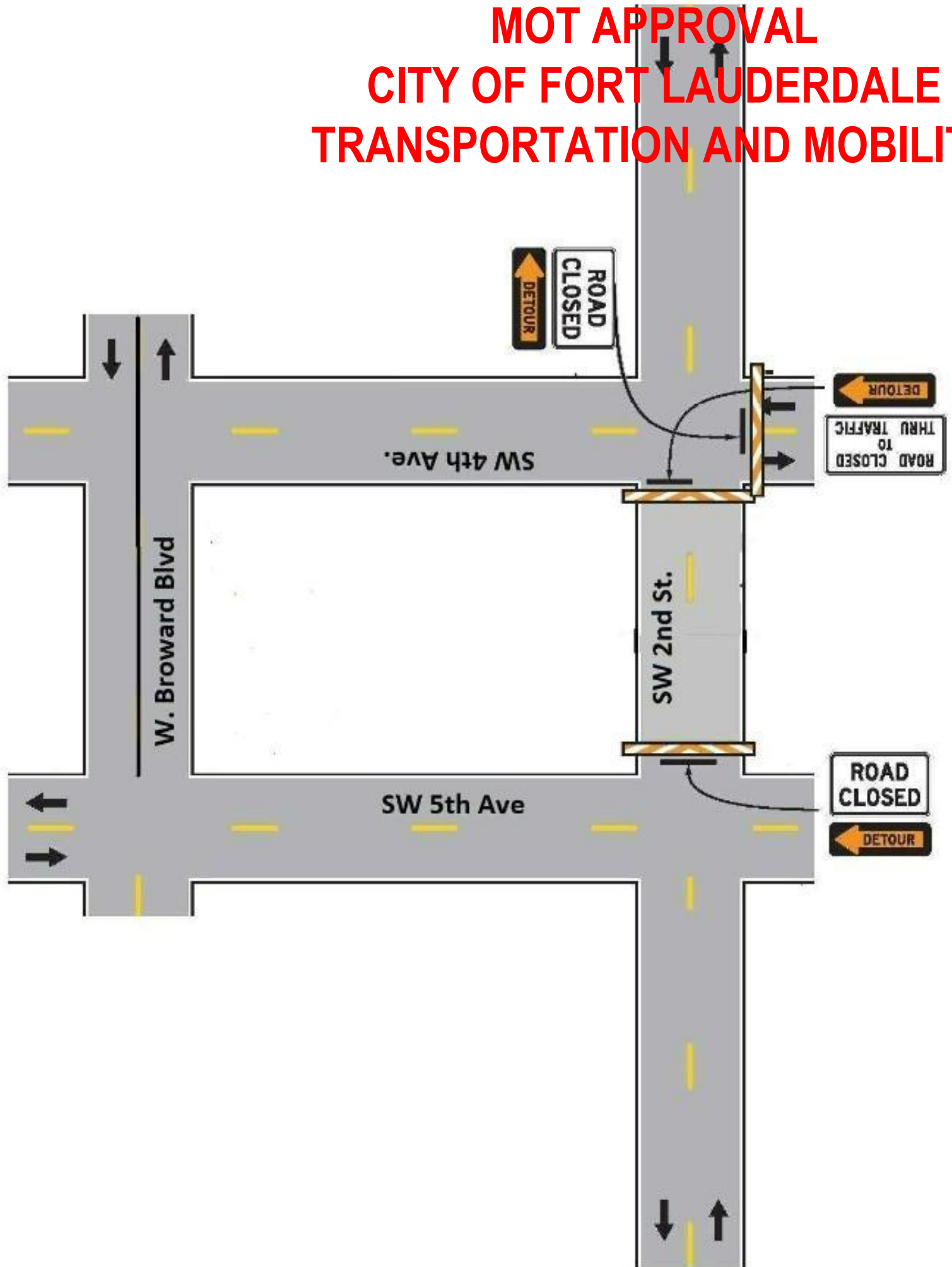

Notes for Figure 6H-20—Typical Application 20 Detour for a Closed Street

Guidance:

1. *This plan should be used for streets without posted route numbers.*
2. *On multi-lane streets, Detour signs with an Advance Turn Arrow should be used in advance of a turn.*

Option:

3. Flashing warning lights and/or flags may be used to call attention to the advance warning signs.
4. Flashing warning lights may be used on Type 3 Barricades.
5. Detour signs may be located on the far side of intersections. A Detour sign with an advance arrow may be used in advance of a turn.
6. A Street Name sign may be mounted with the Detour sign. The Street Name sign may be either white on green or black on orange.

Standard:

7. **When used, the Street Name sign shall be placed above the Detour sign.**

Support:

8. See Figure 6H-9 for the information for detouring a numbered highway.

MOT APPROVAL
CITY OF FORT LAUDERDALE
TRANSPORTATION AND MOBILITY





TAM-MOT-24010032 - Food In Motion Jan - March

Final Audit Report

2024-01-18

Created:	2024-01-17
By:	Morgan Dunn (MDunn@fortlauderdale.gov)
Status:	Signed
Transaction ID:	CBJCHBCAABAABVhcDvH5acXKJpb0I0KUBaxTx-Wm1oniV

"TAM-MOT-24010032 - Food In Motion Jan - March" History

-  Document created by Morgan Dunn (MDunn@fortlauderdale.gov)
2024-01-17 - 6:52:30 PM GMT- IP address: 50.232.252.93
-  Document emailed to Milos Majstorovic (MMajstorovic@fortlauderdale.gov) for signature
2024-01-17 - 6:52:52 PM GMT
-  Email viewed by Milos Majstorovic (MMajstorovic@fortlauderdale.gov)
2024-01-18 - 2:59:18 AM GMT- IP address: 66.176.25.69
-  Document e-signed by Milos Majstorovic (MMajstorovic@fortlauderdale.gov)
Signature Date: 2024-01-18 - 3:00:29 AM GMT - Time Source: server- IP address: 66.176.25.69
-  Agreement completed.
2024-01-18 - 3:00:29 AM GMT



Powered by
Adobe
Acrobat Sign