

MAINTENANCE OF TRAFFIC (MOT) FORM

MOT APPROVAL

CITY OF FORT LAUDERDALE

TRANSPORTATION AND MOBILITY

SECTION 1: APPLICANT INFORMATION

Applicant Name: Riverwalk Fort Lauderdale Applicant Phone: 954-205-1141

Applicant Email: genia@goriverwalk.com

Applicant Address: 888 E. Las Olas Blvd, Ste. 210, Fort Lauderdale, FL 33301
(Address, City, State, Zip Code)

City Project Manager (if applicable): _____ Phone: _____

Agency responsible for this project: City County FDOT Other: Riverwalk Fort Lauderdale

On-site/Emergency Contact Phone: 954-205-9648

SECTION 2: PROJECT INFORMATION

GMOT Permit # (obtain from Department of Sustainable Development (DSD)): Special Event

Project Name: Riverwalk 14th Annual Stone Crab & Seafood Festival

Project Address: 400 SW 2nd St., Fort Lauderdale, FL 33301
(Address, City, State, Zip Code)

Specific Dates and Times Requested for MOT Implementation:

Please identify a start date that is at least two weeks from the submittal date. The approval of an MOT application may require up to two weeks from the time that all required documents are received by TAM staff.

Begin Date: 01/05/2024

Begin Time: 7:00am

End Date: 01/08/2024

End Time: 5:00pm

SECTION 3: PROJECT DETAILS

Partial Closure

Daily Setup/ Breakdown YES NO

Full Road Closure (detour): Under 72 Hours

Using Crane in ROW* YES NO

Sidewalk Closure: Under 72 Hours

Parking Meters Impacted* YES NO

Full Road/Sidewalk Closure: More than 72 Hours

*Crane and parking meter mitigation must be done prior to MOT approval.

SECTION 4: TYPE OF WORK DESCRIPTION

Please make sure to include the following information in the description:

- List the names of affected streets and the nearest intersection. Use complete street names, including directionals.
- Describe the nature of the construction and any phasing plans. A separate MOT application is required for each phase.
- Describe any specific safety hazards that the work may produce during construction (i.e., large holes, etc.).

Saturday 01/07/2024 - SW 2nd St between SW 4th Ave and SW 5th Ave, and SW 4th Ave between SW 2nd St and the New River

Special event, Stone Crab & Seafood Festival by Riverwalk Fort Lauderdale. Food trucks and vendors on street in parking spaces

Friday 01/06/2024-Monday 01/08/2024 - Dumpster on Southbound Ln. of SW 4th Avenue between Broward Blvd. and SW 2nd S

SECTION 5: FDOT DESIGN STANDARD INDEX DRAWING NUMBERS/MUTCD TYPICAL APPLICATION

(State which FDOT Standard Index 600 series will be followed. The indexes must include the north arrow and the name of the main and cross streets. Also, state whether trenches will be covered or backfilled during non-working hours.)

TA-20

MAINTENANCE OF TRAFFIC (MOT) FORM

MOT APPROVAL
CITY OF FORT LAUDERDALE
TRANSPORTATION AND MOBILITY

SECTION 6: MOT DESCRIPTION

Please make sure to include the following information in the description:
• List the lanes that will be open and closed on each street and describe any necessary detours in detail. If detours are not required, please state that below.
• State if flagmen will be provided.
• State if the MOT will be continuous or intermittent. If intermittent, state the times of the day the MOT will be in effect.
• State any other special considerations related to this request.
Saturday 01/06/2024 SW 2nd St. will be closed between SW 4th Ave. and SW 5th Ave.
SW 4th Ave. will be closed between SW 2nd St. & the New River.
SW 5 Ave. will remain open.
Friday 01/05/2024-Monday 01/08/2024 Southbound lane of SW 4th Avenue between Broward Blvd. and SW 2nd Street will be partially closed, with dumpster placed on street. No flagmen will be provided. Anticipated as early 8:00am Friday 01/05/2024 to as late as 5:00pm Monday 01/08/2024

SECTION 7: MOT FORM CHECKLIST (Provide one copy of each attachment.)

- Completed Required Signatures Form
- Color aerial(s)/MOT Plan with index overlay
- County and State approvals (if required)
- Crane and Parking Mitigation (if required)
- FDOT Index MUTCD Reference Drawing(s)
- Certification(s) for Traffic Control Technician or Traffic Control Supervisor must be embedded on MOT plans along with FDOT indexes/MUTCD documents
- Plan of work (optional, but preferred)

SECTION 8: ADDITIONAL COMMENTS

Please Note: The approval of an MOT application may require up to two weeks from the time that all required documents in the checklist above are received by TAM staff. Any rejected MOT submittal that is corrected and sent back will be considered a new submittal, which may require up to two additional weeks to approve. Additional time may be needed for more complex plans or plans requiring additional coordination/information.

In signing this application, I understand that separate City and/or County and/or State permits may be required for this project. Furthermore, I am aware that I am responsible for ensuring that the project is completed in accordance with the plans and specifications as stipulated in the permit approval condition.

Eugenia Duncan Ellis

(APPLICANT SIGNATURE)
01/16/23

(DATE SIGNED)

Eugenia Duncan Ellis, President/CEO

(PRINT NAME/TITLE)

As a consideration for the permission granted herein, Eugenia Duncan Ellis agrees to indemnify and hold harmless the City of Fort Lauderdale for any damages, claims, or injuries that may result from the MOT plan approved under the PERMIT.

Riverwalk Fort Lauderdale

(NAME OF COMPANY)

BY: Eugenia Duncal Ellis

(COMPANY AUTHORIZED AGENT)

Office Use Only

MOT ID#: _____ GMOT Permit#: _____

REQUIRED SIGNATURES FORM

Applicant must collect all required signatures. To expedite processing, individual signatures may be obtained and submitted to MOT@fortlauderdale.gov separately on this page. All signatures and comments must be submitted before two-week review process begins.

MOT APPROVAL
CITY OF FORT LAUDERDALE
TRANSPORTATION AND MOBILITY

<p><u>M. Ferrer</u> Print Name</p> <p>Police Department 1300 W. Broward Boulevard Tel: 954-828-5477 Call for Appointment *Required only if MOT includes a detour for any direction of travel.</p>	<p><u>[Signature]</u> Signature</p> <p>_____ (Date)</p>
--	---

<p>_____ Print Name</p> <p>Fire Rescue Department 528 N.W. 2nd Street Tel: 954-828-6864 Email: CBotting@fortlauderdale.gov Call for Appointment *Required only if MOT includes a detour for any direction of travel.</p>	<p>_____ Signature</p> <p>_____ (Date)</p>
---	--

<p>_____ Print Name</p> <p>Broward County Traffic Engineering Division 2300 W. Commercial Boulevard Tel: 954-847-2653 Call for appointment. Walk-ins NOT accepted. *Required only if MOT/detour affects Broward County road or intersection.</p>	<p>_____ Signature</p> <p>_____ (Date)</p>
--	--

After all applicable signatures are collected, applicant should submit the MOT plan and this routing form to the Transportation and Mobility Department at mot@fortlauderdale.gov.

OFFICE USE ONLY	
Department Director's Signature (requested by City staff if required)	
<p><u>Morgan Dunn</u> Print Name</p> <p><u>Morgan Dunn</u> Signature</p> <p>Transportation and Mobility Department 290 N.E. 3rd Avenue Tel: 954-828-4997 Email: MOT@fortlauderdale.gov Call for Appointment. Walk-ins NOT accepted.</p>	<p><u>12/20/23</u> (Date)</p>
<p><u>Milos Majstorovic</u> Signature</p> <p>Transportation and Mobility Department Ben Rogers, Director</p>	<p>_____ (Date)</p>

A copy of the final permit and this MOT form shall be kept on site and be made available to the City inspector at all times.

Traffic modifications required for special events shall be coordinated through the Parks and Recreation's Special Events Department. Please call 954-828-6075 or email basmith@fortlauderdale.gov.

MOT plans for City Capital Improvement Projects shall be coordinated through the City of Fort Lauderdale Public Works Department. Please call 954-828-5772 or email ralvarez@fortlauderdale.gov.

Office Use Only

MOT ID#: _____ GMOT Permit#: _____

REQUIRED SIGNATURES FORM

Applicant must collect all required signatures. To expedite processing, individual signatures may be obtained and submitted to MOT@fortlauderdale.gov separately on this page. All signatures and comments must be submitted before two-week review process begins.

MOT APPROVAL
CITY OF FORT LAUDERDALE
TRANSPORTATION AND MOBILITY

_____ Print Name Police Department 1300 W. Broward Boulevard Tel: 954-828-5477 Call for Appointment *Required only if MOT includes a detour for any direction of travel.	_____ Signature	_____ (Date)
--	--------------------	-----------------

_____ Print Name Fire Rescue Department 528 N.W. 2 nd Street Tel: 954-828-6864 Email: CBotting@fortlauderdale.gov Call for Appointment *Required only if MOT includes a detour for any direction of travel.	_____ Signature <i>Bruce Strandhagen</i>	_____ 12/11/23 (Date)
---	--	-----------------------------

_____ Print Name Broward County Traffic Engineering Division 2300 W. Commercial Boulevard Tel: 954-847-2653 Call for appointment. Walk-ins NOT accepted. *Required only if MOT/detour affects Broward County road or intersection.	_____ Signature	_____ (Date)
---	--------------------	-----------------

After all applicable signatures are collected, applicant should submit the MOT plan and this routing form to the Transportation and Mobility Department at mot@fortlauderdale.gov.

OFFICE USE ONLY

Department Director's Signature (requested by City staff if required)

_____ Print Name Transportation and Mobility Department 290 N.E. 3 rd Avenue Tel: 954- 828-4997 Email: MOT@fortlauderdale.gov Call for Appointment. Walk-ins NOT accepted.	_____ Signature	_____ (Date)
---	--------------------	-----------------

_____ Signature Transportation and Mobility Department Ben Rogers, Director	_____ (Date)
---	-----------------

A copy of the final permit and this MOT form shall be kept on site and be made available to the City inspector at all times. Traffic modifications required for special events shall be coordinated through the Parks and Recreation's Special Events Department. Please call 954-828-6075 or email basmith@fortlauderdale.gov. MOT plans for City Capital Improvement Projects shall be coordinated through the City of Fort Lauderdale Public Works Department. Please call 954-828 -5772 or email ralvarez@fortlauderdale.gov.

**MOT APPROVAL
CITY OF FORT LAUDERDALE
TRANSPORTATION AND MOBILITY**

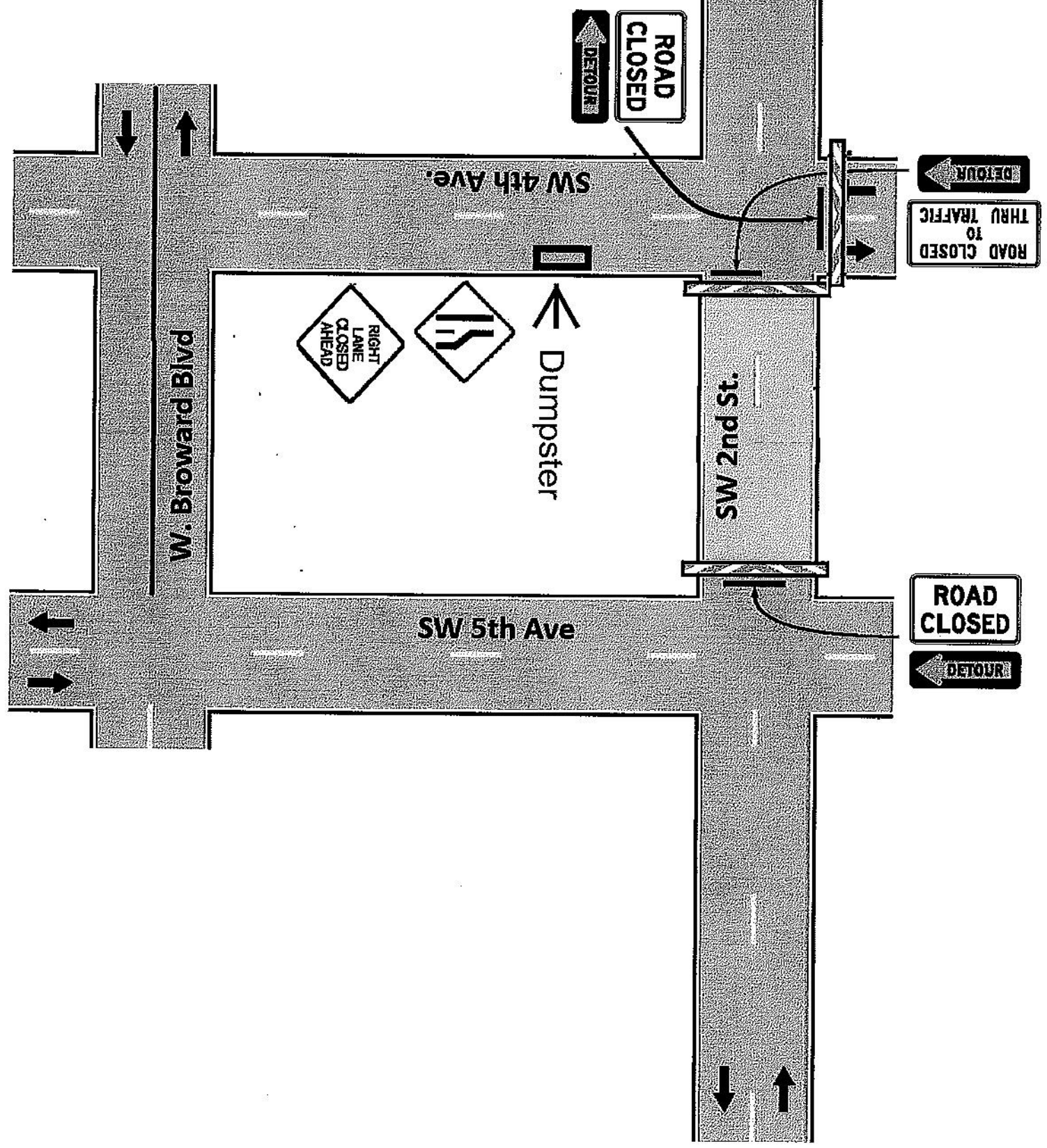

**Notes for Figure 6H-20—Typical Application 20
Detour for a Closed Street**

Guidance:

1. *This plan should be used for streets without posted route numbers.*
2. *On multi-lane streets, Detour signs with an Advance Turn Arrow should be used in advance of a turn.*

Option:

3. Flashing warning lights and/or flags may be used to call attention to the advance warning signs.
4. Flashing warning lights may be used on Type 3 Barricades.
5. Detour signs may be located on the far side of intersections. A Detour sign with an advance arrow may be used in advance of a turn.
6. A Street Name sign may be mounted with the Detour sign. The Street Name sign may be either white on green or black on orange.

Standard:

- 7. When used, the Street Name sign shall be placed above the Detour sign.**

Support:

8. See Figure 6H-9 for the information for detouring a numbered highway.

**MOT APPROVAL
CITY OF FORT LAUDERDALE
TRANSPORTATION AND MOBILITY**

Figure 6H-20. Detour for a Closed Street (TA-20)

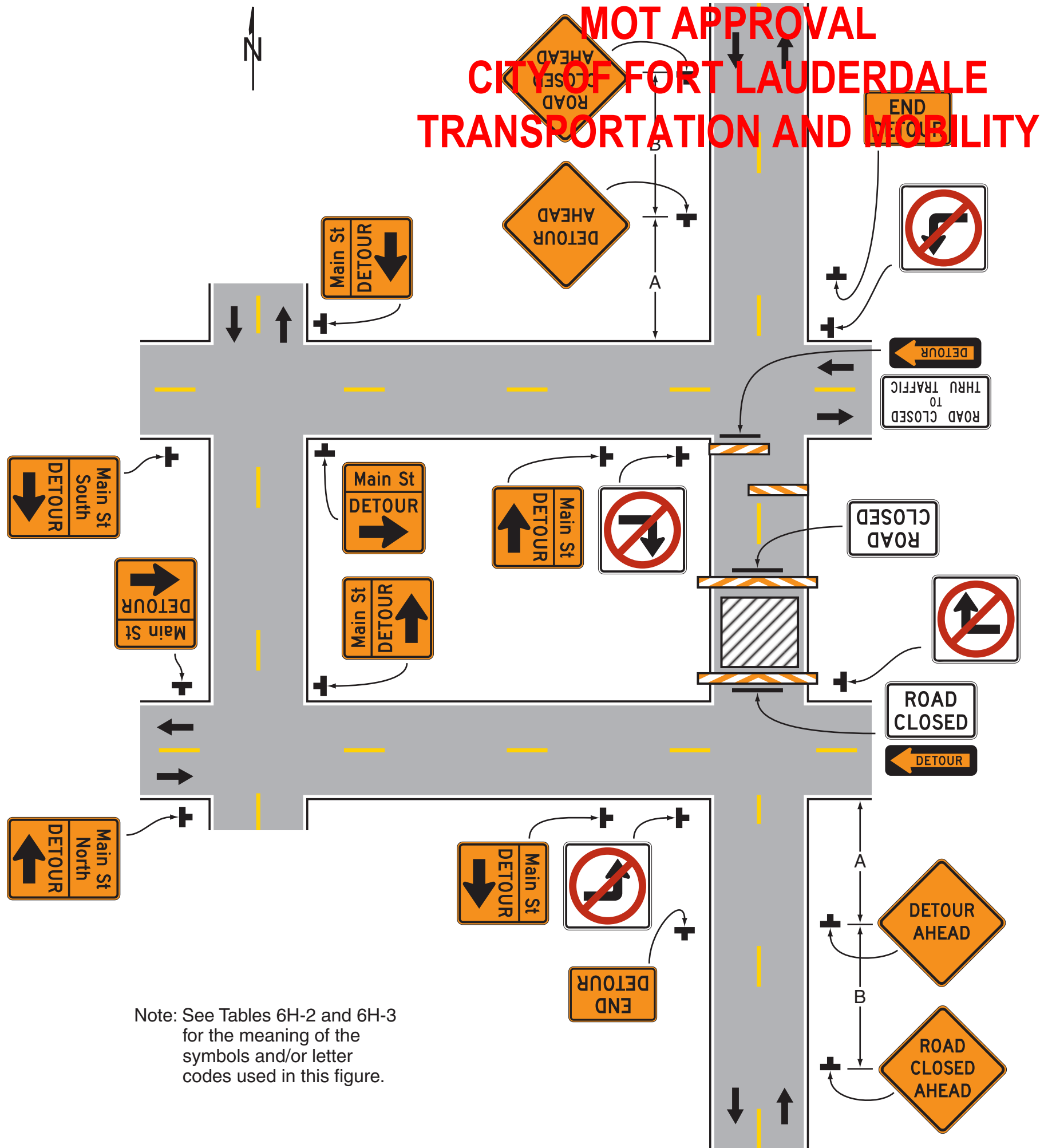

**MOT APPROVAL
CITY OF FORT LAUDERDALE
TRANSPORTATION AND MOBILITY**

Note: See Tables 6H-2 and 6H-3 for the meaning of the symbols and/or letter codes used in this figure.

Typical Application 20

MOT APPROVAL CITY OF FORT LAUDERDALE TRANSPORTATION AND MOBILITY

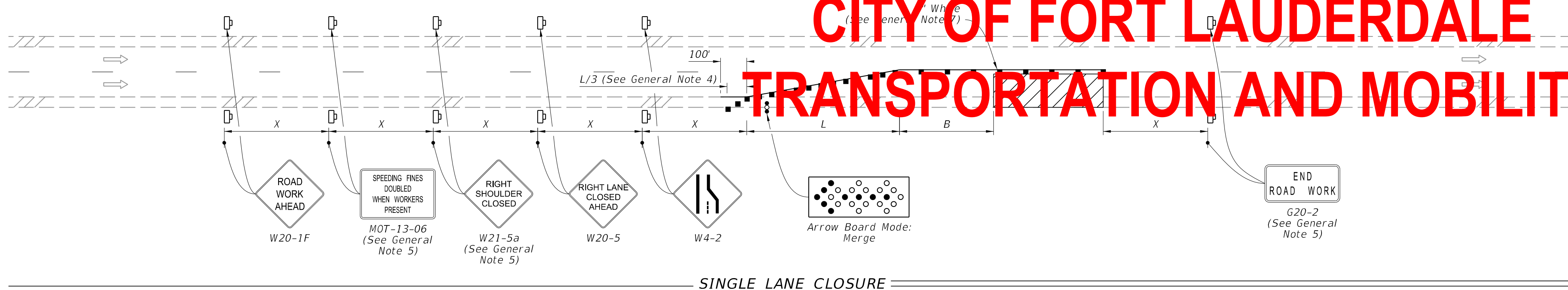

SYMBOLS:

- Work Area
- Channelizing Device (See Index 102-600)
- Work Zone Sign
- Arrow Board
- Lane Identification and Direction of Traffic

GENERAL NOTE:

1. L = Taper Length
 B = Buffer Length
 X = Work Zone Sign Distance
See Index 102-600 for " L ", " B ", " X ", and channelizing device spacing values.
2. On undivided highways the median signs as shown are to be omitted.
3. On limited access facilities, omit "Right Shoulder Closed" signs (W21-5a) and associated work zone sign spacing distances.
4. If the paved shoulder is less than 4' in width, omit the taper and channelizing devices from the paved shoulder.
5. The "Speeding Fines Doubled When Workers Present" signs (MOT-13-06) and "End Road Work" signs (G20-2) and "Right Shoulder Closed" (W21-5a), along with associated work zone sign distances, may be omitted when the work operation will be in place for 24 hours or less. For Single Lane Closures, arrow boards and buffer (B) may also be omitted when the work operation will be in place for 60 minutes or less and the speed limit is 45 mph or less.
6. Use inverted plan of the illustrations for work on left side of roadways.
7. Temporary pavement markings may be omitted when the work operation is in place for 3 days or less.

2/2/2023 10:34:25 AM

LAST REVISION 11/01/21	REVISION	DESCRIPTION:		FY 2023-24 STANDARD PLANS	MULTILANE ROADWAY, LANE CLOSURES	INDEX 102-613	SHEET 1 of 5
---------------------------	----------	--------------	--	------------------------------	----------------------------------	------------------	-----------------





TAM-MOT-23120022 - Riverwalk Stone Crab & Seafood Fest

Final Audit Report

2023-12-20

Created:	2023-12-20
By:	Morgan Dunn (MDunn@fortlauderdale.gov)
Status:	Signed
Transaction ID:	CBJCHBCAABAAeaclbpe1KVVz19Seu-qy6ifsRkuC4Nrv

"TAM-MOT-23120022 - Riverwalk Stone Crab & Seafood Fest" History

-  Document created by Morgan Dunn (MDunn@fortlauderdale.gov)
2023-12-20 - 3:54:48 PM GMT- IP address: 50.232.252.93
-  Document emailed to Milos Majstorovic (MMajstorovic@fortlauderdale.gov) for signature
2023-12-20 - 3:55:29 PM GMT
-  Email viewed by Milos Majstorovic (MMajstorovic@fortlauderdale.gov)
2023-12-20 - 3:58:04 PM GMT- IP address: 104.47.65.254
-  Document e-signed by Milos Majstorovic (MMajstorovic@fortlauderdale.gov)
Signature Date: 2023-12-20 - 4:03:43 PM GMT - Time Source: server- IP address: 50.232.252.93
-  Agreement completed.
2023-12-20 - 4:03:43 PM GMT



Powered by
Adobe
Acrobat Sign