

MAINTENANCE OF TRAFFIC (MOT) FORM

MOT APPROVAL
CITY OF FORT LAUDERDALE
TRANSPORTATION AND MOBILITY

SECTION 1: APPLICANT INFORMATION

Applicant Name: Debbie Bylica Applicant Phone: 954-828-4622
Applicant Email: dbylica@fortlauderdale.gov
Applicant Address: 1350 G. Harold Martin Drive Fort Lauderdale, FL 33304
(Address, City, State, Zip Code)
City Project Manager (if applicable): Debbie Bylica Phone: 954-828-4622
Agency responsible for this project: City County FDOT Other: _____
On-site/Emergency Contact Phone: Debbie Bylica (954) 683-3357

SECTION 2: PROJECT INFORMATION

GMOT Permit # (obtain from Department of Sustainable Development (DSD)): City Special Event
Project Name: New Year's Eve Downtown Countdown
Project Address: SW 2nd Street from SW 7th Avenue east to SW 1st Avenue Fort Lauderdale, FL
(Address, City, State, Zip Code)

Specific Dates and Times Requested for MOT Implementation:

Please identify a start date that is at least two weeks from the submittal date. The approval of an MOT application may require up to two weeks from the time that all required documents are received by TAM staff.

Begin Date: Friday, December 29, 2023 Begin Time: 7:00 am
End Date: Monday, January 1, 2024 End Time: 6:00 am

SECTION 3: PROJECT DETAILS

Partial Closure
 Full Road Closure (detour): Under 72 Hours
 Sidewalk Closure: Under 72 Hours
 Full Road/Sidewalk Closure: More than 72 Hours
Daily Setup/ Breakdown YES NO
Using Crane in ROW* YES NO
Parking Meters Impacted* YES NO
**Crane and parking meter mitigation must be done prior to MOT approval.*

SECTION 4: TYPE OF WORK DESCRIPTION

Please make sure to include the following information in the description:

- List the names of affected streets and the nearest intersection. Use complete street names, including directionals.
- Describe the nature of the construction and any phasing plans. A separate MOT application is required for each phase.
- Describe any specific safety hazards that the work may produce during construction (i.e., large holes, etc.).

SW 4th Avenue, south of SW 2nd Street to the CuldeSac Saturday December 30th
SW 2nd Street between SW 4th Ave & SW 5th Ave Friday December 29th, SW 2nd Street between SW 7th Ave to SW 1st Ave
Sunday December 31st - Monday January 1st. SW 3rd Avenue as FLPD deems necessary for safety.
Special Event closures No hazards

SECTION 5: FDOT DESIGN STANDARD INDEX DRAWING NUMBERS/MUTCD TYPICAL APPLICATION

(State which FDOT Standard Index 600 series will be followed. The indexes must include the north arrow and the names of the main and cross streets. Also, state whether trenches will be covered or backfilled during non-working hours.)

TA-20

MAINTENANCE OF TRAFFIC (MOT) FORM

MOT APPROVAL

CITY OF FORT LAUDERDALE
TRANSPORTATION AND MOBILITY

SECTION 6: MOT DESCRIPTION

Please make sure to include the following information in the description:

- List the lanes that will be open and closed on each street and describe any necessary detours in detail. If detours are not required, please state that below.
- State if flagmen will be provided.
- State if the MOT will be continuous or intermittent. If intermittent, state the times of the day the MOT will be in effect.
- State any other special considerations related to this request.

SW 4th Avenue, South of SW 2nd Street to the CuldeSac closed
 patrons may access oneway alley to parking for their building

SW 2nd Street, SW 7th Avenue to SW 1st Avenue closed, traffic will detour to Broward Boulevard

SW 3rd Avenue south of SW 2nd Street will close when FLPD determines it is unsafe to keep open on New Year's Eve

Special Event closure

SECTION 7: MOT FORM CHECKLIST (Provide one copy of each attachment.)

- | | |
|--|--|
| <input type="checkbox"/> Completed Required Signatures Form | <input type="checkbox"/> Certification(s) for Traffic Control Technician or Traffic Control Supervisor must be embedded on MOT plans along with FDOT indexes/MUTCD documents |
| <input type="checkbox"/> Color aerial(s)/MOT Plan with index overlay | <input type="checkbox"/> Plan of work (optional, but preferred) |
| <input type="checkbox"/> County and State approvals (if required) | |
| <input type="checkbox"/> Crane and Parking Mitigation (if required) | |
| <input type="checkbox"/> FDOT Index MUTCD Reference Drawing(s) | |

SECTION 8: ADDITIONAL COMMENTS

Please Note: The approval of an MOT application may require up to two weeks from the time that all required documents in the checklist above are received by TAM staff. Any rejected MOT submittal that is corrected and sent back will be considered a new submittal, which may require up to two additional weeks to approve. Additional time may be needed for more complex plans or plans requiring additional coordination/information.

In signing this application, I understand that separate City and/or County and/or State permits may be required for this project. Furthermore, I am aware that I am responsible for ensuring that the project is completed in accordance with the plans and specifications as stipulated in the permit approval condition.

Deborah K. Bylica
 (APPLICANT SIGNATURE)
 9/14/23
 (DATE SIGNED)

Deborah K. Bylica / Recreation Program Supervisor
 (PRINT NAME/TITLE)

As a consideration for the permission granted herein, (APPLICANT) agrees to indemnify and hold harmless the City of Fort Lauderdale for any damages, claims, or injuries that may result from the MOT plan approved under the PERMIT.

 (NAME OF COMPANY)

BY: _____
 (COMPANY AUTHORIZED AGENT)

Office Use Only

MOT ID#: _____

GMOT Permit#: _____

REQUIRED SIGNATURES FORM

Applicant must collect all required signatures. To expedite processing, individual signatures may be obtained and submitted to MOT@fortlauderdale.gov separately on this page. All signatures and comments must be submitted before two-week review process begins.

NOT APPROVAL
CITY OF FORT LAUDERDALE
TRANSPORTATION AND MOBILITY

<p>_____ Print Name</p> <p>Police Department 1300 W. Broward Boulevard Tel: 954-828-5477 Call for Appointment</p> <p>*Required only if MOT includes a detour for any direction of travel.</p>	<p>_____ Signature</p> <p>_____ (Date)</p>
<p><u>Bruce Strandhagen</u> Print Name</p> <p><i>Bruce Strandhagen</i> Signature</p> <p>Fire Rescue Department 528 N.W. 2nd Street Tel: 954-828-6864 Email: CBotting@fortlauderdale.gov Call for Appointment</p> <p>*Required only if MOT includes a detour for any direction of travel.</p>	<p>12/21/23 _____ (Date)</p>
<p>_____ Print Name</p> <p>Broward County Traffic Engineering Division 2300 W. Commercial Boulevard Tel: 954-847-2653 Call for appointment. Walk-ins <u>NOT</u> accepted.</p> <p>*Required only if MOT/detour affects Broward County road or intersection.</p>	<p>_____ Signature</p> <p>_____ (Date)</p>

After all applicable signatures are collected, applicant should submit the MOT plan and this routing form to the Transportation and Mobility Department at mot@fortlauderdale.gov.

OFFICE USE ONLY

Department Director's Signature (requested by City staff if required)

<p><u>Morgan Dunn</u> Print Name</p> <p><i>Morgan Dunn</i> Signature</p> <p>Transportation and Mobility Department 290 N.E. 3rd Avenue Tel: 954- 828-4997 Email: MOT@fortlauderdale.gov Call for Appointment. Walk-ins <u>NOT</u> accepted.</p>	<p>12/21/23 _____ (Date)</p>
<p><i>Milos Majstorovic</i> _____ Signature</p> <p>Transportation and Mobility Department Ben Rogers, Director</p>	<p>_____ (Date)</p>

A copy of the final permit and this MOT form shall be kept on site and be made available to the City inspector at all times.

Traffic modifications required for special events shall be coordinated through the Parks and Recreation's Special Events Department. Please call 954-828-6075 or email basmith@fortlauderdale.gov.

MOT plans for City Capital Improvement Projects shall be coordinated through the City of Fort Lauderdale Public Works Department. Please call 954-828 -5772 or email ralvarez@fortlauderdale.gov.

REQUIRED SIGNATURES FORM

Applicant must collect all required signatures. To expedite processing, individual signatures may be obtained and submitted to MOT@fortlauderdale.gov separately on this page. All signatures and comments must be submitted before two-week review process begins.

<p><u>Brian Blount 1711</u> Print Name</p> <p style="text-align: center;">Police Department 1300 W. Broward Boulevard Tel: 954-828-5477 <i>Call for Appointment</i></p> <p><i>*Required only if MOT includes a detour for any direction of travel.</i></p>	<p style="text-align: center;">_____ Signature</p> <p style="text-align: center;">Police Department 1300 W. Broward Boulevard Tel: 954-828-5477 <i>Call for Appointment</i></p> <p><i>*Required only if MOT includes a detour for any direction of travel.</i></p>	<p style="text-align: center;">_____ (Date)</p> <p style="text-align: center;">12/21/23</p>
<p style="text-align: center;">_____ Print Name</p> <p style="text-align: center;">Fire Rescue Department 528 N.W. 2nd Street Tel: 954-828-6864 Email: CBotting@fortlauderdale.gov <i>Call for Appointment</i></p> <p><i>*Required only if MOT includes a detour for any direction of travel.</i></p>	<p style="text-align: center;">_____ Signature</p> <p style="text-align: center;">Fire Rescue Department 528 N.W. 2nd Street Tel: 954-828-6864 Email: CBotting@fortlauderdale.gov <i>Call for Appointment</i></p> <p><i>*Required only if MOT includes a detour for any direction of travel.</i></p>	<p style="text-align: center;">_____ (Date)</p>
<p style="text-align: center;">_____ Print Name</p> <p style="text-align: center;">Broward County Traffic Engineering Division 2300 W. Commercial Boulevard Tel: 954-847-2653 <i>Call for appointment. Walk-ins NOT accepted.</i></p> <p><i>*Required only if MOT/detour affects Broward County road or intersection.</i></p>	<p style="text-align: center;">_____ Signature</p> <p style="text-align: center;">Broward County Traffic Engineering Division 2300 W. Commercial Boulevard Tel: 954-847-2653 <i>Call for appointment. Walk-ins NOT accepted.</i></p> <p><i>*Required only if MOT/detour affects Broward County road or intersection.</i></p>	<p style="text-align: center;">_____ (Date)</p>
<p>After all applicable signatures are collected, applicant should submit the MOT plan and this routing form to the Transportation and Mobility Department at mot@fortlauderdale.gov.</p>		
<p>OFFICE USE ONLY</p>		
<p>Department Director's Signature (requested by City staff if required)</p>		
<p style="text-align: center;">_____ Print Name</p> <p style="text-align: center;">Transportation and Mobility Department 290 N.E. 3rd Avenue Tel: 954- 828-4997 Email: MOT@fortlauderdale.gov <i>Call for Appointment. Walk-ins NOT accepted.</i></p>	<p style="text-align: center;">_____ Signature</p> <p style="text-align: center;">Transportation and Mobility Department 290 N.E. 3rd Avenue Tel: 954- 828-4997 Email: MOT@fortlauderdale.gov <i>Call for Appointment. Walk-ins NOT accepted.</i></p>	<p style="text-align: center;">_____ (Date)</p>
<p style="text-align: center;">_____ Signature</p> <p style="text-align: center;">Transportation and Mobility Department Ben Rogers, Director</p>	<p style="text-align: center;">_____ Signature</p> <p style="text-align: center;">Transportation and Mobility Department Ben Rogers, Director</p>	<p style="text-align: center;">_____ (Date)</p>

A copy of the final permit and this MOT form shall be kept on site and be made available to the City inspector at all times.

Traffic modifications required for special events shall be coordinated through the Parks and Recreation's Special Events Department. Please call 954-828-6075 or email basmith@fortlauderdale.gov.

MOT plans for City Capital Improvement Projects shall be coordinated through the City of Fort Lauderdale Public Works Department. Please call 954-828 -5772 or email ralvarez@fortlauderdale.gov.

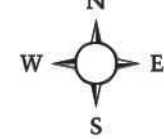

MOT APPROVAL CITY OF FORT LAUDERDALE TRANSPORTATION AND MOBILITY

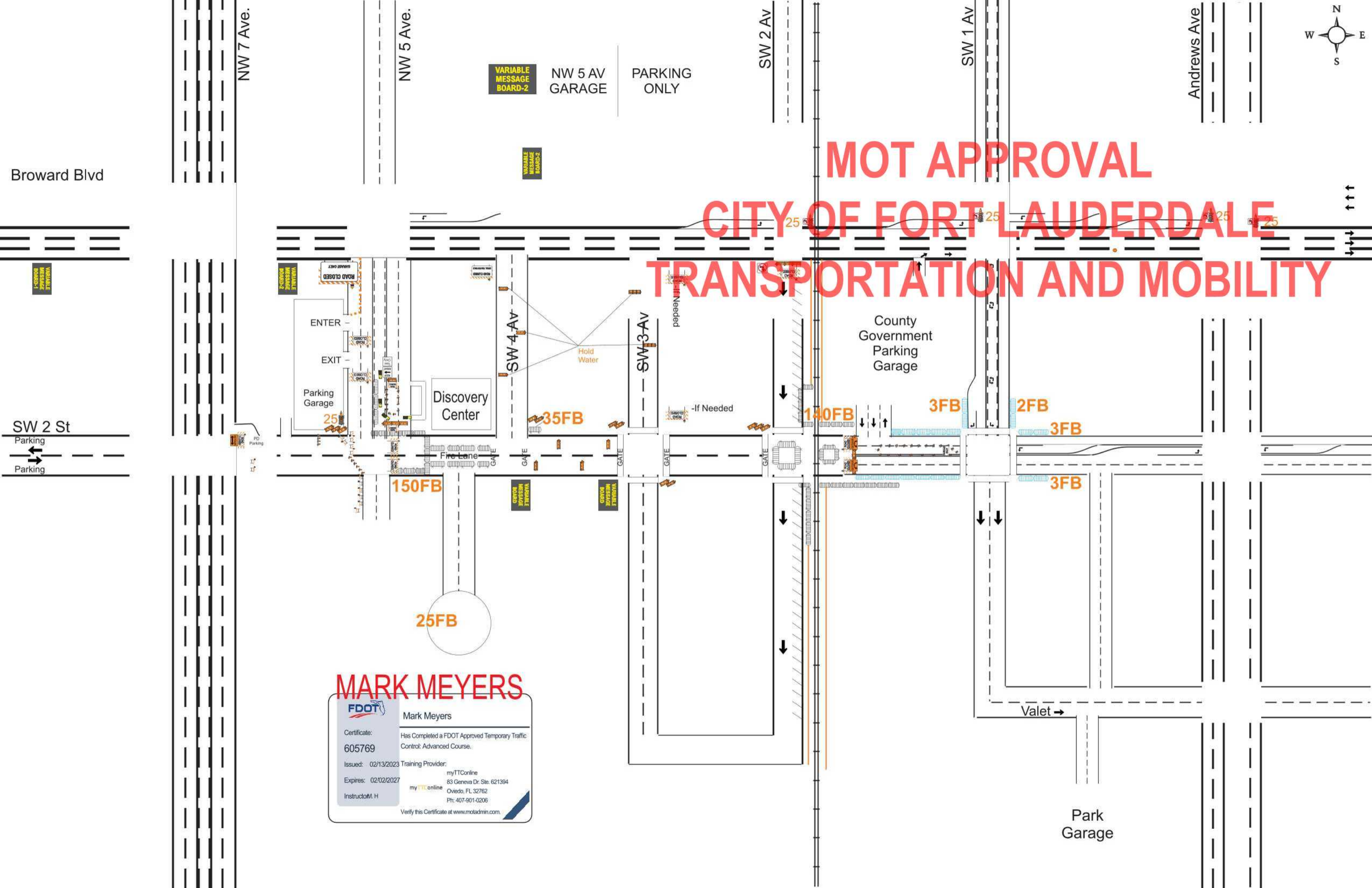

MARK MEYERS

FDOT Mark Meyers

Certificate: 605769
Has Completed a FDOT Approved Temporary Traffic Control: Advanced Course.

Issued: 02/13/2023 Training Provider: myTTOnline
Expires: 02/02/2027 83 Geneva Dr. Ste. 621394
Oviedo, FL 32762
Instructor: M. H. myTTOnline Ph: 407-901-0206

Verify this Certificate at www.motadmin.com

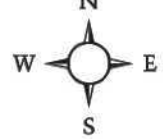

Broward Blvd

NW 7 Ave.

NW 5 Ave.

SW 2 Av

SW 1 Av

Andrews Ave

MOT APPROVAL CITY OF FORT LAUDERDALE TRANSPORTATION AND MOBILITY

SW 2 St

Parking

Parking

Parking Garage

Discovery Center

SW 4 Av

SW 3 Av

County Government Parking Garage

DETOUR

DETOUR

ROAD CLOSED

ROAD CLOSED

ROAD CLOSED

DETOUR

ROAD CLOSED
LOCAL TRAFFIC ONLY

DETOUR



MARK MEYERS

	Mark Meyers
Certificate: 605769	Has Completed a FDOT Approved Temporary Traffic Control: Advanced Course.
Issued: 02/13/2023	Training Provider: myTTOnline
Expires: 02/02/2027	83 Geneva Dr. Ste. 621394 Oviedo, FL 32762 Ph: 407-901-0206
Instructor: M.H.	myTTOnline
Verify this Certificate at www.motadmin.com	

Valet →

Park Garage

Notes for Figure 6H-20—Typical Application 20 Detour for a Closed Street

Guidance:

1. *This plan should be used for streets without posted route numbers.*
2. *On multi-lane streets, Detour signs with an Advance Turn Arrow should be used in advance of a turn.*

Option:

3. Flashing warning lights and/or flags may be used to call attention to the advance warning signs.
4. Flashing warning lights may be used on Type 3 Barricades.
5. Detour signs may be located on the far side of intersections. A Detour sign with an advance arrow may be used in advance of a turn.
6. A Street Name sign may be mounted with the Detour sign. The Street Name sign may be either white on green or black on orange.

Standard:

7. **When used, the Street Name sign shall be placed above the Detour sign.**

Support:

8. See Figure 6H-9 for the information for detouring a numbered highway.

Figure 6H-20. Detour for a Closed Street (TA-20)

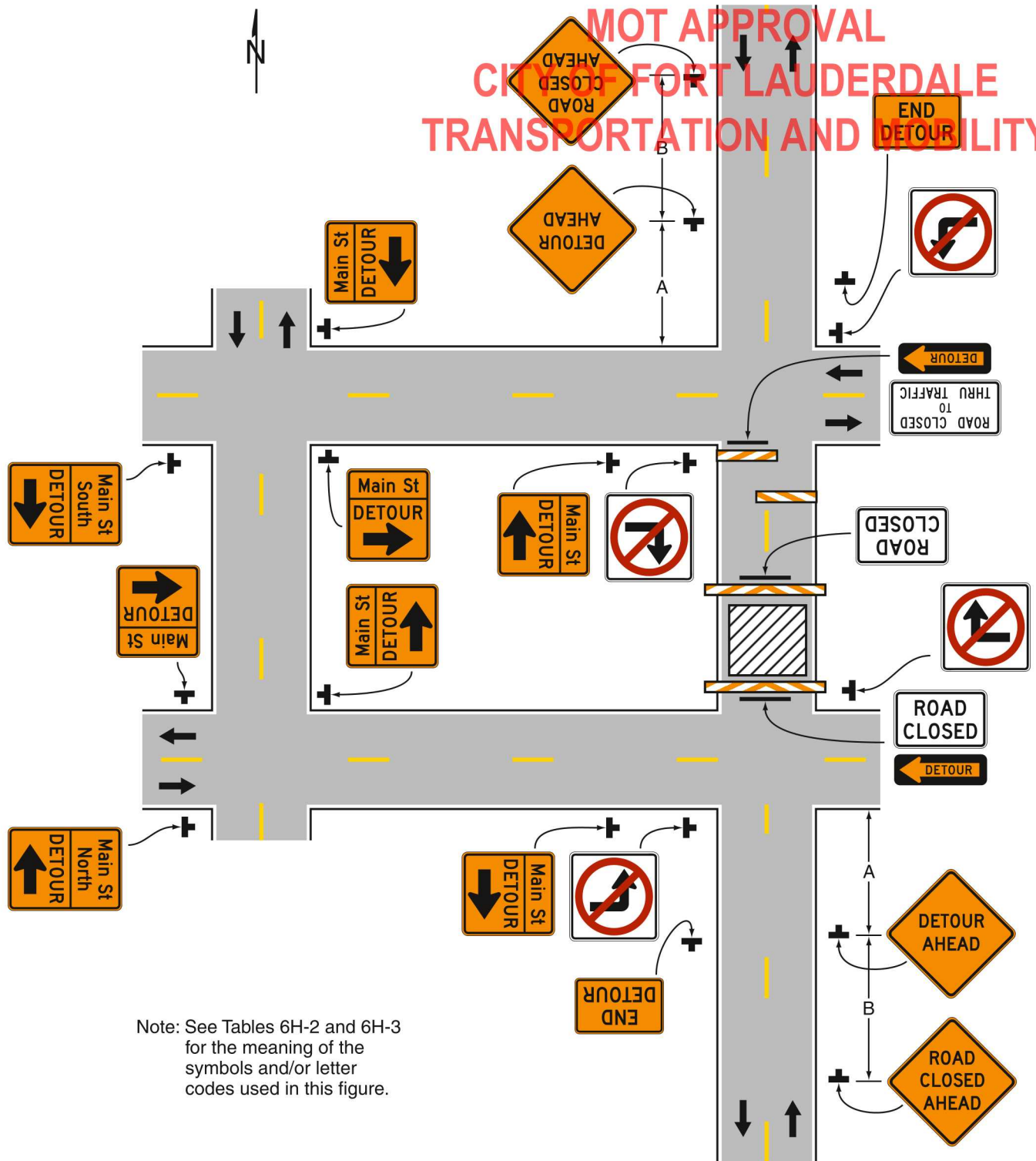

Note: See Tables 6H-2 and 6H-3 for the meaning of the symbols and/or letter codes used in this figure.

Typical Application 20





TAM-MOT-23120047 - NYE Downtown Countdown

Final Audit Report

2023-12-21

Created:	2023-12-21
By:	Morgan Dunn (MDunn@fortlauderdale.gov)
Status:	Signed
Transaction ID:	CBJCHBCAABAAalSwg9tzJ727znaKFkEKRvchBfhED4EI

"TAM-MOT-23120047 - NYE Downtown Countdown" History

-  Document created by Morgan Dunn (MDunn@fortlauderdale.gov)
2023-12-21 - 7:35:59 PM GMT- IP address: 73.56.69.246
-  Document emailed to Milos Majstorovic (MMajstorovic@fortlauderdale.gov) for signature
2023-12-21 - 7:36:12 PM GMT
-  Email viewed by Milos Majstorovic (MMajstorovic@fortlauderdale.gov)
2023-12-21 - 7:48:22 PM GMT- IP address: 50.232.252.93
-  Document e-signed by Milos Majstorovic (MMajstorovic@fortlauderdale.gov)
Signature Date: 2023-12-21 - 7:49:57 PM GMT - Time Source: server- IP address: 50.232.252.93
-  Agreement completed.
2023-12-21 - 7:49:57 PM GMT

