

MAINTENANCE OF TRAFFIC (MOT) FORM

MOT APPROVAL

CITY OF FORT LAUDERDALE TRANSPORTATION AND MOBILITY

SECTION 1: APPLICANT INFORMATION

Applicant Name: Jarred John Applicant Phone: 921-283-9100

Applicant Email: Jarred@Damngoodherpally.com

Applicant Address: 100 SW 3rd Ave Fort Lauderdale, FL 33312
(Address, City, State, Zip Code)

City Project Manager (if applicable): _____ Phone: _____

Agency responsible for this project: City County FDOT Other: _____

On-site/Emergency Contact Phone: Bill Sisca 286-525-4850

SECTION 2: PROJECT INFORMATION

ENG Permit # (obtain from Department of Sustainable Development (DSD)): Special Event

Project Name: Social Distortion & Bad Religion

Project Address: 37 SW 3rd Ave, Fort Lauderdale, FL 33312
(Address, City, State, Zip Code)

Specific Dates and Times Requested for MOT Implementation:

Please identify a start date that is at least two weeks from the submittal date. The approval of an MOT application may require up to two weeks from the time that all required documents are received by TAM staff.

Begin Date: 4/27/24

Begin Time: 6:00 AM

End Date: 4/28/24

End Time: 2:00 AM

SECTION 3: PROJECT DETAILS

- Partial or Shoulder Closure
- Full Road Closure (detour): Under 72 Hours
- Sidewalk Closure: Under 72 Hours
- Full Road/Sidewalk Closure: More than 72 Hours

- Daily Setup/ Breakdown YES NO
- Using Crane in ROW* YES NO
- Parking Meters Impacted* YES NO

*Crane and parking meter mitigation must be done prior to MOT approval. Please refer to the MOT Guidelines for crane definitions.

SECTION 4: TYPE OF WORK DESCRIPTION

Please make sure to include the following information in the description:

- List the names of affected streets and the nearest intersection. Use complete street names, including directionals.
- Describe the nature of the construction and any phasing plans. A separate MOT application is required for each phase.
- Describe any specific safety hazards that the work may produce during construction (i.e., large holes, etc.).

SW 3rd Ave between Broward Blvd and SW 2nd Street
SW 2nd Ave between Broward Blvd and SW 2nd Street

SECTION 5: FDOT DESIGN STANDARD INDEX DRAWING NUMBERS/MUTCD TYPICAL APPLICATION

(State which FDOT Standard Index 600 series will be followed. The indexes must include the north arrow and the names of the main and cross streets. Also, state whether trenches will be covered or backfilled during non-working hours.)

TA-20

MAINTENANCE OF TRAFFIC (MOT) FORM

MOT APPROVAL
CITY OF FORT LAUDERDALE
TRANSPORTATION AND MOBILITY

SECTION 6: MOT DESCRIPTION

Please make sure to include the following information in the description:

- List the lanes that will be open and closed on each street and describe any necessary detours in detail. If detours are not required, please state that below.
- State if flagmen will be provided.
- State if the MOT will be continuous or intermittent. If intermittent, state the times of the day the MOT will be in effect.
- State any other special considerations related to this request.

No detours. No flagmen
MOT will be continuous

Detours using Broward Blvd, SW 2 St, SW5 Ave, and SW 1 Ave

SECTION 7: MOT FORM CHECKLIST (Provide one copy of each attachment.)

- | | |
|--|--|
| <input type="checkbox"/> Completed Required Signatures Form | <input type="checkbox"/> Certification(s) for Traffic Control Technician or Traffic Control Supervisor must be embedded on MOT plans along with FDOT indexes/MUTCD documents |
| <input type="checkbox"/> Color aerial(s)/MOT Plan with index overlay | <input type="checkbox"/> Plan of work (optional, but preferred) |
| <input type="checkbox"/> County and State approvals (if required) | |
| <input type="checkbox"/> Crane and Parking Mitigation (if required) | |
| <input type="checkbox"/> FDOT Index MUTCD Reference Drawing(s) | |

SECTION 8: ADDITIONAL COMMENTS

Please Note: The approval of an MOT application may require up to two weeks from the time that all required documents in the checklist above are received by TAM staff. Any rejected MOT submittal that is corrected and sent back will be considered a new submittal, which may require up to two additional weeks to approve. Additional time may be needed for more complex plans or plans requiring additional coordination/information.

In signing this application, I understand that separate City and/or County and/or State permits may be required for this project. Furthermore, I am aware that I am responsible for ensuring that the project is completed in accordance with the plans and specifications as stipulated in the permit approval condition.

[Signature]
(APPLICANT SIGNATURE)
4/1/24
(DATE SIGNED)

Jarred John
(PRINT NAME/TITLE)

As a consideration for the permission granted herein, Jarred John (APPLICANT) agrees to indemnify and hold harmless the City of Fort Lauderdale for any damages, claims, or injuries that may result from the MOT plan approved under the PERMIT.

Damn Good Hospitality
(NAME OF COMPANY)

BY: Bill Sisca
(COMPANY AUTHORIZED AGENT)

Office Use Only

MOT ID#: _____

ENG Permit#: _____

REQUIRED SIGNATURES FORM

Applicant must collect all required signatures. All signatures and comments must be submitted before two-week review process begins.

MOT APPROVAL
CITY OF FORT LAUDERDALE
TRANSPORTATION AND MOBILITY

M. Ferrer

Print Name

monica ferrer
Signature

4/24/24

Police Department

1300 W. Broward Boulevard | Tel: 954-828-5477

Call for Appointment

*Required only if MOT includes a detour for any direction of travel.

(Date)

Print Name

Signature

Fire Rescue Department

528 N.W. 2nd Street | Tel: 954-828-6800

Call for Appointment

*Required only if MOT includes a detour for any direction of travel.

(Date)

Print Name

Signature

Broward County Traffic Engineering Division

2300 W. Commercial Boulevard | Tel: 954-847-2653

Call for Appointment. Walk-ins NOT accepted.

*Required only if MOT/detour affects Broward County road or intersection.

(Date)

After all applicable signatures are collected, applicant should submit the MOT plan and this routing form to the Transportation and Mobility Department at mot@fortlauderdale.gov.

OFFICE USE ONLY

Department Director's Signature (requested by City staff if required)

Morgan Dunn

Print Name

Morgan Dunn
Signature

4/24/24

Transportation and Mobility Department

290 N.E. 3rd Avenue | Tel: 954- 828-4997 | Email: MOT@fortlauderdale.gov

Call for Appointment. Walk-ins and hard copies NOT accepted.

(Date)

Ekaete Ekwere

Ekaete Ekwere (Apr 26, 2024 09:10 EDT)

Signature

Transportation and Mobility Department

Ben Rogers, Director

(Date)

A copy of the final permit and this MOT form shall be kept on site and be made available to the City inspector at all times.

Traffic modifications required for special events shall be coordinated through the Parks and Recreation's Special Events Department. Please call 954-828-4349 or email BHenry@fortlauderdale.gov.

MOT plans for City Capital Improvement Projects shall be coordinated through the City of Fort Lauderdale Public Works Department. Please call 954-828-5772 or email ralvarez@fortlauderdale.gov.

Office Use Only

MOT ID#: _____

ENG Permit#: _____

REQUIRED SIGNATURES FORM

Applicant must collect all required signatures. All signatures and comments must be submitted before two-week review process begins.

**MOT APPROVAL
CITY OF FORT LAUDERDALE
TRANSPORTATION AND MOBILITY**

_____ Print Name	_____ Signature	_____ (Date)
Police Department 1300 W. Broward Boulevard Tel: 954-828-5477 <i>Call for Appointment</i> *Required only if MOT includes a detour for any direction of travel.		

Jason W Miller _____ Print Name	 _____ Signature	4/24/24 _____ (Date)
Fire Rescue Department 528 N.W. 2 nd Street Tel: 954-828-6800 <i>Call for Appointment</i> *Required only if MOT includes a detour for any direction of travel.		

_____ Print Name	_____ Signature	_____ (Date)
Broward County Traffic Engineering Division 2300 W. Commercial Boulevard Tel: 954-847-2653 <i>Call for Appointment. Walk-ins NOT accepted.</i> *Required only if MOT/detour affects Broward County road or intersection.		

After all applicable signatures are collected, applicant should submit the MOT plan and this routing form to the Transportation and Mobility Department at mot@fortlauderdale.gov.

OFFICE USE ONLY
Department Director's Signature (requested by City staff if required)

_____ Print Name	_____ Signature	_____ (Date)
Transportation and Mobility Department 290 N.E. 3 rd Avenue Tel: 954- 828-4997 Email: MOT@fortlauderdale.gov <i>Call for Appointment. Walk-ins and hard copies NOT accepted.</i>		

_____ Signature	Transportation and Mobility Department Ben Rogers, Director	_____ (Date)
--------------------	---	-----------------

A copy of the final permit and this MOT form shall be kept on site and be made available to the City inspector at all times.

Traffic modifications required for special events shall be coordinated through the Parks and Recreation's Special Events Department. Please call 954-828-4349 or email BHenry@fortlauderdale.gov.

MOT plans for City Capital Improvement Projects shall be coordinated through the City of Fort Lauderdale Public Works Department. Please call 954-828-5772 or email ralvarez@fortlauderdale.gov.

To be setup in accordance with TA 20 of the MUTCD

TABLE 3 WORK ZONE SIGN SPACING "X"	
Road Type	Min. Spacing (feet)
Arterials and Collectors with Work Zone Speed ≤ 40 mph	200
Arterials and Collectors with Work Zone Speed ≤ 45 mph	500
Limited Access Roadways	1,500

* For limited access roadways with work zone speed ≤ 55 mph, the minimum spacing may be reduced in accordance with the MUTCD and as approved by the Engineer.

SPEED LIMIT
25

MOT APPROVAL CITY OF FORT LAUDERDALE TRANSPORTATION AND MOBILITY

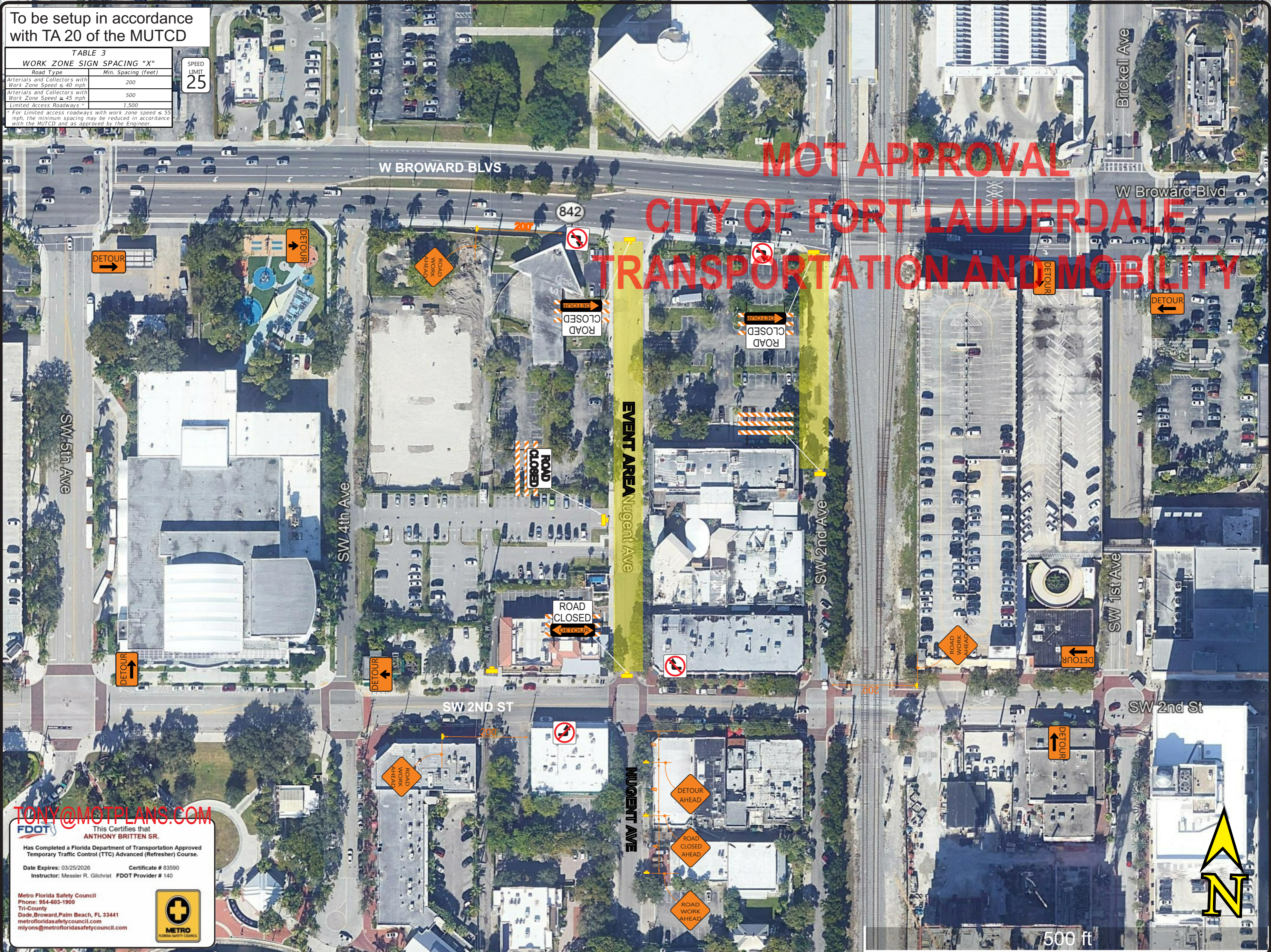

TONY@MOTPLANS.COM

FDOT This Certifies that
ANTHONY BRITTEN SR.
Has Completed a Florida Department of Transportation Approved
Temporary Traffic Control (TTC) Advanced (Refresher) Course.

Date Expires: 03/25/2026 Certificate # 83590
Instructor: Messier R. Gilchrist FDOT Provider # 140

Metro Florida Safety Council
Phone: 954-603-1900
Tri-County
Dade, Broward, Palm Beach, FL 33441
metrofloridasafetycouncil.com
myons@metrofloridasafetycouncil.com

Guidance:

15 *The width of a lateral buffer space should be determined by engineering judgment.*

Option:

16 When work occurs on a high-volume, highly-congested facility, a vehicle storage or staging space may be provided for incident response and emergency vehicles (for example, tow trucks and fire apparatus) so that these vehicles can respond quickly to road user incidents.

Section 6B.07 Termination Area

Support:

01 The termination area is the section of the highway where road users are returned to their normal driving path. The termination area extends from the downstream end of the work area to the last TTC device such as END ROAD WORK signs, if posted.

Option:

02 An END ROAD WORK sign, a Speed Limit sign, or other signs may be used to inform road users that they can resume normal operations.

03 A longitudinal buffer space may be used between the work space and the beginning of the downstream taper.

Section 6B.08 Tapers

Option:

01 Tapers may be used in both the transition and termination areas. Whenever tapers are to be used in close proximity to an interchange ramp, crossroads, curves, or other influencing factors, the length of the tapers may be adjusted.

Support:

02 Tapers are created by using a series of channelizing devices and/or pavement markings to move traffic out of or into the normal path. Types of tapers are shown in Figure 6B-2.

03 Longer tapers are not necessarily better than shorter tapers (particularly in urban areas with characteristics such as short block lengths or driveways) because extended tapers tend to encourage sluggish operation and to encourage drivers to delay lane changes unnecessarily. The test concerning adequate lengths of tapers involves observation of driver performance after TTC plans are put into effect.

Guidance:

04 *The appropriate taper length (L) should be determined using the criteria shown in Tables 6B-3 and 6B-4.*

Support:

05 A merging taper requires the longest distance because drivers are required to merge into common road space.

Table 6B-2. Stopping Sight Distance as a Function of Speed

Speed*	Distance
20 mph	115 feet
25 mph	155 feet
30 mph	200 feet
35 mph	250 feet
40 mph	305 feet
45 mph	360 feet
50 mph	425 feet
55 mph	495 feet
60 mph	570 feet
65 mph	645 feet
70 mph	730 feet
75 mph	820 feet

* Posted speed, off-peak 85th-percentile speed prior to work starting, or the anticipated operating speed

Table 6B-3. Taper Length Criteria for Temporary Traffic Control Zones

Type of Taper	Taper Length
Merging Taper	at least L
Shifting Taper	at least 0.5 L
Shoulder Taper	at least 0.33 L
One-Lane, Two-Way Traffic Taper	50 feet minimum, 100 feet maximum
Downstream Taper	50 feet minimum, 100 feet maximum

Note: Use Table 6B-4 to calculate L

Table 6B-4. Formulas for Determining Taper Length

Speed (S)	Taper Length (L) in feet
40 mph or less	$L = \frac{WS^2}{60}$
45 mph or more	$L = WS$

Where: L = taper length in feet
 W = width of offset in feet
 S = posted speed limit, or off-peak 85th-percentile speed prior to work starting, or the anticipated operating speed in mph



**Notes for Figure 6P-20—Typical Application 20
Detour for a Closed Street**

Guidance:

1. *This plan should be used for streets without posted route numbers.*
2. *On multi-lane streets, Detour signs with an Advance Turn Arrow should be used in advance of a turn.*

Option:

3. Flashing warning lights and/or flags may be used to call attention to the advance warning signs.
4. Flashing warning lights may be used on Type 3 Barricades.
5. Detour signs may be located on the far side of intersections. A Detour sign with an advance arrow may be used in advance of a turn.
6. A Street Name sign may be mounted with the Detour sign. The Street Name sign may be either white on green or black on orange.

Standard:

7. **When used, the Street Name sign shall be placed above the Detour sign.**

Support:

8. Figure 6P-9 contains the information for detouring a numbered highway.

MOT APPROVAL
CITY OF FORT LAUDERDALE
TRANSPORTATION AND MOBILITY

Dec 2024

TONY@MOTPLANS.COM



This Certifies that
ANTHONY BRITTEN SR.
Has Completed a Florida Department of Transportation Approved
Temporary Traffic Control (TTC) Advanced (Refresher) Course.

Date Expires: 03/25/2026 Certificate # 83590
Instructor: Messier R. Gilchrist FDOT Provider # 140

Metro Florida Safety Council
Phone: 954-603-1900
Tri-County
Dade, Broward, Palm Beach, FL 33441
metrofloridasafetycouncil.com
myons@metrofloridasafetycouncil.com



NOT APPROVAL
CITY OF FORT LAUDERDALE
TRANSPORTATION AND MOBILITY

Figure 6P-20. Detour for a Closed Street (TA-20)

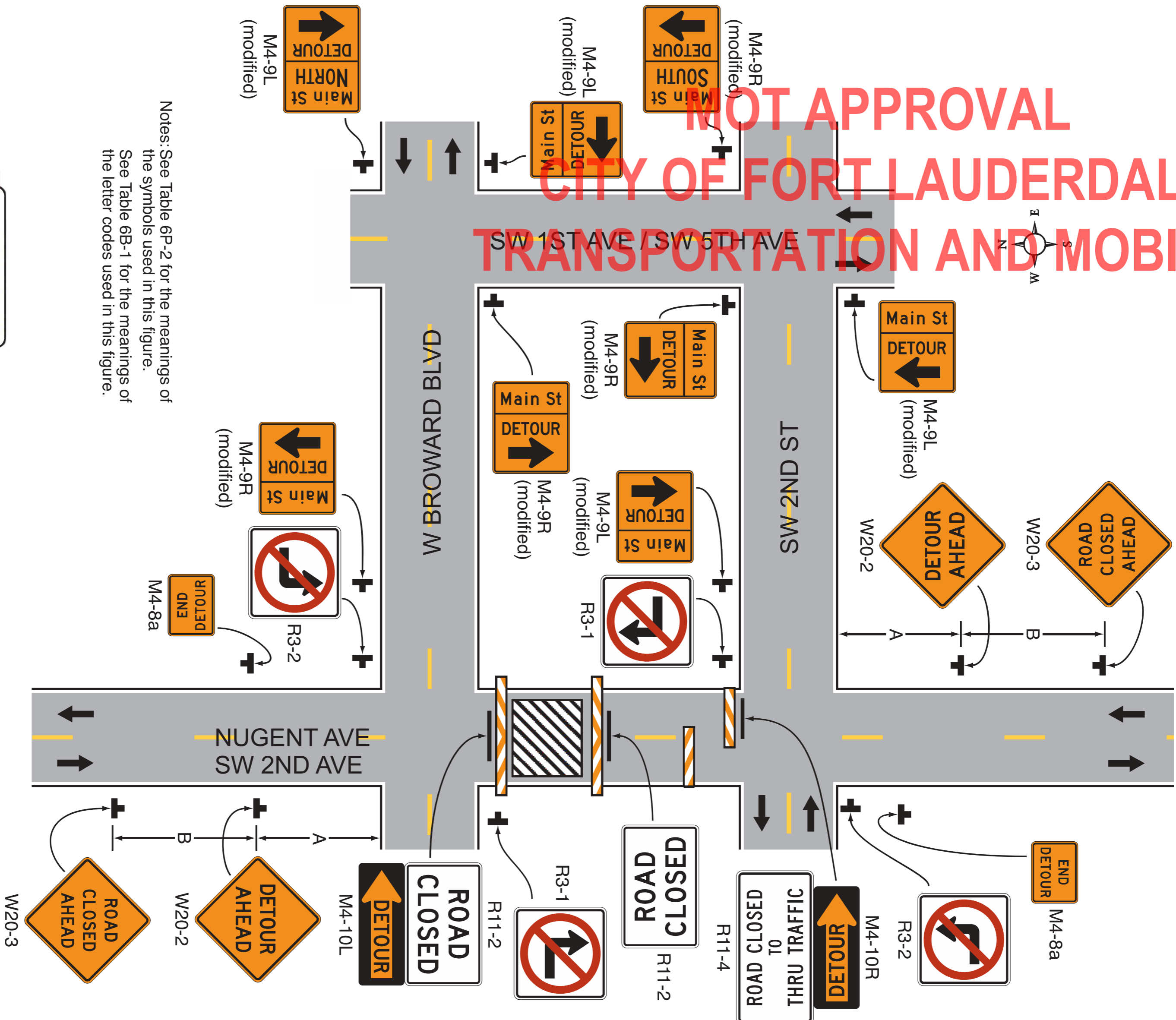

Notes: See Table 6P-2 for the meanings of the symbols used in this figure. See Table 6B-1 for the meanings of the letter codes used in this figure.

Typical Application 20

TONY@MOTPLANS.COM

This Certifies that
ANTHONY BRITTEN SR.
Has Completed a Florida Department of Transportation Approved Temporary Traffic Control (TTC) Advanced (Refresher) Course.

Date Expires: 03/25/2026 Certificate # 83590
Instructor: Messier R. Gilchrist FDOT Provider # 140

Metro Florida Safety Council
Phone: 954-603-1900
Tri-County
Dade, Broward, Palm Beach, FL 33441
metrofloridasafetycouncil.com
mlyons@metrofloridasafetycouncil.com





TAM-MOT-24040084 - Social Distortion Bad Religion

Final Audit Report

2024-04-26

Created:	2024-04-24
By:	Morgan Dunn (MDunn@fortlauderdale.gov)
Status:	Signed
Transaction ID:	CBJCHBCAABAATbBcTslrm4RzXPxSvCxPuJw1vu_7p8-f

"TAM-MOT-24040084 - Social Distortion Bad Religion" History

-  Document created by Morgan Dunn (MDunn@fortlauderdale.gov)
2024-04-24 - 3:36:57 PM GMT- IP address: 50.232.252.93
-  Document emailed to Ekaete Ekwere (eekwere@fortlauderdale.gov) for signature
2024-04-24 - 3:37:10 PM GMT
-  Document e-signed by Ekaete Ekwere (eekwere@fortlauderdale.gov)
E-signature obtained using URL retrieved through the Adobe Acrobat Sign API
Signature Date: 2024-04-26 - 1:10:44 PM GMT - Time Source: server
-  Agreement completed.
2024-04-26 - 1:10:44 PM GMT



Powered by
Adobe
Acrobat Sign